

# CERTIFICATE OF LOCATION OF GOVERNMENT CORNER

County of Anoka

State of Minnesota

## South 1/4 Corner of Sec. 19 Township 33 Range 24

On the 15th day of November, 1961, the described corner was evidenced by a concrete monument witness to actual corner

and to perpetuate the location of said corner, at the exact location thereof, a permanent marker was placed consisting of a cast iron monument

AND on the 24th day of January, 2012, said permanent marker was found and the ties were updated

Updated reference ties are as shown below.

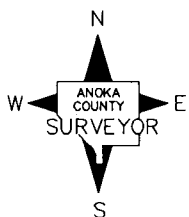
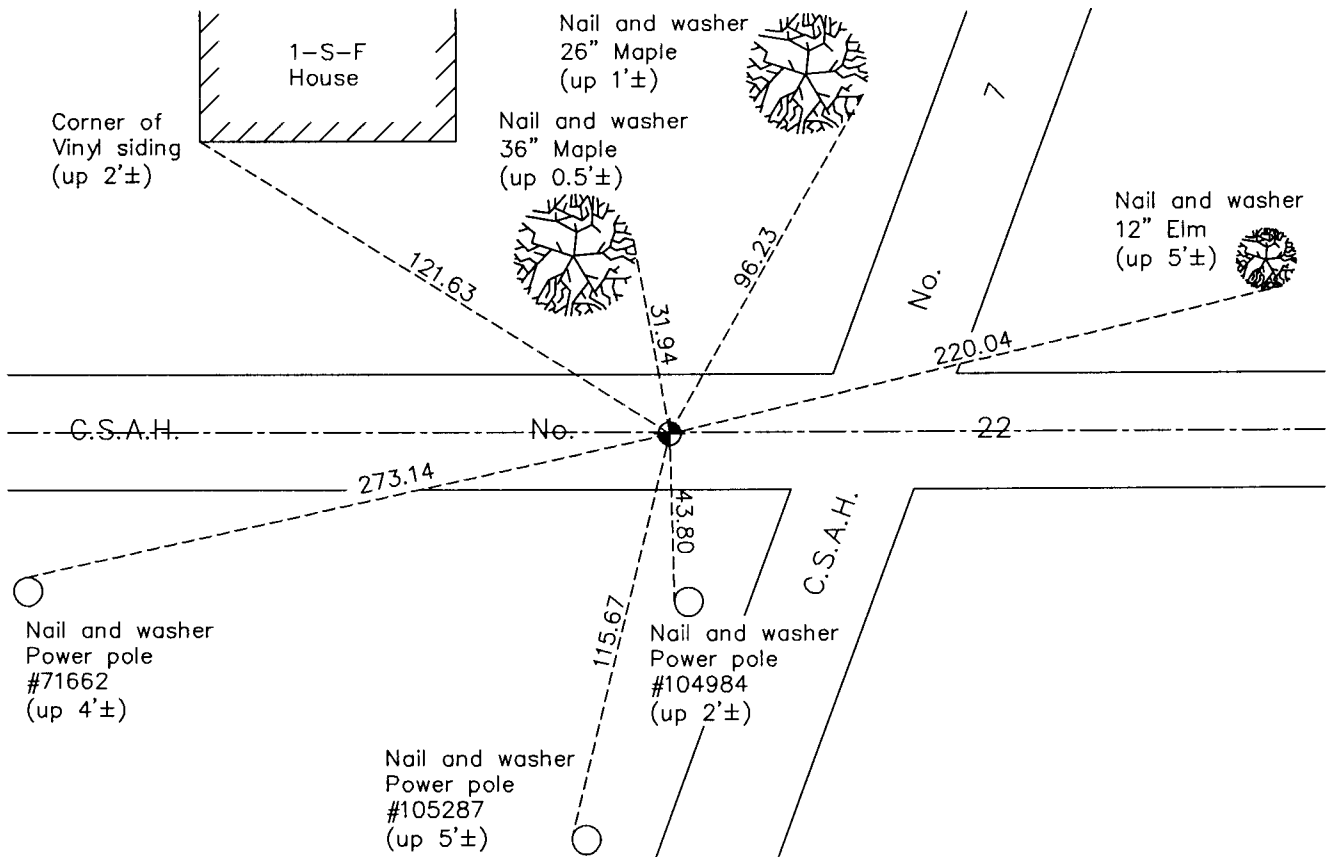

Revision Date

9/20/12

N.A.D. 1983 Coordinates  
(1996 Adjustment)

County Project Coordinates	
Northing	206598.5376
Easting	471344.6564
Date	2/15/01

I hereby certify that this United States public land survey monument record is correct and complete to the best of my knowledge and belief.

*Larry D. Hoium* Date 9/20/12

Larry D. Hoium, Anoka County Surveyor

Minnesota License Number 18165