

CERTIFICATE OF LOCATION OF GOVERNMENT CORNER

County of Anoka

State of Minnesota

Northwest Corner of Sec. 34 Township 33 Range 24

On the 7th day of March, 1977, the described corner was evidenced by area resurvey

and to perpetuate the location of said corner, at the exact location thereof, a permanent marker was placed consisting of a red and white iron pipe with a sign attached. Red & white paint is gone.

AND on the 28th day of February, 2012, said permanent marker was found and the ties
were updated

Updated reference ties are as shown below.

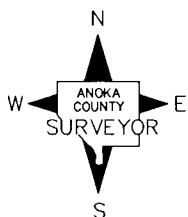
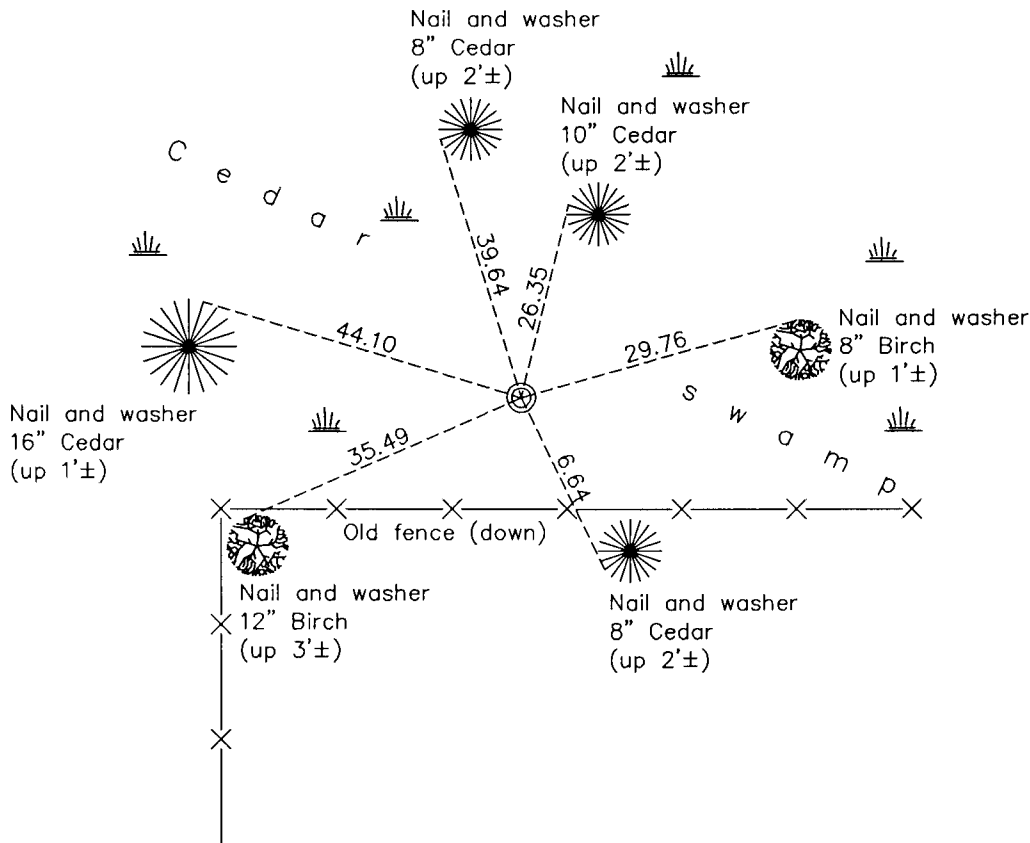

Revision Date
12/03/12

N.A.D. 1983 Coordinates
(1996 Adjustment)

County Project Coordinates	
Northing	<u>201070.8170</u>
Easting	<u>484513.0953</u>
Date	<u>5/28/02</u>

I hereby certify that this United States public land survey monument record is correct and complete to the best of my knowledge and belief.

Larry D. Hoium Date 12/03/12

Larry D. Hoium, Anoka County Surveyor

Minnesota License Number 18165