

# CERTIFICATE OF LOCATION OF GOVERNMENT CORNER

County of Anoka

State of Minnesota

Witness Corner of Sec. 33 Township 33 Range 24  
(on east line of SE1/4)

On the 7th day of March, 1975, the described corner was evidenced by \_\_\_\_\_

and to perpetuate the location of said corner, at the exact location thereof, a permanent marker was placed consisting of a cast iron monument with a sign and post on the north side

AND on the 28th day of February, 2012, said permanent marker was found down 0.5'± and the ties were updated. On April 4, 2012 replaced sign and post.

Updated reference ties are as shown below.

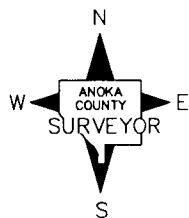
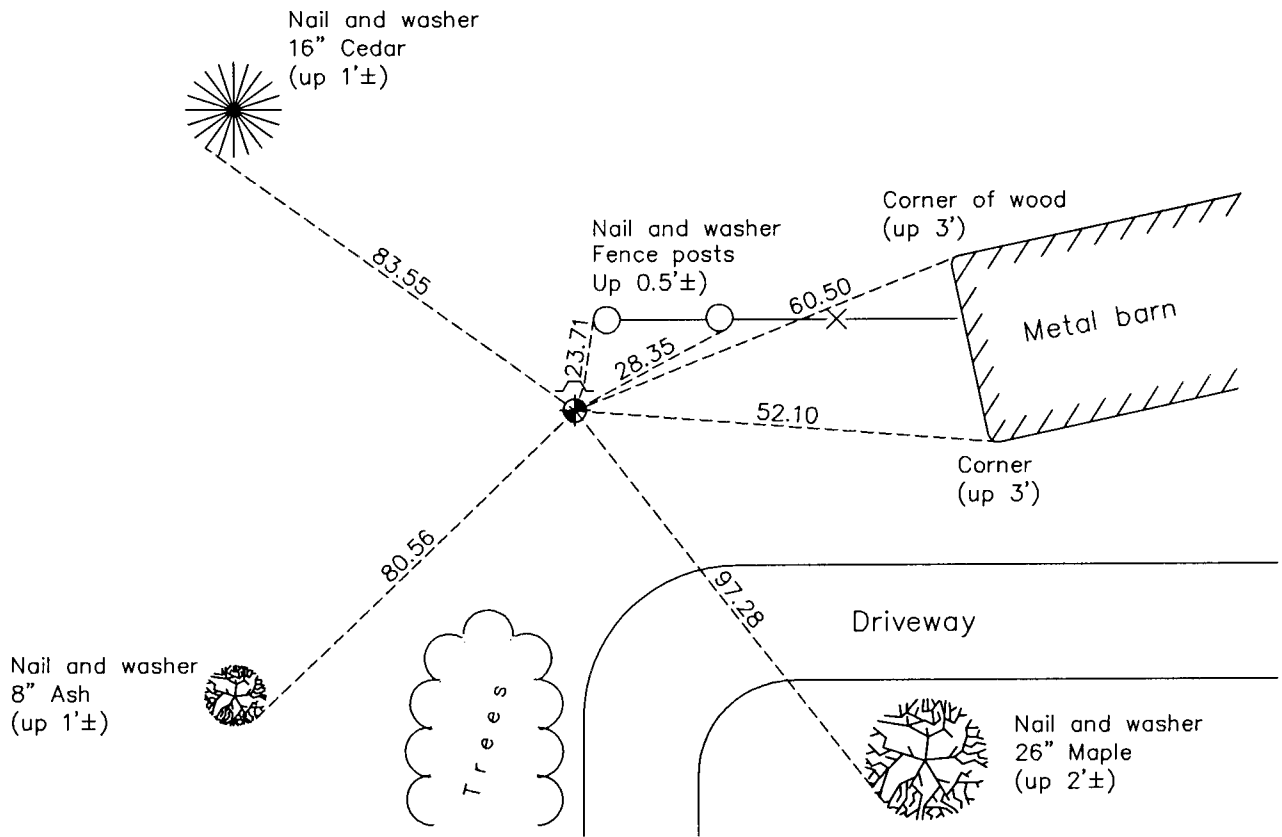

N.A.D. 1983 Coordinates  
(1996 Adjustment)

County Project Coordinates	
Northing	<u>197378.1080</u>
Easting	<u>484533.7311</u>
Date	<u>11/16/01</u>

Revision Date  
12/13/12

I hereby certify that this United States public land survey monument record is correct and complete to the best of my knowledge and belief.

*Larry D. Hoium* Date 12/13/12

\_\_\_\_\_  
Larry D. Hoium, Anoka County Surveyor

Minnesota License Number 18165