

# CERTIFICATE OF LOCATION OF GOVERNMENT CORNER

County of Anoka

State of Minnesota

## West 1/4 Corner of Sec. 20 Township 32 Range 22

On the 6th day of February, 2013, the described corner was evidenced by area resurvey provided by MN Department of Natural Resources

and to perpetuate the location of said corner, at the exact location thereof, a permanent marker was placed consisting of a 2" square steel Telspar monument with a 'County Surveyor' cap.

Set sign and post on the east side.

AND on the \_\_\_\_ day of \_\_\_\_\_, \_\_\_\_\_, said permanent marker was \_\_\_\_\_

Updated reference ties are as shown below.

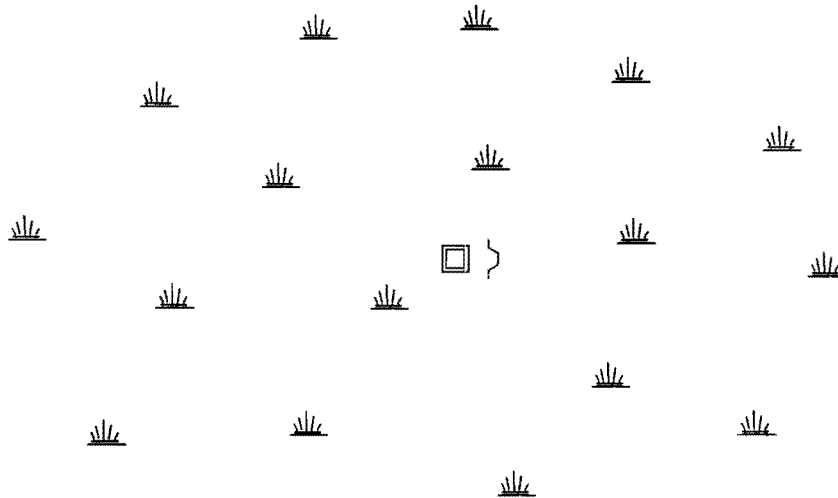

NOTE: There are no physical features available to provide reference ties.

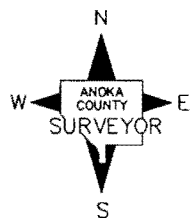

Revision Date  
**2/26/13**

N.A.D. 1983 Coordinates  
(1996 Adjustment)

County Project Coordinates	
Northing	<u>177284.4249</u>
Easting	<u>537382.7441</u>
Date	<u>2/06/13</u>

I hereby certify that this United States public land survey monument record is correct and complete to the best of my knowledge and belief.

*Larry D. Hoium* Date 2/26/13

Larry D. Hoium, Anoka County Surveyor  
Minnesota License Number 18165

# HISTORY OF GOVERNMENT CORNER

Page No. 130

County of Anoka

State of Minnesota

West 1/4 Corner of Sec. 20 Township 32 Range 22

## **CORNER HISTORY:**

February 2009 - Unable to find any evidence of an existing corner monument .

February 6, 2013 - Set 2" square steel Telspar monument in swamp using area resurvey provided by Minnesota Department of Natural Resources. There are no physical features available to provide reference ties. Set a sign and post on the east side of monument.