

# CERTIFICATE OF LOCATION OF GOVERNMENT CORNER

County of Anoka

State of Minnesota

## South $\frac{1}{4}$ Corner of Sec. 16 Township 33 Range 23

On the 16th day of November, 1970, the described corner was evidenced by a scrap iron pipe with an eye on top

and to perpetuate the location of said corner, at the exact location thereof, a permanent marker was placed consisting of a cast iron monument down 2'±

AND on the 24th day of April, 2013, said permanent marker was found and the ties were updated

Updated reference ties are as shown below.

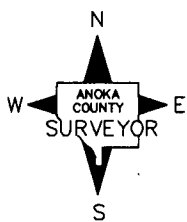
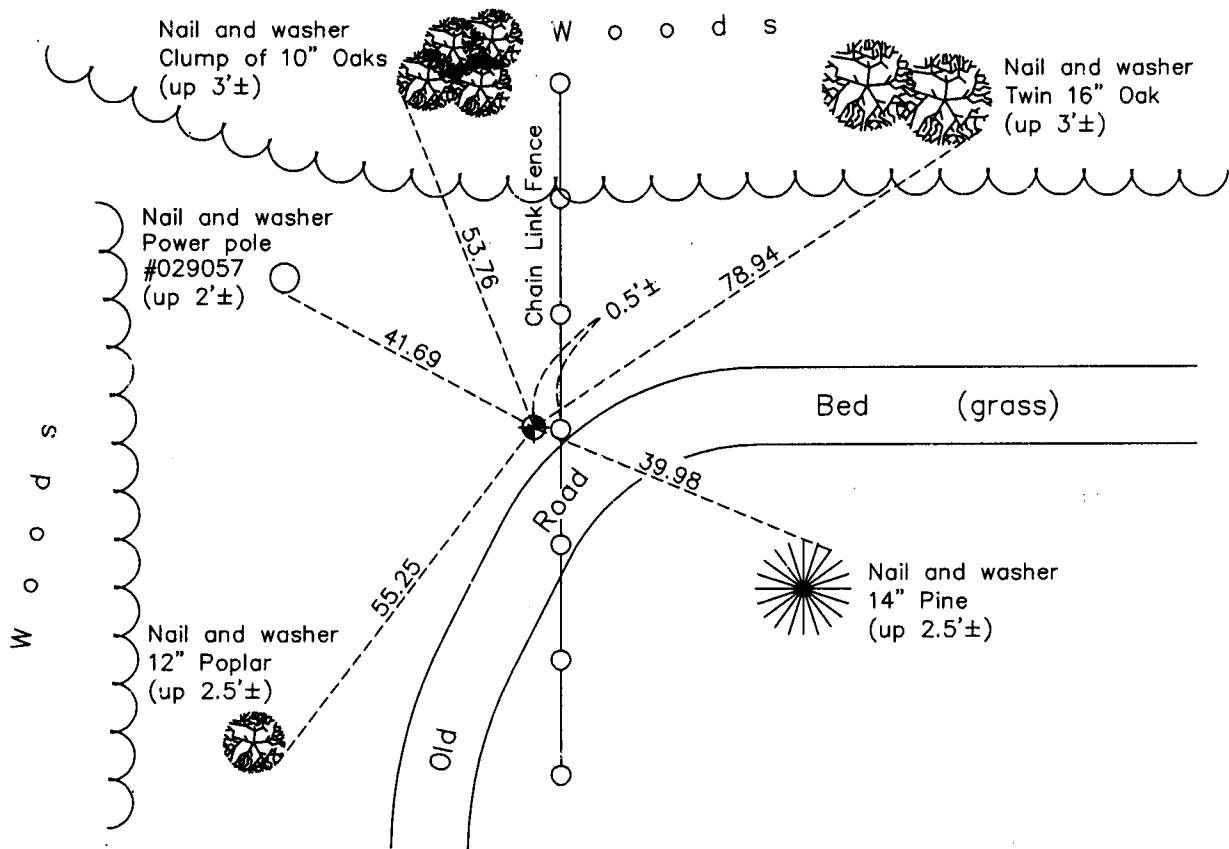

Revision Date

11/25/13

N.A.D. 1983 Coordinates  
(1996 Adjustment)

County Project Coordinates	
Northing	211611.0094
Easting	513019.3688
Date	3/26/03

I hereby certify that this United States public land survey monument record is correct and complete to the best of my knowledge and belief.

*Larry D. Hoium* Date 11/25/13

Larry D. Hoium, Anoka County Surveyor

Minnesota License Number 18165