

# CERTIFICATE OF LOCATION OF GOVERNMENT CORNER

County of Anoka

State of Minnesota

Witness Corner of Sec. 21 Township 33 Range 23  
(on east line of NE 1/4)

On the 1st day of November, 1985, the described corner was evidenced by area resurvey

and to perpetuate the location of said corner, at the exact location thereof, a permanent marker was placed consisting of a cast iron monument with a sign and post on the north side

AND on the 2nd day of April, 2013, said permanent marker was found and the ties were updated

Updated reference ties are as shown below.

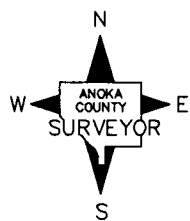
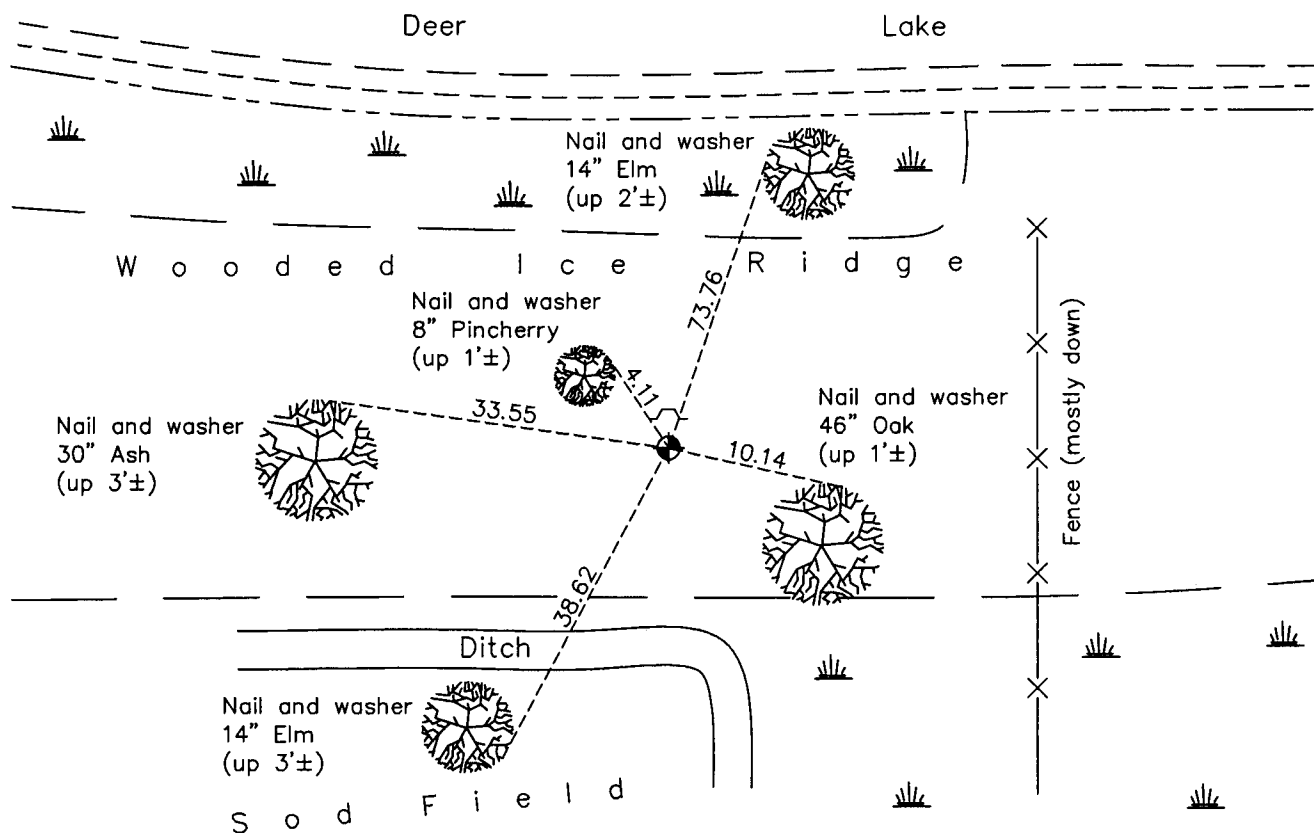

Revision Date

7/29/13

N.A.D. 1983 Coordinates  
(1996 Adjustment)

County Project Coordinates

Northing 210490.3283

Easting 515653.7700

Date 3/18/03

I hereby certify that this United States public land survey monument record is correct and complete to the best of my knowledge and belief.

*Larry D. Hoium* Date 7/29/13

Larry D. Hoium, Anoka County Surveyor

Minnesota License Number 18165