

CERTIFICATE OF LOCATION OF GOVERNMENT CORNER

County of Anoka

State of Minnesota

West 1/4 Corner of Sec. 27 Township 33 Range 23

On the 20th day of May, 1969, the described corner was evidenced by area resurvey

and to perpetuate the location of said corner, at the exact location thereof, a permanent marker was placed consisting of a cast iron monument

AND on the 5th day of December, 2012, said permanent marker was found and the ties were updated. On Sept. 21, 2012 a 6" partial CIM was set in concrete on top of inplace CIM.

Updated reference ties are as shown below.

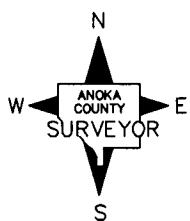
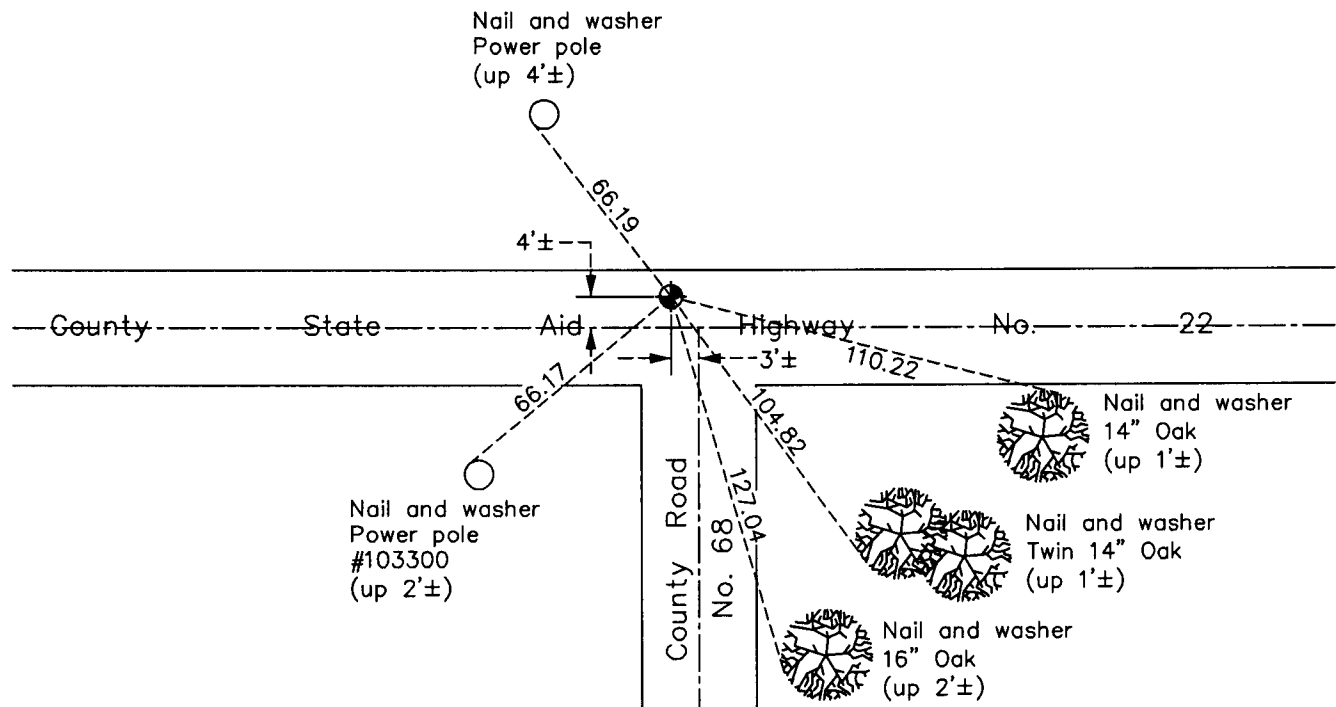

N.A.D. 1983 Coordinates
(1996 Adjustment)

County Project Coordinates

Northing 203661.6208

Easting 515831.4967

Date 5/08/02

I hereby certify that this United States public land survey monument record is correct and complete to the best of my knowledge and belief.

Larry D. Hoium Date 11/25/13

Larry D. Hoium, Anoka County Surveyor

Minnesota License Number 18165

Revision Date

11/25/13