

# CERTIFICATE OF LOCATION OF GOVERNMENT CORNER

County of Anoka

State of Minnesota

## East 1/4 Corner of Sec. 32 Township 33 Range 23

On the 1st day of November, 1963, the described corner was evidenced by area resurvey

and to perpetuate the location of said corner, at the exact location thereof, a permanent marker was placed consisting of a cast iron monument with a steel post on the south side

AND on the 1st day of March, 2013, said permanent marker was found and the ties were updated

Updated reference ties are as shown below.

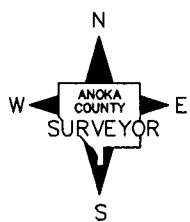
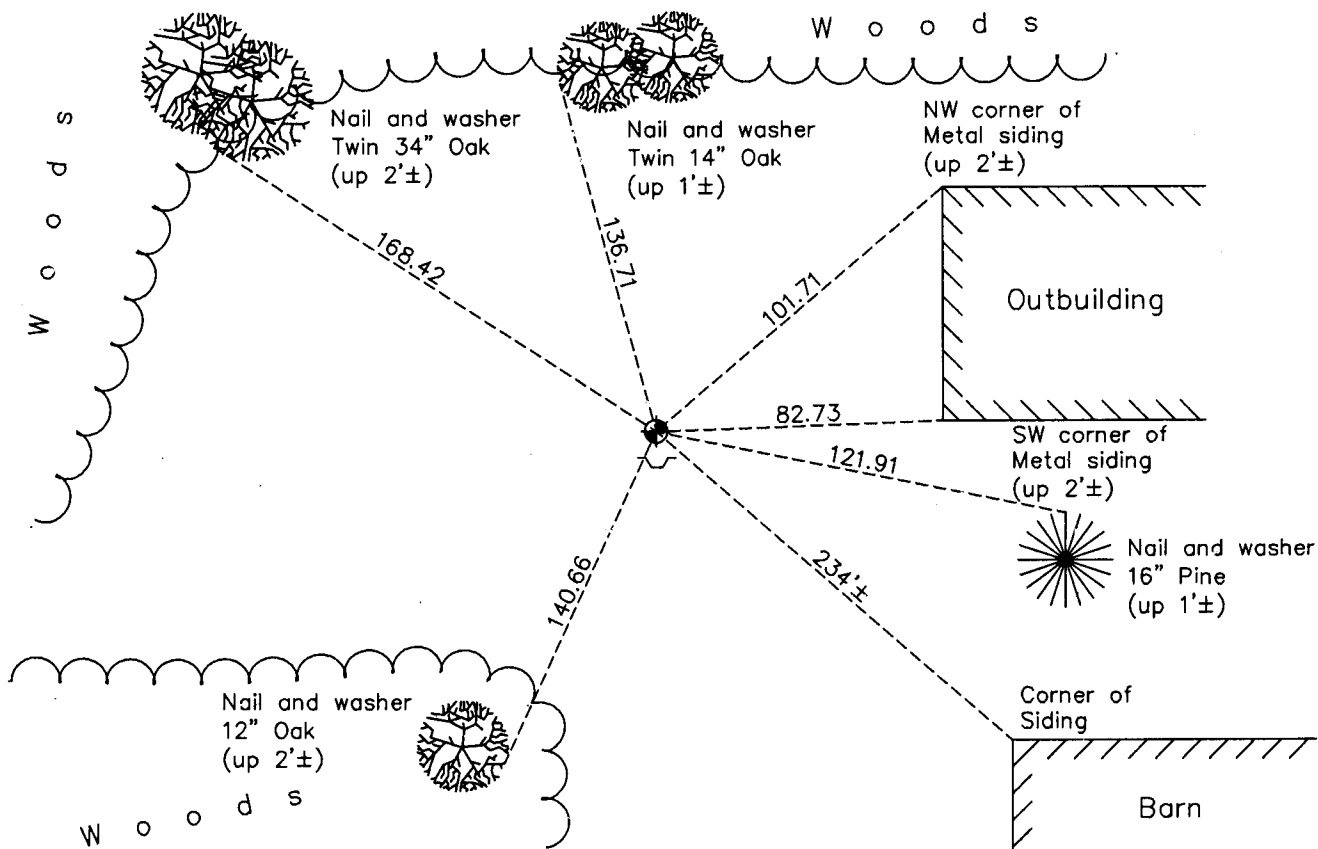

N.A.D. 1983 Coordinates  
(1996 Adjustment)

County Project Coordinates

Northing 198406.0687

Easting 510777.6492

Date 3/25/03

I hereby certify that this United States public land survey monument record is correct and complete to the best of my knowledge and belief.

*Larry D. Hoium* Date 9/09/13

Larry D. Hoium, Anoka County Surveyor

Minnesota License Number 18165

Revision Date

9/09/13