

CERTIFICATE OF LOCATION OF GOVERNMENT CORNER

County of Anoka

State of Minnesota

Southeast Corner of Sec. 25 Township 33 Range 23

On the 15th day of June, 1960, the described corner was evidenced by a concrete monument

and to perpetuate the location of said corner, at the exact location thereof, a permanent marker was placed consisting of a cast iron monument

AND on the 16th day of July, 2002, said permanent marker was found and the ties were updated

Updated reference ties are as shown below.

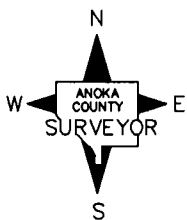
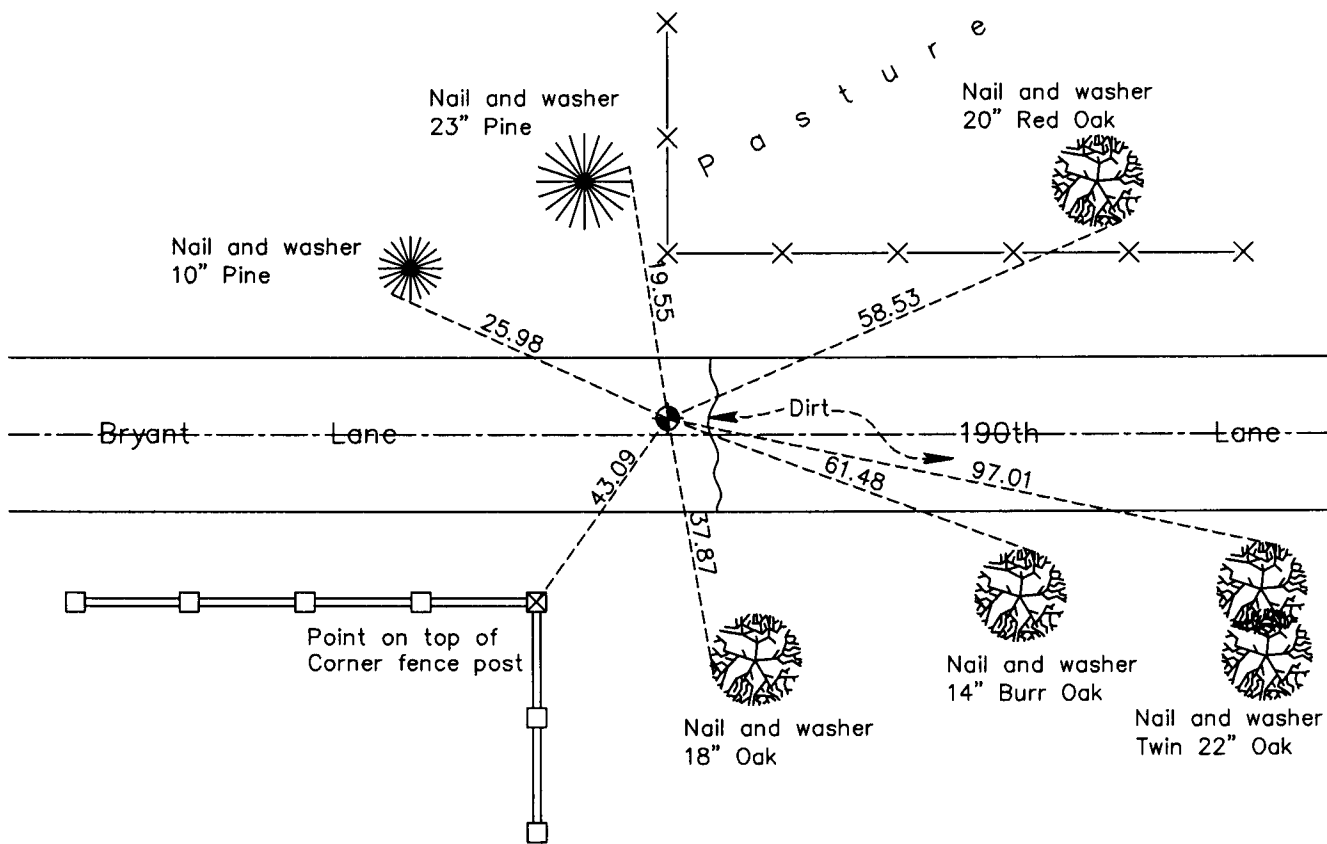

Revision Date
11/22/13

N.A.D. 1983 Coordinates
(1996 Adjustment)

County Project Coordinates	
Northing	200877.2106
Easting	531835.8958
Date	7/11/02

I hereby certify that this United States public land survey monument record is correct and complete to the best of my knowledge and belief.

Larry D. Hoium Date 11/22/13

Larry D. Hoium, Anoka County Surveyor
Minnesota License Number 18165