

# CERTIFICATE OF LOCATION OF GOVERNMENT CORNER

County of Anoka

State of Minnesota

## North 1/4 Corner of Sec. 28 Township 34 Range 23

On the 3rd day of May, 1977, the described corner was evidenced by area resurvey

and to perpetuate the location of said corner, at the exact location thereof, a permanent marker was placed consisting of a red and white iron pipe with a sign attached (facing south)

AND on the 1st day of November, 2012, said permanent marker was found and the ties were updated

Updated reference ties are as shown below.

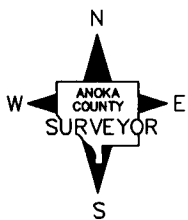
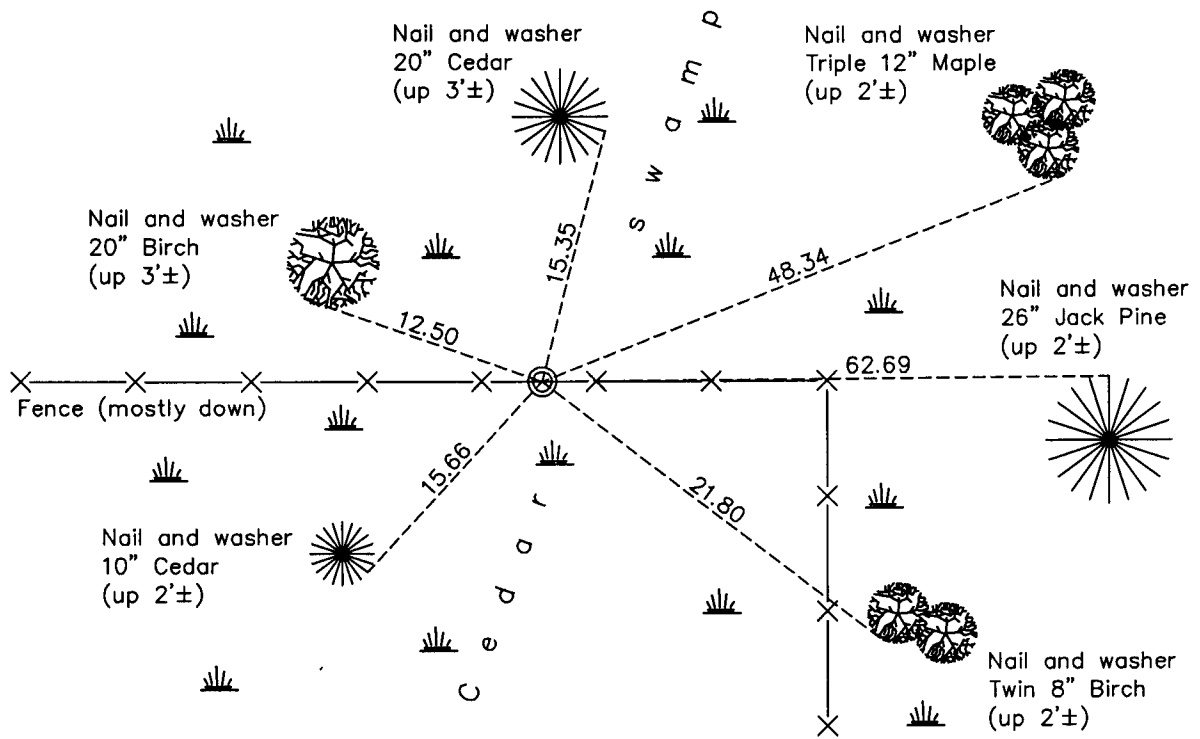

Revision Date

3/15/13

N.A.D. 1983 Coordinates  
(1996 Adjustment)

County Project Coordinates	
Northing	238155.7422
Easting	513425.5155
Date	4/14/03

I hereby certify that this United States public land survey monument record is correct and complete to the best of my knowledge and belief.

*Larry D. Hoium* Date 3/15/13

Larry D. Hoium, Anoka County Surveyor

Minnesota License Number 18165