

# CERTIFICATE OF LOCATION OF GOVERNMENT CORNER

County of Anoka

State of Minnesota

## Southeast Corner of Sec. 25 Township 34 Range 23

On the 2nd day of May, 1975, the described corner was evidenced by a 1" iron pipe

and to perpetuate the location of said corner, at the exact location thereof, a permanent marker was placed consisting of a cast iron monument

AND on the 27th day of April, 2012, said permanent marker was found and the ties were updated

Updated reference ties are as shown below.

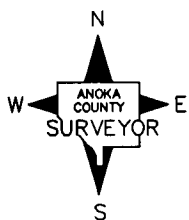
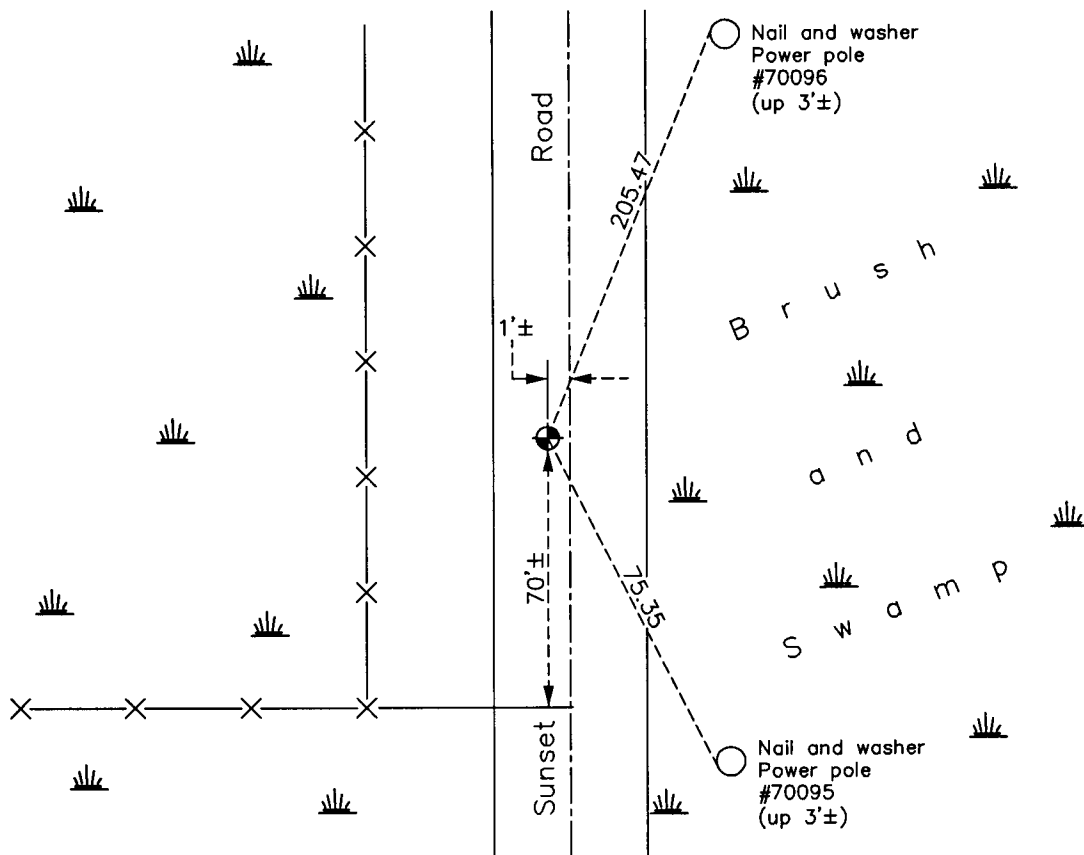

Revision Date  
 3/20/13

N.A.D. 1983 Coordinates  
 (1996 Adjustment)

County Project Coordinates	
Northing	232767.0941
Easting	531985.1914
Date	5/22/02

I hereby certify that this United States public land survey monument record is correct and complete to the best of my knowledge and belief.

*Larry D. Hoium* Date 3/20/13  
 Larry D. Hoium, Anoka County Surveyor  
 Minnesota License Number 18165