

CERTIFICATE OF LOCATION OF GOVERNMENT CORNER

County of Anoka

State of Minnesota

South 1/4 Corner of Sec. 11 Township 32 Range 24

On the 1st day of June, 1962, the described corner was evidenced by a 1/2" iron pipe in a wooden post

and to perpetuate the location of said corner, at the exact location thereof, a permanent marker was placed consisting of a red and white iron pipe

AND on the 26th day of January, 2011, said permanent marker was found leaning. On 3/14/11 a 2" square steel Telespar monument was set up 1'±. Sign & post was set on west side.

Updated reference ties are as shown below.

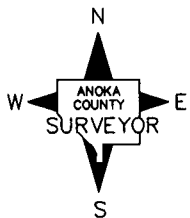
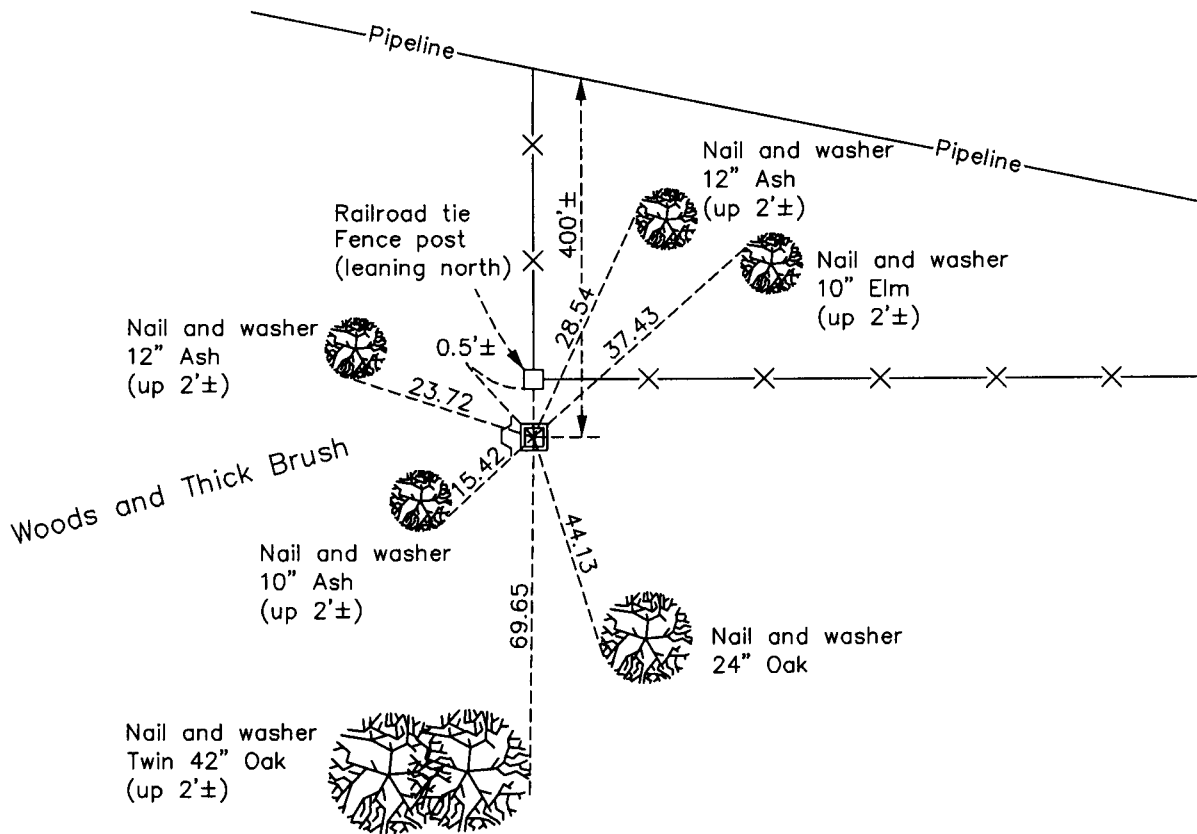

Revision Date

4/21/11

N.A.D. 1983 Coordinates
(1996 Adjustment)

County Project Coordinates	
Northing	185462.0639
Easting	492527.2769
Date	11/06/01

I hereby certify that this United States public land survey monument record is correct and complete to the best of my knowledge and belief.

Larry D. Hoium Date 4/21/11

Larry D. Hoium, Anoka County Surveyor

Minnesota License Number 18165

HISTORY OF GOVERNMENT CORNER

Page No. 40

County of Anoka

State of Minnesota

South 1/4 Corner of Sec. 11 Township 32 Range 24

CORNER HISTORY:

June 1, 1962 - Found 1/2" iron pipe set in old wood post in swamp and set a red and white iron pipe up 3' over iron. Established ties to monument.

August 17, 1964 - Found red and white iron pipe and updated ties.

July 12, 1968 - Found red and white iron pipe and updated ties.

June 21, 1972 - Found red and white iron pipe and updated ties.

May 27, 1976 - Found red and white iron pipe and updated ties.

June 1, 1979 - Found red and white iron pipe and updated ties.

June 29, 1982 - Found red and white iron pipe and updated ties.

March 15, 1983 - Replaced red and white iron pipe with a new red and white iron pipe and updated ties.

August 17, 1988 - Found red and white iron pipe and updated ties.

November 6, 2001 - Found red and white iron pipe and established NAD 1983 (1996 Adjustment) Anoka County Project Coordinates by Static GPS methods.

January 26, 2011 - Found red and white iron pipe leaning southwesterly approximately 0.5' and updated ties.

March 14, 2011 - Replaced leaning red and white iron pipe with a 2" square steel Telspar monument set up 1'± with a "County Surveyor" cap and punchmark at corner location. Verified position by VRS GPS methods. Also set sign and post on west side of monument.