

# CERTIFICATE OF LOCATION OF GOVERNMENT CORNER

County of Anoka

State of Minnesota

## South 1/4 Corner of Sec. 27 Township 32 Range 24

On the 10th day of August, 1960, the described corner was evidenced by a steel fence post

and to perpetuate the location of said corner, at the exact location thereof, a permanent marker was placed consisting of a red and white iron pipe with a sign attached

AND on the 4th day of November, 2010, said permanent marker was found with the sign facing east and the ties were updated

Updated reference ties are as shown below.

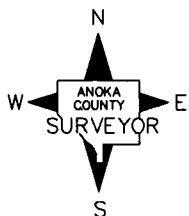
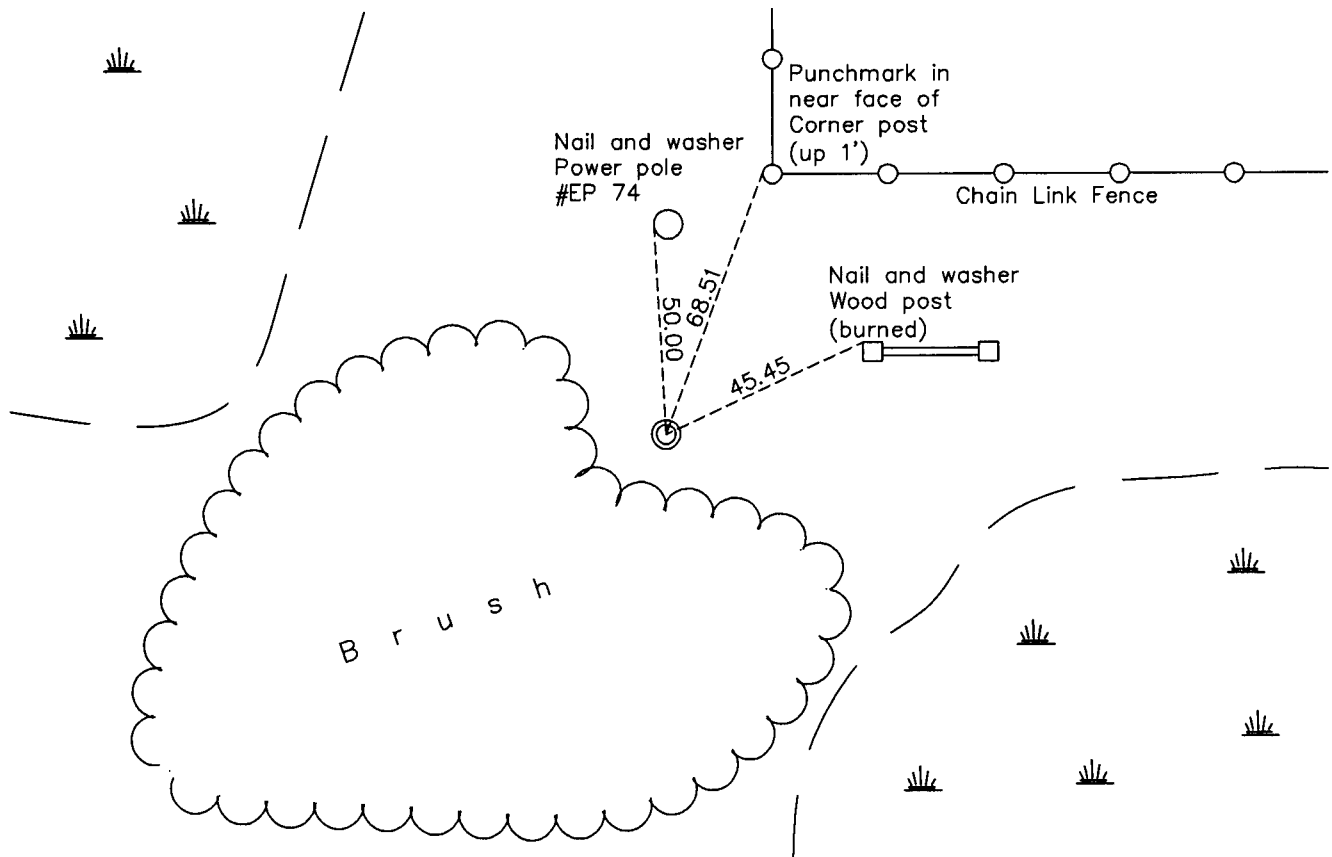

Revision Date

6/13/11

N.A.D. 1983 Coordinates  
(1996 Adjustment)

County Project Coordinates	
Northing	<u>169789.1123</u>
Easting	<u>487176.0634</u>
Date	<u>8/10/88</u>

I hereby certify that this United States public land survey monument record is correct and complete to the best of my knowledge and belief.

*Larry D. Hoium* Date 6/13/11

Larry D. Hoium, Anoka County Surveyor

Minnesota License Number 18165

# HISTORY OF GOVERNMENT CORNER

Page No. 103

County of Anoka

State of Minnesota

## South 1/4 Corner of Sec. 27 Township 32 Range 24

### **CORNER HISTORY:**

August 10, 1960 - Found steel fence post up 3.5'± in swamp. Established ties to monument.

August 26, 1964 - Found steel fence post and updated ties.

July 29, 1968 - Found steel fence post and updated ties.

Date unknown - Found steel fence post and updated ties.

July 19, 1977 - Set red and white iron pipe up 3'± using three original transit ties. Attached sign to iron pipe and updated ties to transit ties. Iron pipe matches location of plat to the west.

August 15, 1979 - Found red and white iron pipe up 3.5'± and set transit ties to iron pipe. Updated ties to transit ties.

July 6, 1982 - Found red and white iron pipe and updated ties.

August 10, 1988 - Found red and white iron pipe and updated ties.

October 24, 1995 - Replaced red and white iron pipe with a new red and white iron pipe with sign attached. Updated ties.

November 16, 2000 - Found red and white iron pipe and established NAD 1983 (1996 Adjustment) Anoka County Project Coordinates by Static GPS methods. Updated ties.

November 4, 2010 - Found red and white iron pipe with sign attached facing east and updated ties.