

CERTIFICATE OF LOCATION OF GOVERNMENT CORNER

County of Anoka

State of Minnesota

East 1/4 Corner of Sec. 31 Township 32 Range 24

On the ____ day of July, 1956, the described corner was evidenced by a 1" iron pipe
in an old rotted post

and to perpetuate the location of said corner, at the exact location thereof, a permanent marker
was placed consisting of a red and white iron pipe

AND on the 9th day of December, 2010, said permanent marker was found up 4'± and the
ties were updated

Updated reference ties are as shown below.

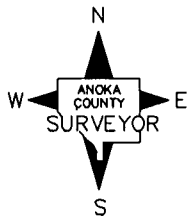
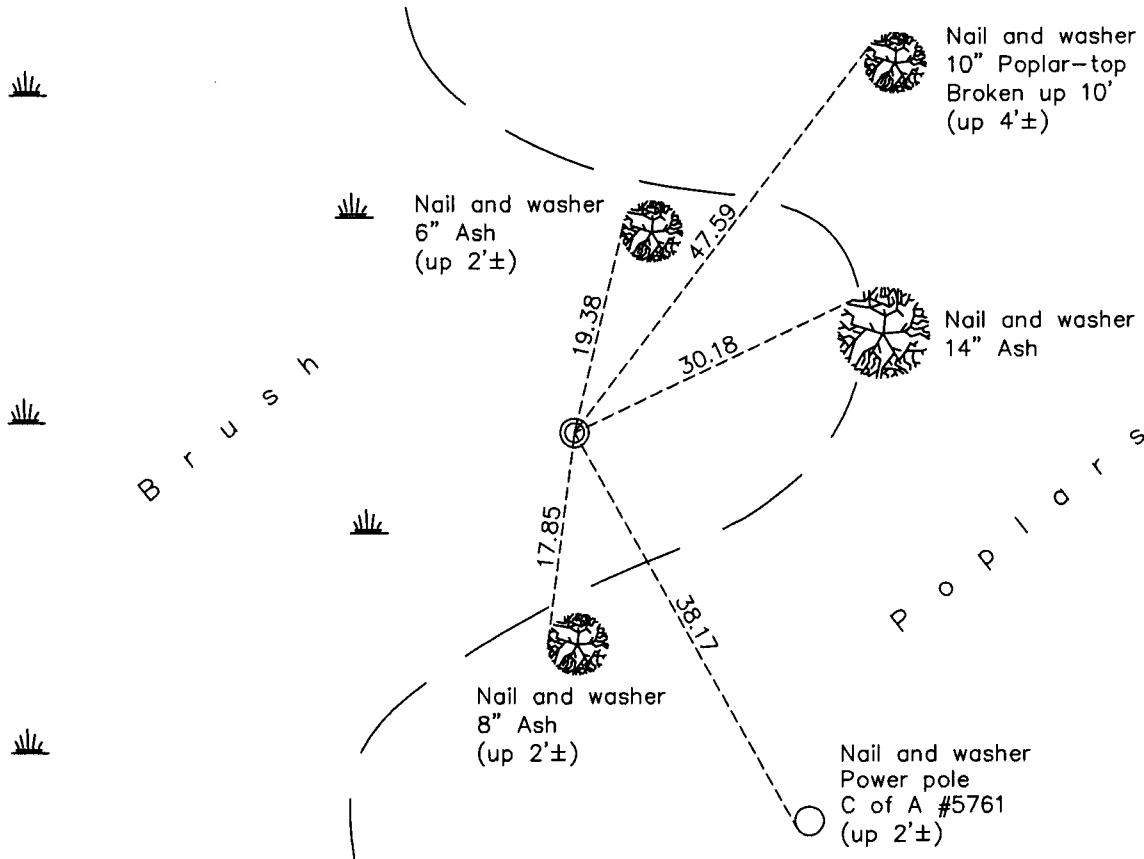

Revision Date

6/22/11

N.A.D. 1983 Coordinates
(1996 Adjustment)

County Project Coordinates	
Northing	167216.4311
Easting	473978.7559
Date	12/01/00

I hereby certify that this United States public land survey monument record is correct and complete to the best of my knowledge and belief.

Larry D. Hoium Date 6/22/11

Larry D. Hoium, Anoka County Surveyor

Minnesota License Number 18165

HISTORY OF GOVERNMENT CORNER

Page No. 112

County of Anoka

State of Minnesota

East 1/4 Corner of Sec. 31 Township 32 Range 24

CORNER HISTORY:

July 1956 - Willard Lundstrom found an old rotten wood post below the surface. The position of the post agreed with lines of occupation in the SE 1/4.

August 2, 1956 - W. Lundstrom set 3/4" iron pipe in center of wood post.

December 9, 1964 - Replaced 3/4" iron pipe with a 1" X 10' red and white iron pipe set 4'± above the surface. Updated ties.

July 25, 1968 - Found red and white iron pipe and updated ties.

July 1974 - A section resurvey was performed. It was found that the position of the iron pipe agreed with the position set by W. Lundstrom (see field notes) .

January 26, 1978 - Found red and white iron pipe up 3'± and updated ties.

June 12, 1979 - Found red and white iron pipe and updated ties.

June 13, 1985 - Found red and white iron pipe and updated ties.

August 19, 1988 - Found red and white iron pipe and updated ties.

December 1, 2000 - Found red and white iron pipe and established NAD 1983 (1996 Adjustment) Anoka County Project Coordinates by Static GPS methods. Updated ties.

December 09, 2010 - Found 2" red and white iron pipe up 4'± and updated ties.