

CERTIFICATE OF LOCATION OF GOVERNMENT CORNER

County of Anoka

State of Minnesota

Northeast Corner of Sec. 36 Township 32 Range 24

On the 13th day of September, 1960, the described corner was evidenced by a granite monument

and to perpetuate the location of said corner, at the exact location thereof, a permanent marker was placed consisting of a cast iron monument

AND on the 31st day of January, 2011, said permanent marker was found and the ties were updated

Updated reference ties are as shown below.

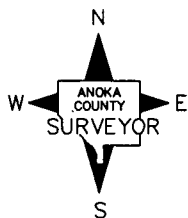
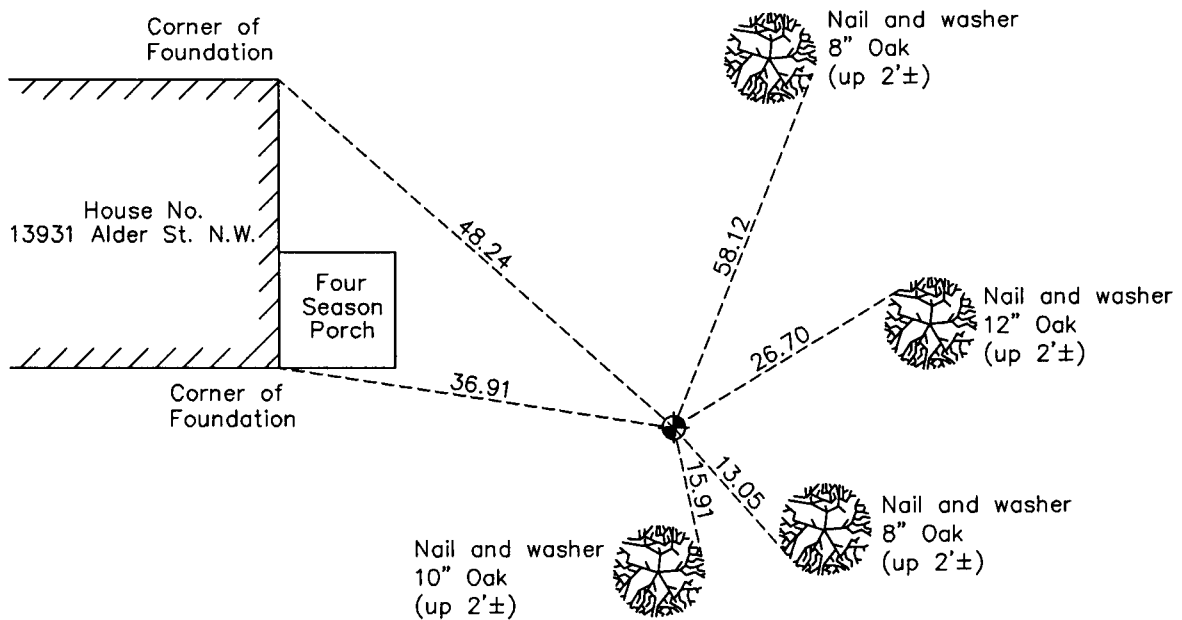

Revision Date

6/28/11

N.A.D. 1983 Coordinates
(1996 Adjustment)

County Project Coordinates	
Northing	169613.6568
Easting	500278.2289
Date	11/19/01

I hereby certify that this United States public land survey monument record is correct and complete to the best of my knowledge and belief.

Larry D. Hoium Date 6/28/11

Larry D. Hoium, Anoka County Surveyor
Minnesota License Number 18165

CERTIFICATE OF LOCATION OF GOVERNMENT CORNER

County of Anoka

State of Minnesota

Northeast Corner of Sec. 36 Township 32 Range 24

On the 13th day of September, 1960, the described corner was evidenced by a granite monument

and to perpetuate the location of said corner, at the exact location thereof, a permanent marker was placed consisting of a cast iron monument

AND on the 31st day of January, 2011, said permanent marker was found and the ties were updated

Updated reference ties are as shown below.

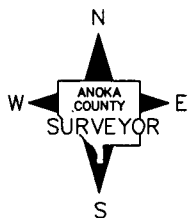
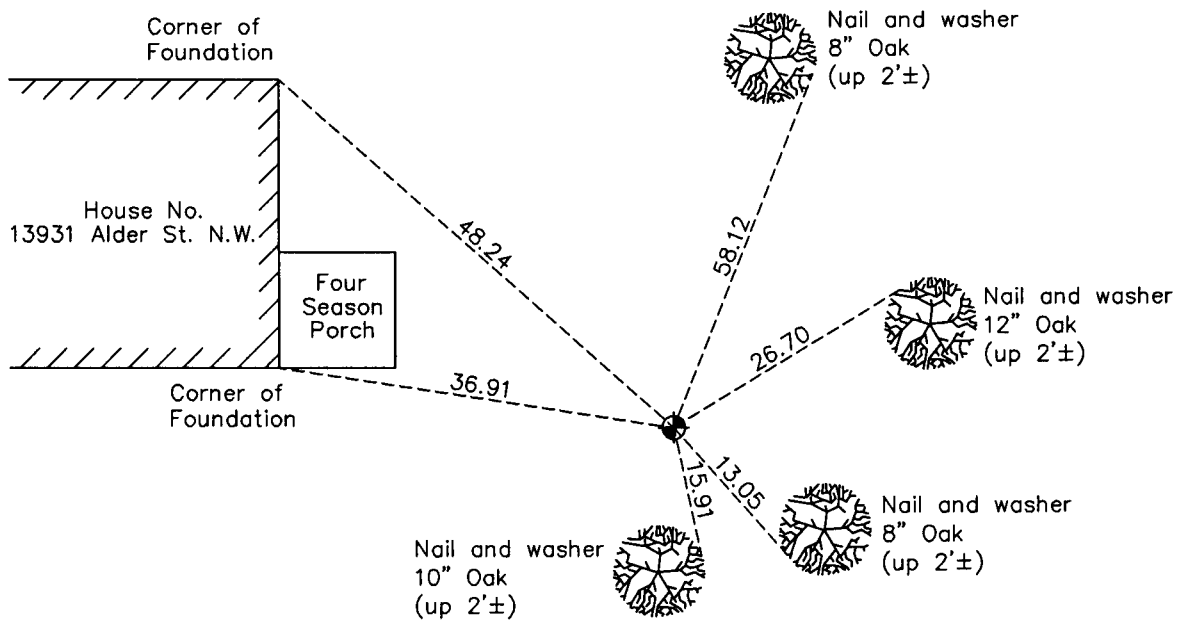

Revision Date

6/28/11

N.A.D. 1983 Coordinates
(1996 Adjustment)

County Project Coordinates	
Northing	<u>169613.6568</u>
Easting	<u>500278.2289</u>
Date	<u>11/19/01</u>

I hereby certify that this United States public land survey monument record is correct and complete to the best of my knowledge and belief.

Larry D. Hoium Date 6/28/11

Larry D. Hoium, Anoka County Surveyor
Minnesota License Number 18165

HISTORY OF GOVERNMENT CORNER

County of Anoka

State of Minnesota

Northeast Corner of Sec. 36 Township 32 Range 24

CORNER HISTORY:

Unable to locate field notes prior to November 19, 2001.

November 19, 2001 - Found corner monument missing due to construction. Reset position of corner with a cast iron monument using area resurvey and verified position by Static GPS methods.

January 31, 2011 - Found cast iron monument and updated ties.