

CERTIFICATE OF LOCATION OF GOVERNMENT CORNER

County of Anoka

State of Minnesota

East 1/4 Corner of Sec. 25 Township 32 Range 24

On the 14th day of September, 1960, the described corner was evidenced by a concrete monument

and to perpetuate the location of said corner, at the exact location thereof, a permanent marker was placed consisting of a cast iron monument

AND on the ___ day of ___ June, 2012, said permanent marker was raised to the surface after overlay of road was completed

Updated reference ties are as shown below.

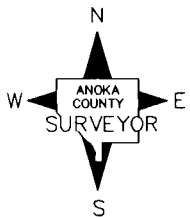
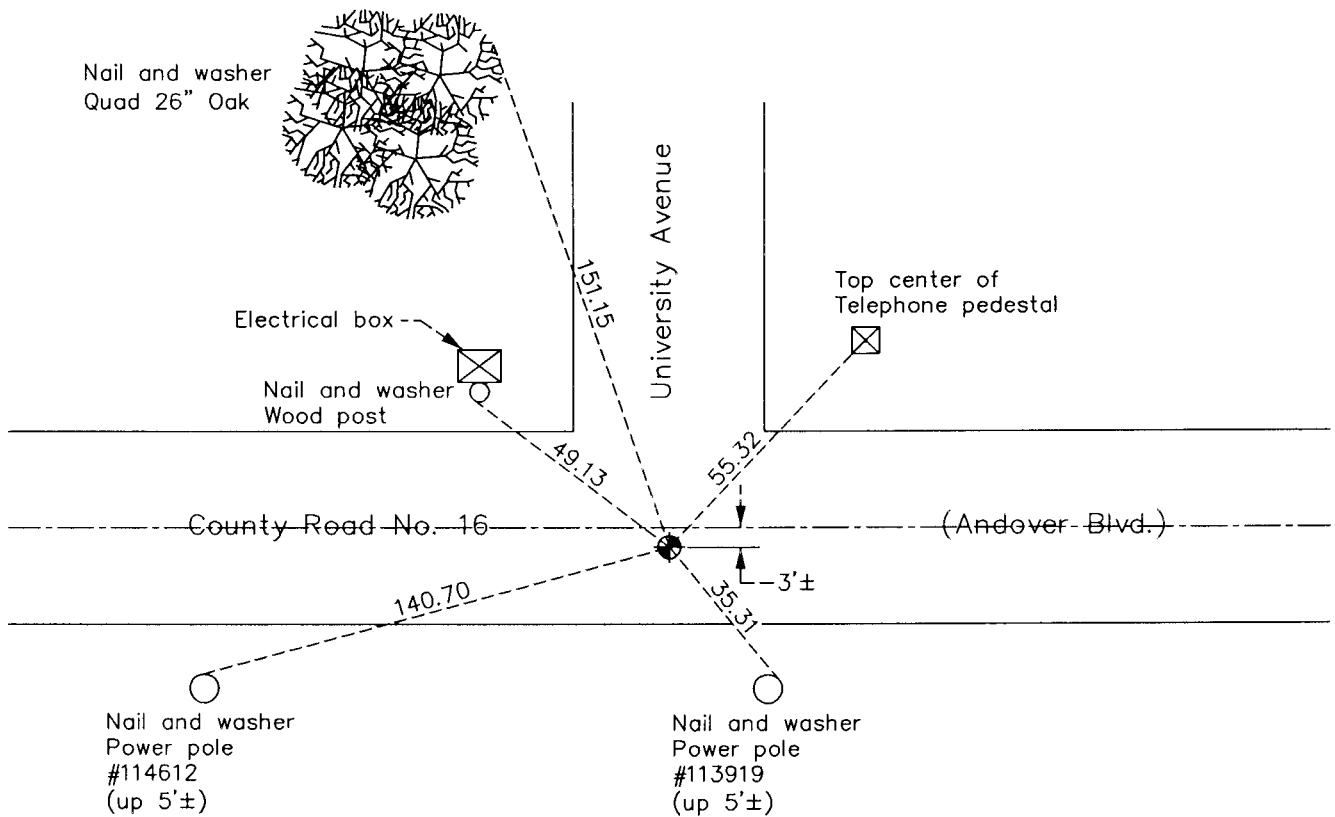

N.A.D. 1983 Coordinates
(1996 Adjustment)

County Project Coordinates

Northing 172197.3230
Easting 500288.9357
Date 10/24/00

Revision Date
12/17/12

I hereby certify that this United States public land survey monument record is correct and complete to the best of my knowledge and belief.

Larry D. Hoium Date 12/17/12

Larry D. Hoium, Anoka County Surveyor
Minnesota License Number 18165

HISTORY OF GOVERNMENT CORNER

Page No. 125

County of Anoka

State of Minnesota

East 1/4 Corner of Sec. 25 Township 32 Range 24

CORNER HISTORY:

October 27, 1943 - H.A. Cartwright found concrete monument. Established ties to monument.

September 14, 1960 - Found concrete monument down 2.5'. Set cast iron monument over concrete monument and flush with the surface. Updated ties.

July 21, 1964 - Found cast iron monument and updated ties.

August 8, 1966 - Found cast iron monument and updated ties.

May 20, 1971 - Found cast iron monument and updated ties.

August 21, 1973 - Found cast iron monument and raised it to the surface. Updated ties.

June 16, 1975 - Found cast iron monument and updated ties.

June 16, 1978 - Found cast iron monument and updated ties.

July 2, 1987 - Found cast iron monument and updated ties.

October 27, 1991 - Found cast iron monument and updated ties.

October 24, 2000 - Found cast iron monument and established NAD 1983 (1996 Adjustment) Anoka County Project Coordinates by Static GPS methods. Updated ties.

October 22, 2010 - Found cast iron monument flush with the surface and updated ties.

May 24, 2012 - Loosened top of cast iron monument prior to overlaying road surface.

June 2012 - Added spacer/s and replaced top of cast iron monument after overlay. Monument is flush with surface.