

CERTIFICATE OF LOCATION OF GOVERNMENT CORNER

County of Anoka

State of Minnesota

Northeast Corner of Sec. 27 Township 31 Range 23

On the 28th day of September, 1971, the described corner was evidenced by a concrete monument

and to perpetuate the location of said corner, at the exact location thereof, a permanent marker was placed consisting of a 1/2" iron pipe and cap on south side of manhole

AND on the 24th day of June, 2014, said permanent marker was found to be a P.K. nail. Replaced with a new cast iron monument set 0.1'± below surface and updated ties on July 8, 2014.

Updated reference ties are as shown below.

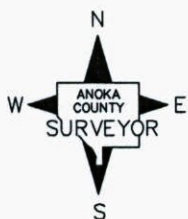
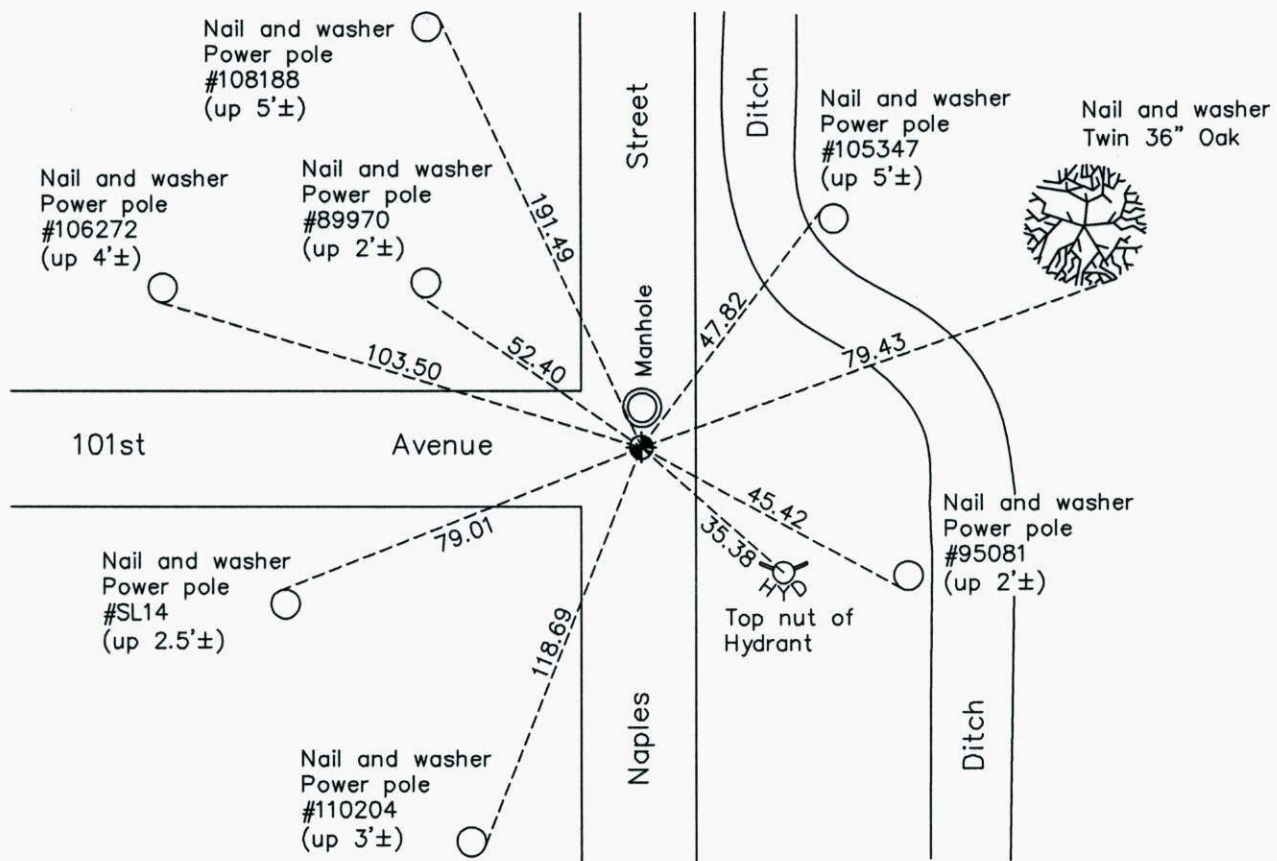

Revision Date
10/07/14

N.A.D. 1983 Coordinates
(1996 Adjustment)

County Project Coordinates	
Northing	143037.9495
Easting	521334.5342
Date	10/27/98

I hereby certify that this United States public land survey monument record is correct and complete to the best of my knowledge and belief.

Larry D. Hoium Date 10/07/14

Larry D. Hoium, Anoka County Surveyor
Minnesota License Number 18165