

# CERTIFICATE OF LOCATION OF GOVERNMENT CORNER

County of Anoka

State of Minnesota

## South $\frac{1}{4}$ Corner of Sec. 31 Township 31 Range 23

On the 28th day of June, 1960, the described corner was evidenced by a broken off concrete monument

and to perpetuate the location of said corner, at the exact location thereof, a permanent marker was placed consisting of a P.K. nail 1.31 feet northeast of the center of a manhole cover

AND on the 8th day of July, 2014, said permanent marker was found missing. Replaced with a 1/2"X3" iron pipe and 'Anoka County' cap. Updated ties.

Updated reference ties are as shown below.

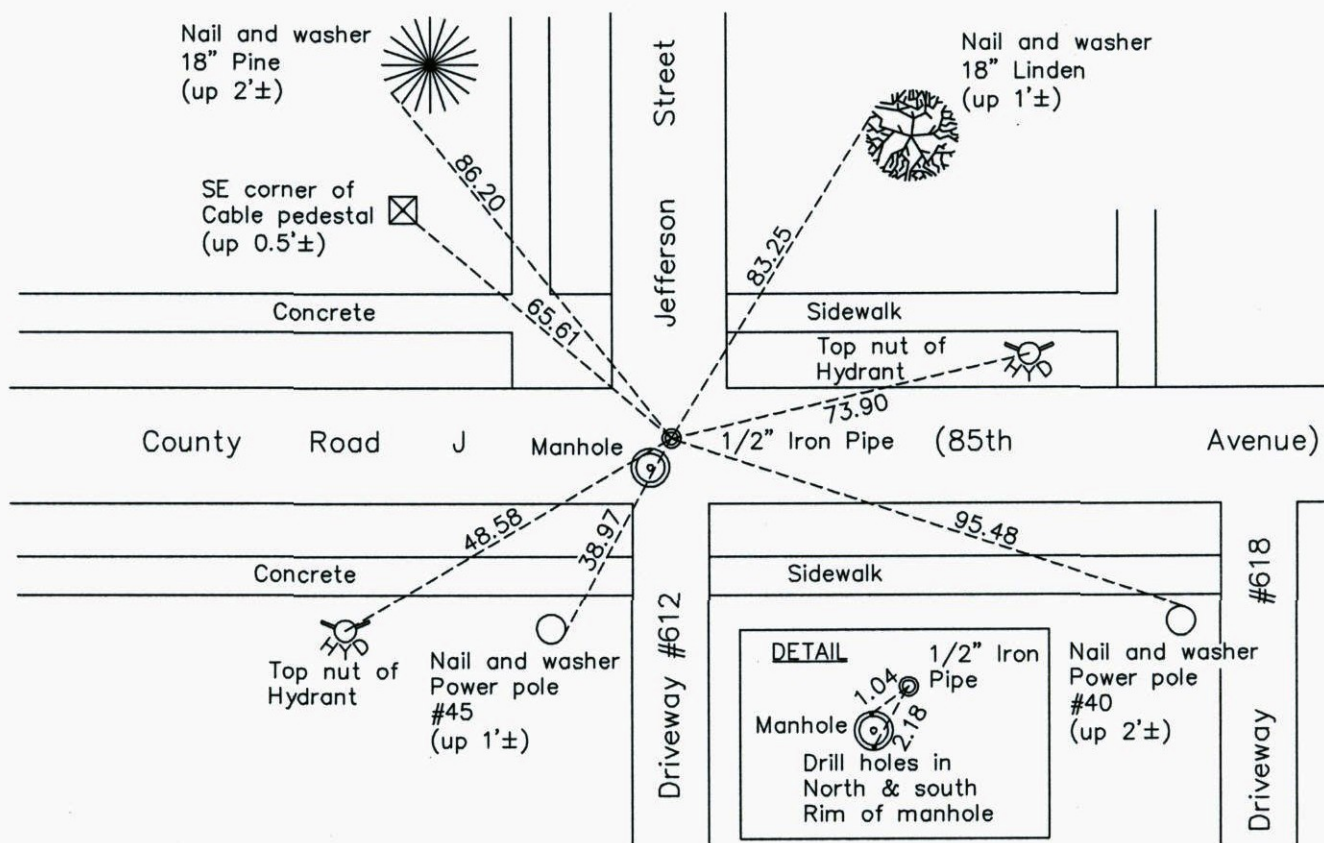

Revision Date  
10/03/14

N.A.D. 1983 Coordinates  
(1996 Adjustment)

County Project Coordinates	
Northing	132550.5204
Easting	502764.0269
Date	7/29/99

I hereby certify that this United States public land survey monument record is correct and complete to the best of my knowledge and belief.

*Larry D. Hoium* Date 10/03/14

Larry D. Hoium, Anoka County Surveyor  
Minnesota License Number 18165