

CERTIFICATE OF LOCATION OF GOVERNMENT CORNER

County of Anoka

State of Minnesota

Southwest Corner of Sec. 25 Township 32 Range 23

On the 3rd day of August, 1964, the described corner was evidenced by a granite monument

and to perpetuate the location of said corner, at the exact location thereof, a permanent marker was placed consisting of a cast iron monument

AND on the 25th day of October, 2013, said permanent marker was replaced with a new cast iron monument after road construction and the ties were updated

Updated reference ties are as shown below.

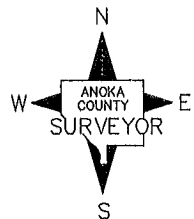
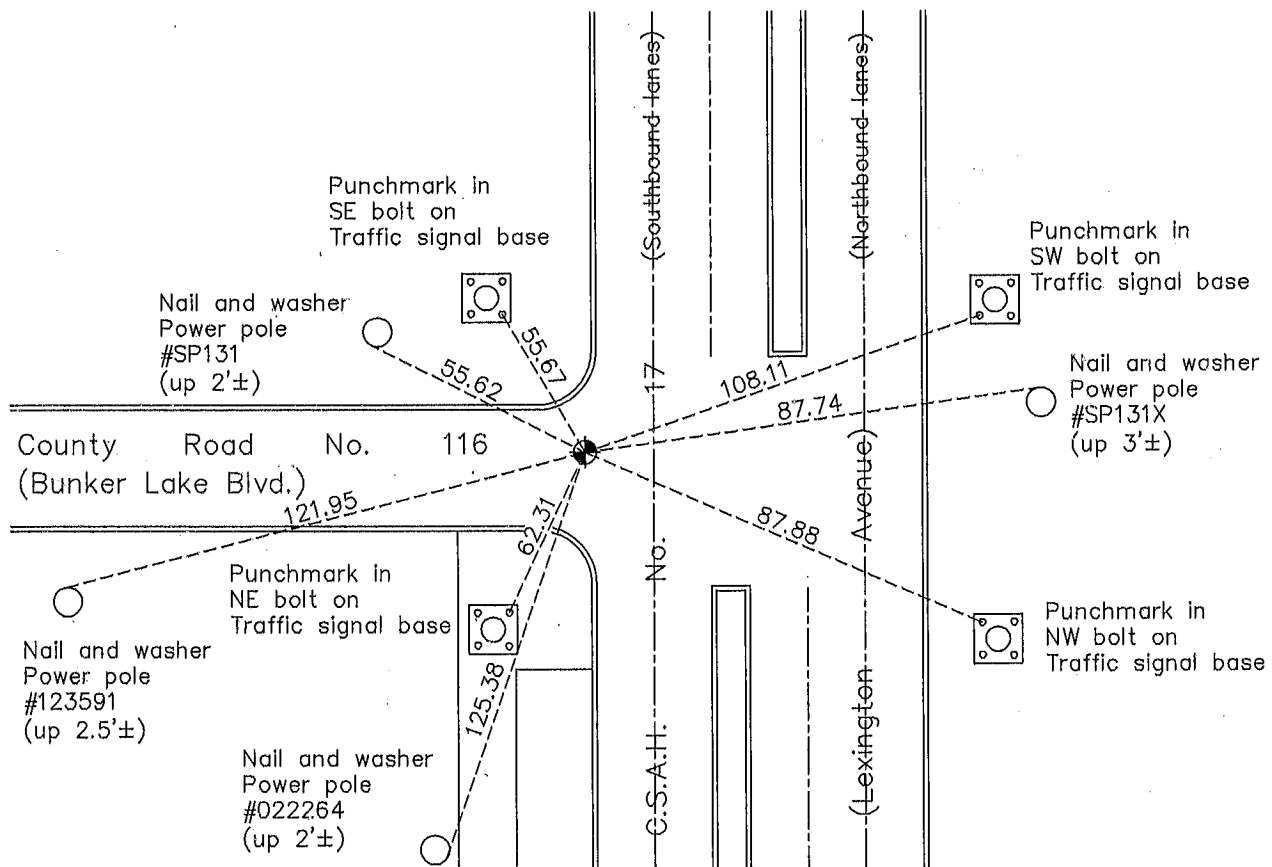

Revision Date

3/27/14

N.A.D. 1983 Coordinates
(1996 Adjustment)

County Project Coordinates	
Northing	169438.9728
Easting	526703.1197
Date	12/13/01

I hereby certify that this United States public land survey monument record is correct and complete to the best of my knowledge and belief.

Larry D. Hoium Date 3/27/14

Larry D. Hoium, Anoka County Surveyor
Minnesota License Number 18165