

CERTIFICATE OF LOCATION OF GOVERNMENT CORNER

County of Anoka

State of Minnesota

East 1/4 Corner of Sec. 31 Township 31 Range 22

On the 10th day of April, 1962, the described corner was evidenced by a 4" square concrete monument

and to perpetuate the location of said corner, at the exact location thereof, a permanent marker was placed consisting of a cast iron monument

AND on the 12th day of December, 2013, said permanent marker was found flush with the surface and the ties were updated

Updated reference ties are as shown below.

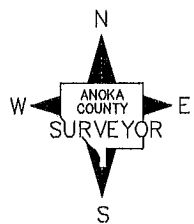
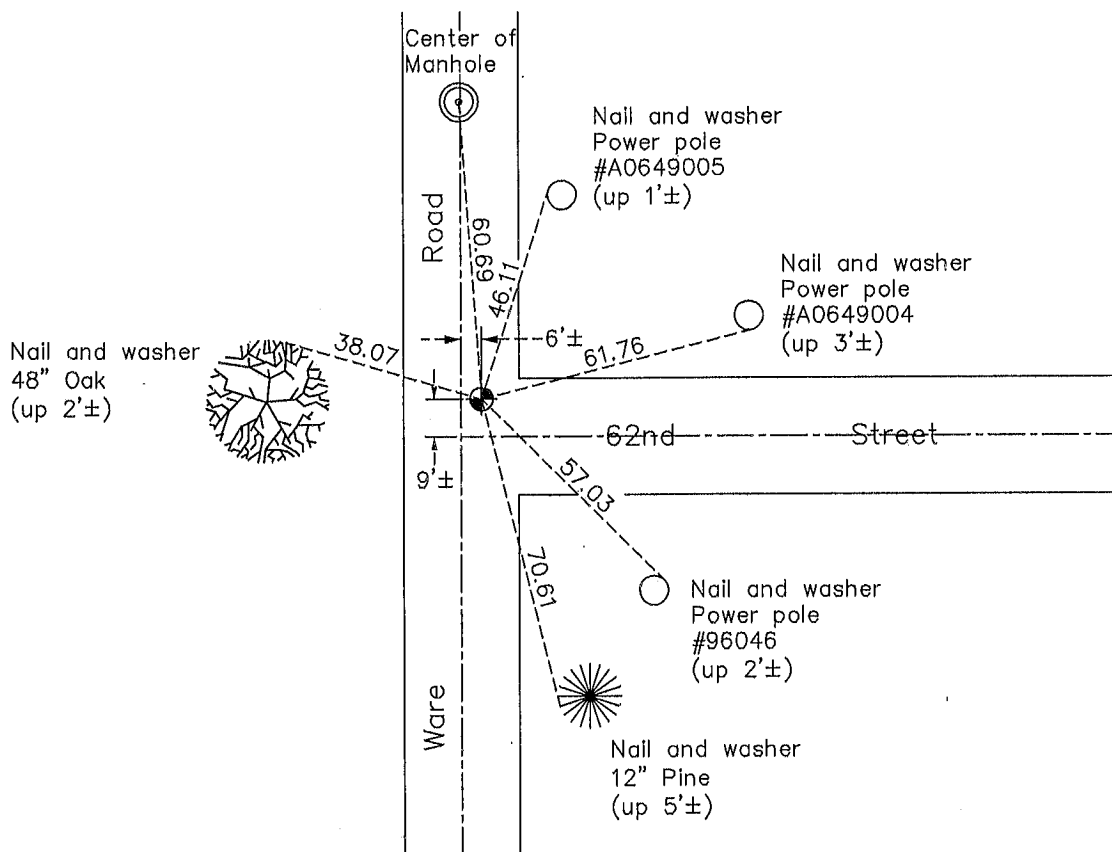

Revision Date

3/25/14

N.A.D. 1983 Coordinates
(1996 Adjustment)

County Project Coordinates	
Northing	135073.7673
Easting	537297.2089
Date	6/13/96

I hereby certify that this United States public land survey monument record is correct and complete to the best of my knowledge and belief.

Date 3/25/14
 Larry D. Holum, Anoka County Surveyor
 Minnesota License Number 18165