

CERTIFICATE OF LOCATION OF GOVERNMENT CORNER

County of Anoka

State of Minnesota

Witness Corner of Sec. 32 Township 33 Range 25

(On east line of NE 1/4)

On the 29th day of August, 1988, the described corner was evidenced by area resurvey

and to perpetuate the location of said corner, at the exact location thereof, a permanent marker was placed consisting of a cast iron monument with a sign and post on the north side

AND on the 4th day of November, 2013, said permanent marker was found broken. Replaced with new cast iron monument and updated ties. No sign and post found or reset.

Updated reference ties are as shown below.

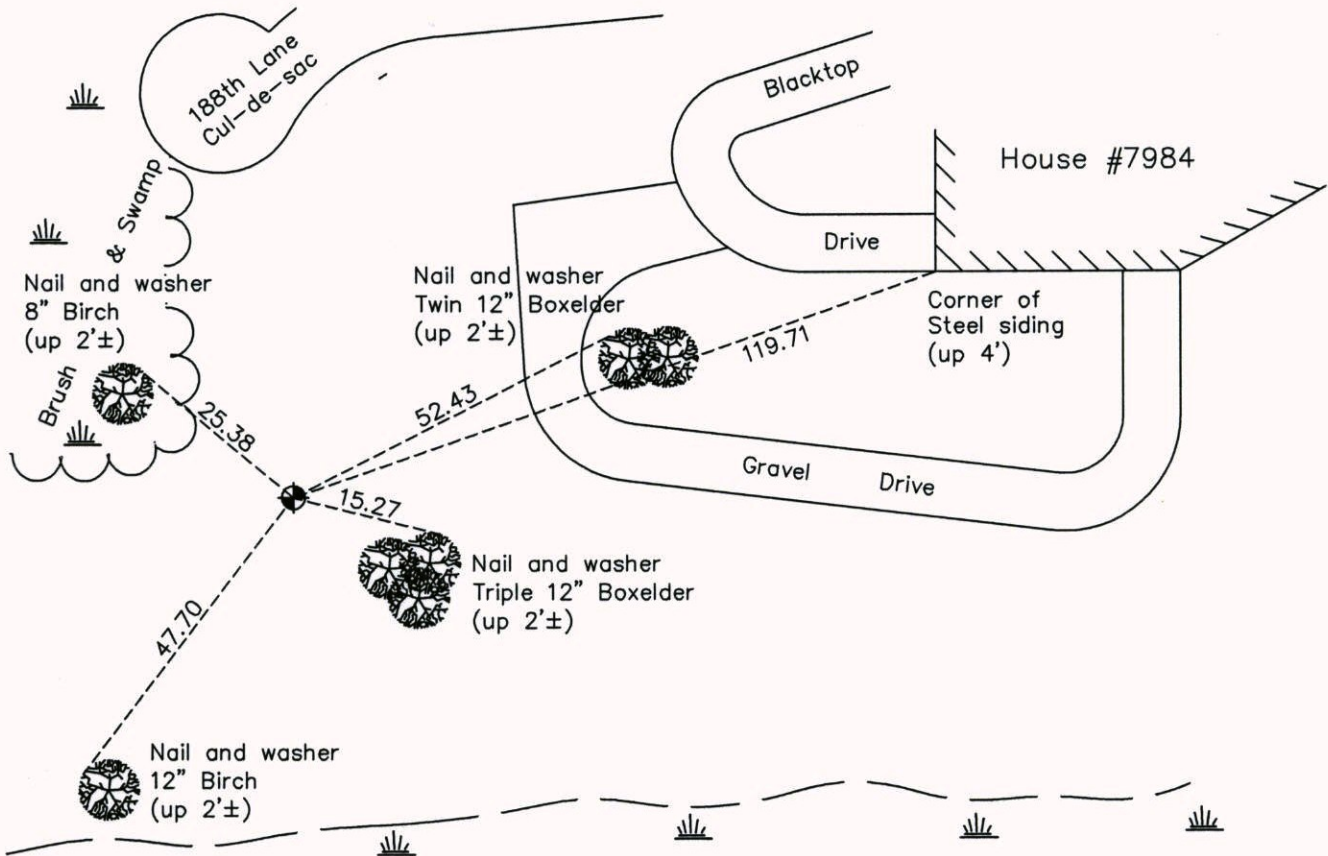

N

 ANOKA COUNTY SURVEYOR
 S
 Revision Date
9/30/14

N.A.D. 1983 Coordinates
(1996 Adjustment)

County Project Coordinates	
Northing	200712.4233
Easting	447704.7917
Date	2/25/03

I hereby certify that this United States public land survey monument record is correct and complete to the best of my knowledge and belief.

Larry D. Hoium Date 9/30/14

Larry D. Hoium, Anoka County Surveyor
 Minnesota License Number 18165