

# CERTIFICATE OF LOCATION OF GOVERNMENT CORNER

County of Anoka

State of Minnesota

## South 1/4 Corner of Sec. 18 Township 31 Range 23

On the 1st day of November, 1960, the described corner was evidenced by an iron pipe

and to perpetuate the location of said corner, at the exact location thereof, a permanent marker was placed consisting of a cast iron monument

AND on the 12th day of May, 2014, said permanent marker was found and the ties were updated

Updated reference ties are as shown below.

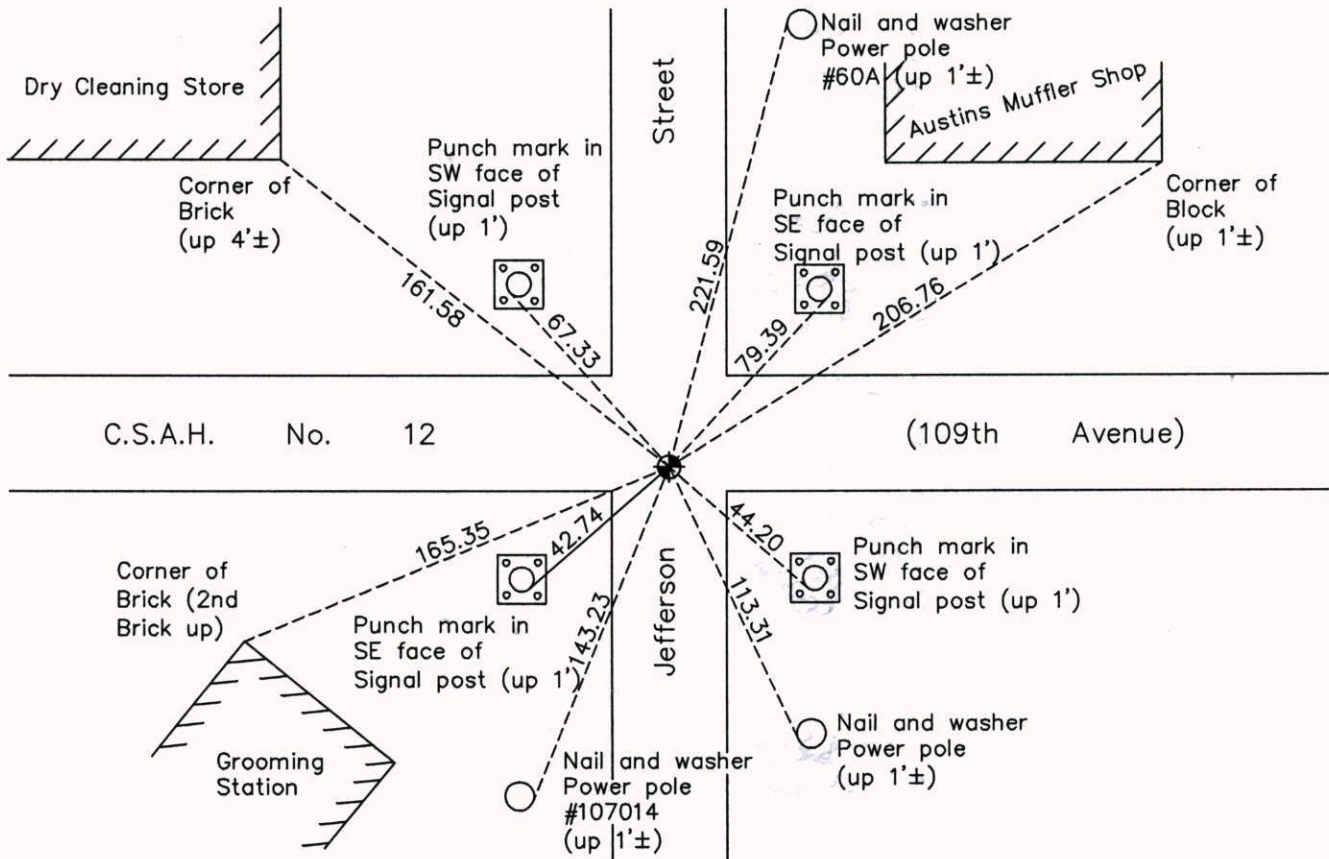

Revision Date  
2/18/15

N.A.D. 1983 Coordinates  
(1996 Adjustment)

County Project Coordinates	
Northing	148419.7154
Easting	502831.2463
Date	9/30/98

I hereby certify that this United States public land survey monument record is correct and complete to the best of my knowledge and belief.

*Larry D. Hoium* Date 2/18/15

Larry D. Hoium, Anoka County Surveyor  
Minnesota License Number 18165