

CERTIFICATE OF LOCATION OF GOVERNMENT CORNER

County of Anoka

State of Minnesota

South 1/4 Corner of Sec. 21 Township 31 Range 23

On the 30th day of October, 1964, the described corner was evidenced by area resurvey

and to perpetuate the location of said corner, at the exact location thereof, a permanent marker was placed consisting of a cast iron monument with a sign and post on the south side

AND on the 21st day of July, 2014, said permanent marker was found and the ties were updated

Updated reference ties are as shown below.

North Airport Entrance Road (blacktop)

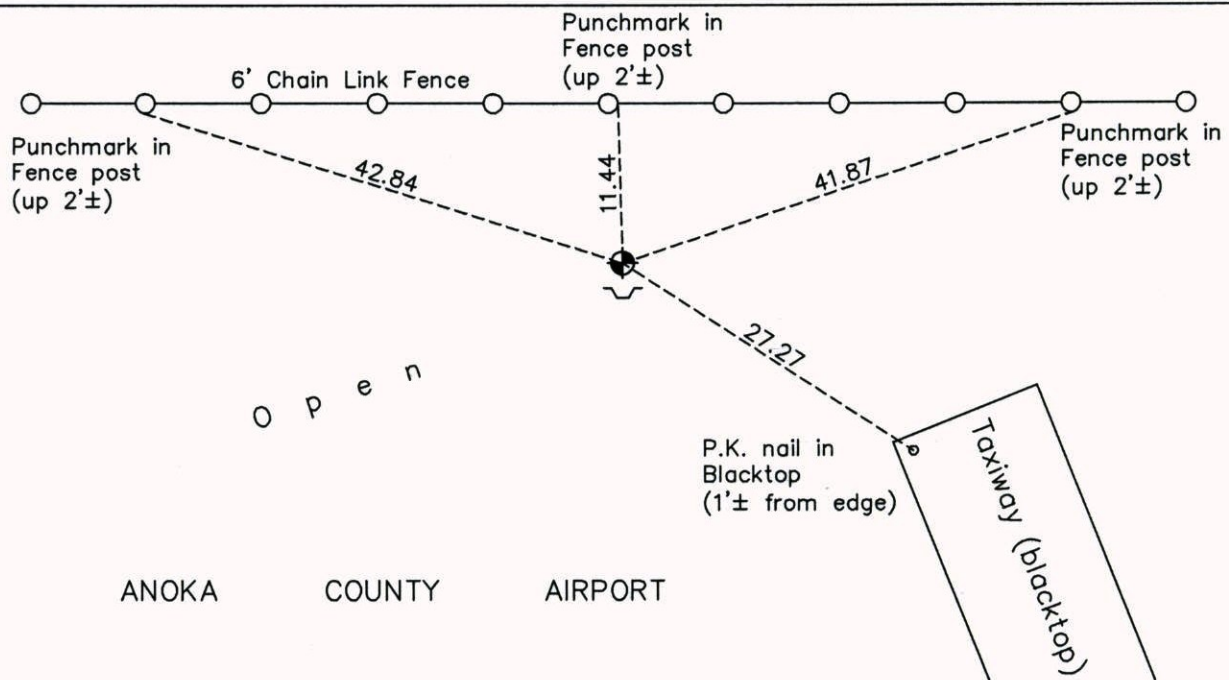

ANOKA COUNTY AIRPORT



Revision Date

2/23/15

N.A.D. 1983 Coordinates
(1996 Adjustment)

County Project Coordinates	
Northing	143112.2195
Easting	513409.0901
Date	8/26/99

I hereby certify that this United States public land survey monument record is correct and complete to the best of my knowledge and belief.

Larry D. Hoium Date 2/23/15

Larry D. Hoium, Anoka County Surveyor

Minnesota License Number 18165