

# CERTIFICATE OF LOCATION OF GOVERNMENT CORNER

County of Anoka

State of Minnesota

## West 1/4 Corner of Sec. 26 Township 31 Range 23

On the 6th day of November, 1961, the described corner was evidenced by a concrete monument

and to perpetuate the location of said corner, at the exact location thereof, a permanent marker was placed consisting of a cast iron monument

AND on the 3rd day of July, 2014, said permanent marker was found and the ties were updated. CIM is in 10th parking stall from west end of row and 1'± north of center stripe.

Updated reference ties are as shown below.

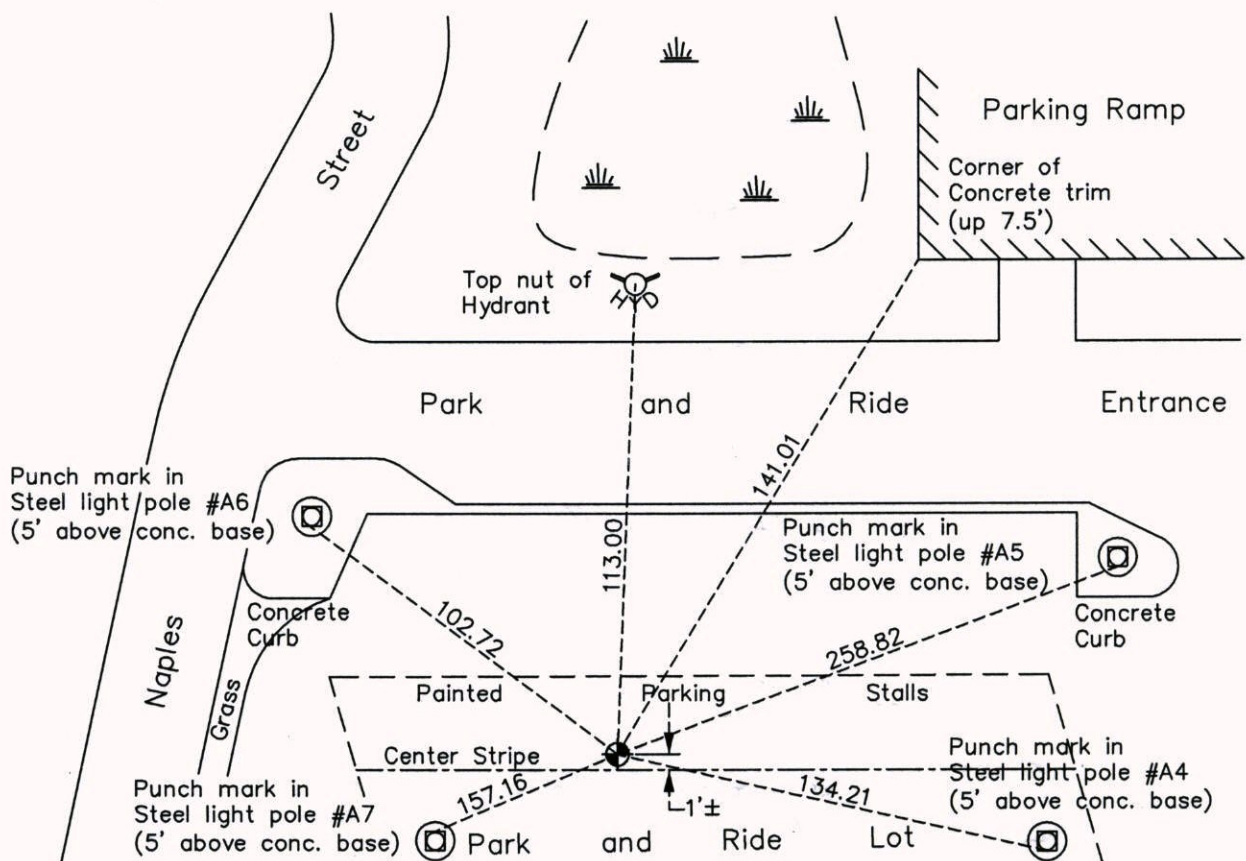

Revision Date  
2/24/15

N.A.D. 1983 Coordinates  
(1996 Adjustment)

County Project Coordinates	
Northing	140413.8312
Easting	521298.2554
Date	10/27/98

I hereby certify that this United States public land survey monument record is correct and complete to the best of my knowledge and belief.

*Larry D. Hoium*      Date 2/24/15

Larry D. Hoium, Anoka County Surveyor

Minnesota License Number 18165