

# CERTIFICATE OF LOCATION OF GOVERNMENT CORNER

County of Anoka

State of Minnesota

## East 1/4 Corner of Sec. 25 Township 31 Range 23

On the 20th day of January, 1978, the described corner was evidenced by area resurvey

and to perpetuate the location of said corner, at the exact location thereof, a permanent marker was placed consisting of a red and white 2" square steel Telspar monument up 5'± with a sign attached facing south

AND on the 29th day of July, 2014, said permanent marker was found and the ties were updated

Updated reference ties are as shown below.

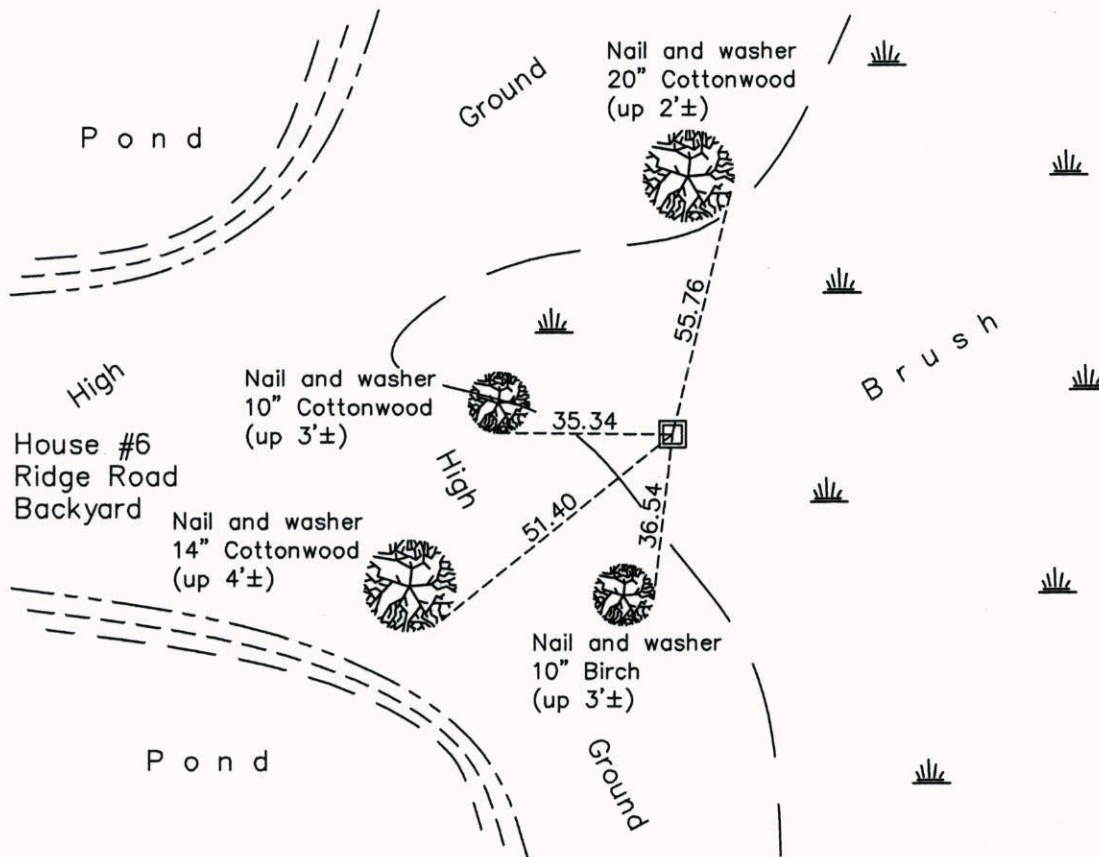

Revision Date

2/25/15

N.A.D. 1983 Coordinates  
(1996 Adjustment)

County Project Coordinates	
Northing	140280.1955
Easting	531898.1441
Date	6/25/98

I hereby certify that this United States public land survey monument record is correct and complete to the best of my knowledge and belief.

*Larry D. Hoium* Date 2/25/15

Larry D. Hoium, Anoka County Surveyor

Minnesota License Number 18165