

# CERTIFICATE OF LOCATION OF GOVERNMENT CORNER

County of Anoka

State of Minnesota

## East 1/4 Corner of Sec. 31 Township 31 Range 23

On the 21st day of June, 1960, the described corner was evidenced by a concrete monument

and to perpetuate the location of said corner, at the exact location thereof, a permanent marker was placed consisting of a cast iron monument

AND on the 18th day of June, 2014, said permanent marker was found and the ties were updated

Updated reference ties are as shown below.

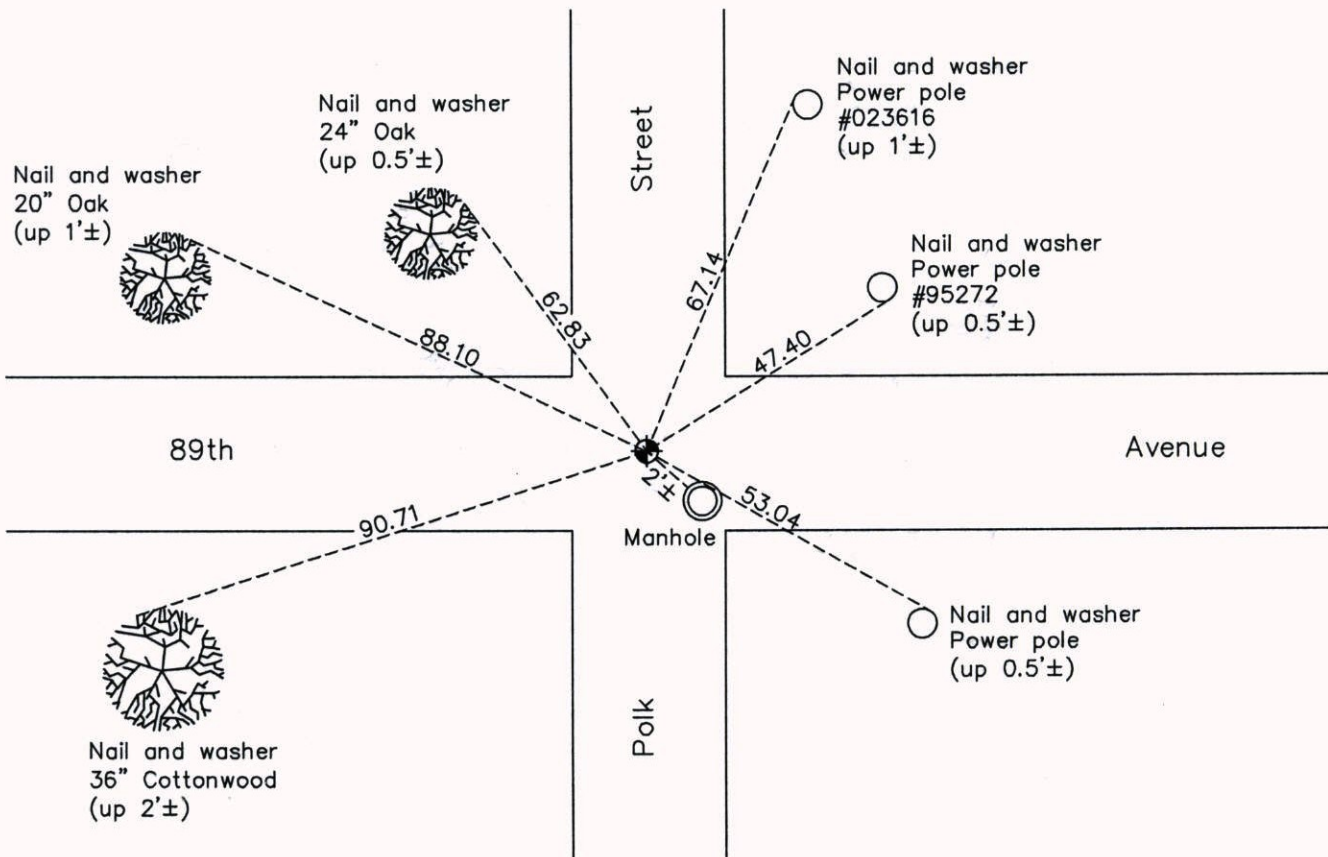

Revision Date  
3/04/15

N.A.D. 1983 Coordinates  
(1996 Adjustment)

County Project Coordinates	
Northing	135204.9207
Easting	505411.3751
Date	12/10/98

I hereby certify that this United States public land survey monument record is correct and complete to the best of my knowledge and belief.

*Larry D. Hoium* Date 3/04/15

Larry D. Hoium, Anoka County Surveyor

Minnesota License Number 18165