

# CERTIFICATE OF LOCATION OF GOVERNMENT CORNER

County of Anoka

State of Minnesota

## East 1/4 Corner of Sec. 35 Township 31 Range 23

On the 23rd day of October, 1961, the described corner was evidenced by a concrete monument

and to perpetuate the location of said corner, at the exact location thereof, a permanent marker was placed consisting of a cast iron monument

AND on the 26th day of June, 2014, said permanent marker was found broken. Replaced with a new cast iron monument and updated ties on July 9, 2014.

Updated reference ties are as shown below.

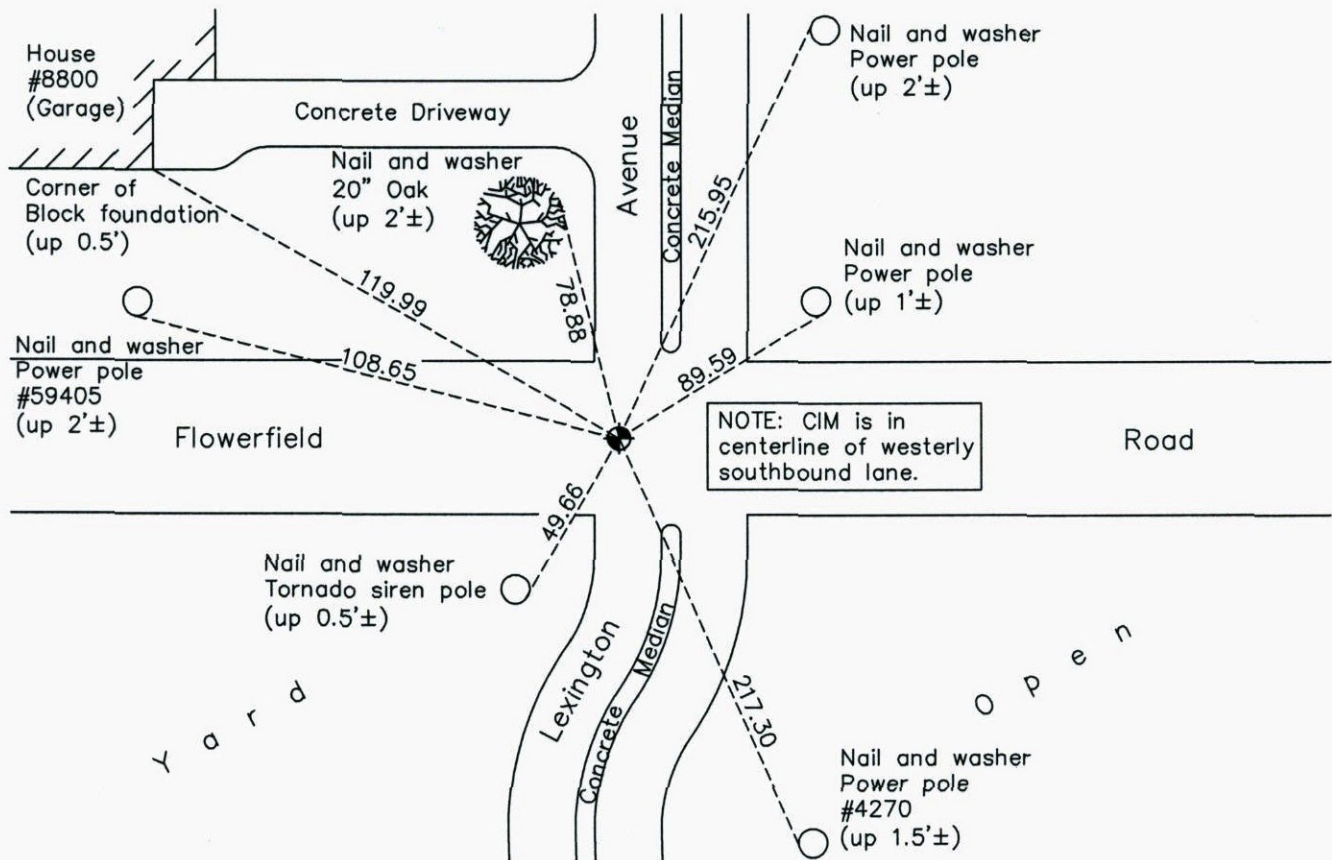

NOTE: CIM is in centerline of westerly southbound lane.

N  
W ANOKA COUNTY SURVEYOR E  
S

Revision Date  
10/03/14

N.A.D. 1983 Coordinates  
(1996 Adjustment)

County Project Coordinates	
Northing	<u>135116.1362</u>
Easting	<u>526570.1101</u>
Date	<u>10/19/98</u>

I hereby certify that this United States public land survey monument record is correct and complete to the best of my knowledge and belief.

*Larry D. Hoium* Date 10/03/14

Larry D. Hoium, Anoka County Surveyor  
Minnesota License Number 18165