

CERTIFICATE OF LOCATION OF GOVERNMENT CORNER

County of Anoka

State of Minnesota

North $\frac{1}{4}$ Corner of Sec. 5 Township 30 Range 23 (RAMSEY COUNTY MONUMENT)

On the 27th day of October, 1964, the described corner was evidenced by a 6" square granite monument

and to perpetuate the location of said corner, at the exact location thereof, a permanent marker was placed consisting of a cast iron monument (Correction Monument 1995)

AND on the 14th day of July, 2014, said permanent marker was found down 0.5'± in a covered tube and the ties were updated

Updated reference ties are as shown below.

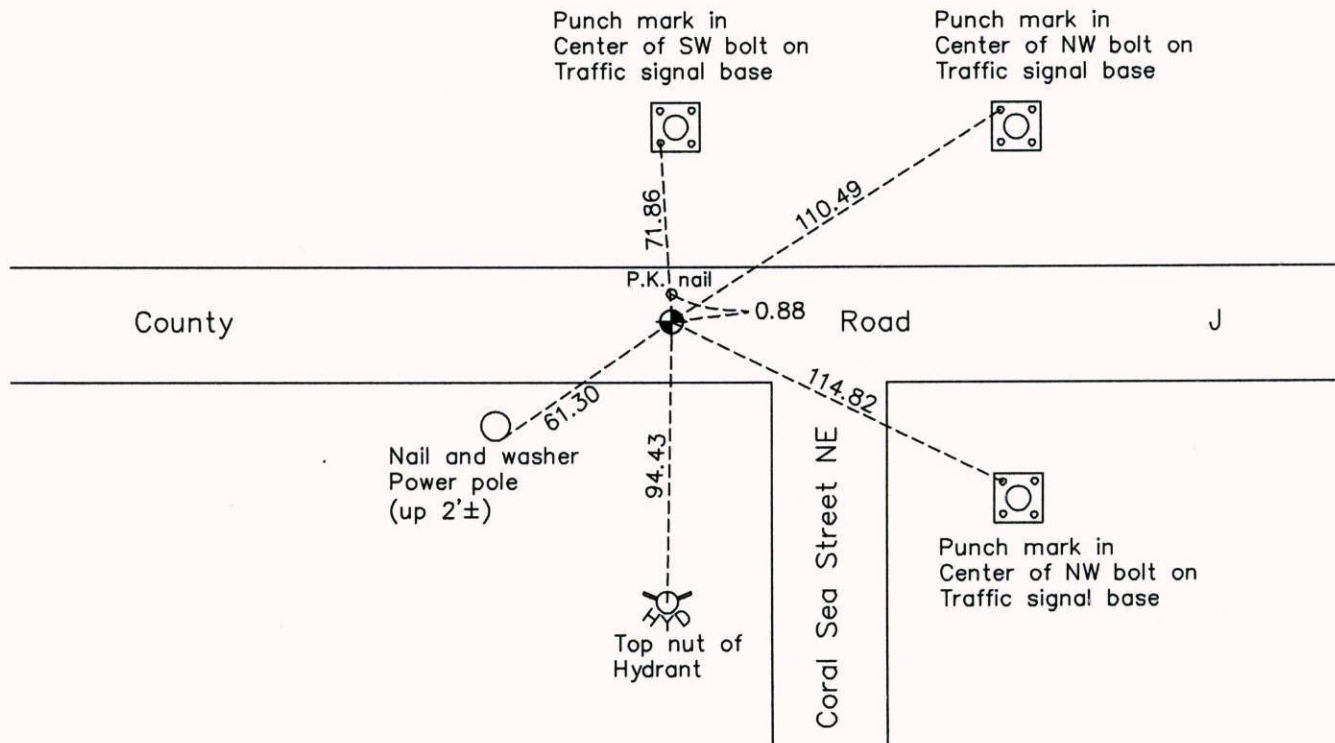

Revision Date

3/09/15

N.A.D. 1983 Coordinates
(1996 Adjustment)

County Project Coordinates	
Northing	<u>132500.1027</u>
Easting	<u>517472.7557</u>
Date	<u>8/03/99</u>

I hereby certify that this United States public land survey monument record is correct and complete to the best of my knowledge and belief.

Larry D. Hoium Date 3/09/15

Larry D. Hoium, Anoka County Surveyor

Minnesota License Number 18165