

CERTIFICATE OF LOCATION OF GOVERNMENT CORNER

County of Anoka

State of Minnesota

Northeast Corner of Sec. 4 Township 32 Range 22

On the 15th day of March, 1977, the described corner was evidenced by a concrete monument

and to perpetuate the location of said corner, at the exact location thereof, a permanent marker was placed consisting of a 2" iron pipe

AND on the 12th day of December, 2014, said permanent marker was found up 4.5'± and the ties were updated

Updated reference ties are as shown below.

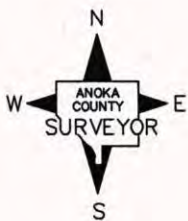
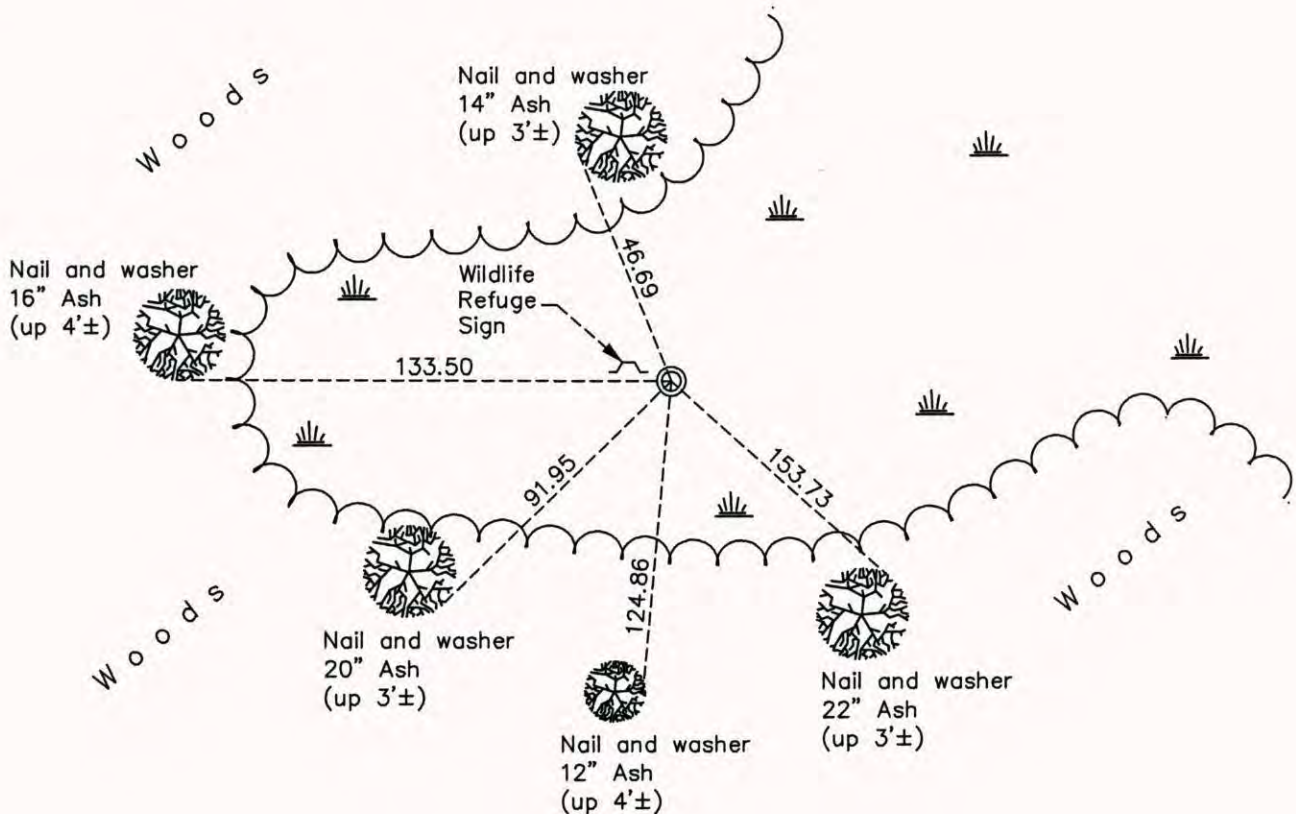

Revision Date
4/24/15

N.A.D. 1983 Coordinates
(1996 Adjustment)

County Project Coordinates	
Northing	<u>195520.8614</u>
Easting	<u>547834.4900</u>
Date	<u>5/03/05</u>

I hereby certify that this United States public land survey monument record is correct and complete to the best of my knowledge and belief.

Larry D. Hoium Date 4/24/15

Larry D. Hoium, Anoka County Surveyor

Minnesota License Number 18165