

# CERTIFICATE OF LOCATION OF GOVERNMENT CORNER

County of Anoka

State of Minnesota

## South 1/4 Corner of Sec. 1 Township 32 Range 22

On the 27th day of December, 1968, the described corner was evidenced by a 3/4" iron pipe

and to perpetuate the location of said corner, at the exact location thereof, a permanent marker was placed consisting of a cast iron monument with a sign and post on the north side

AND on the 8th day of October, 2014, said permanent marker was found up 0.2'± and the ties were updated

Updated reference ties are as shown below.

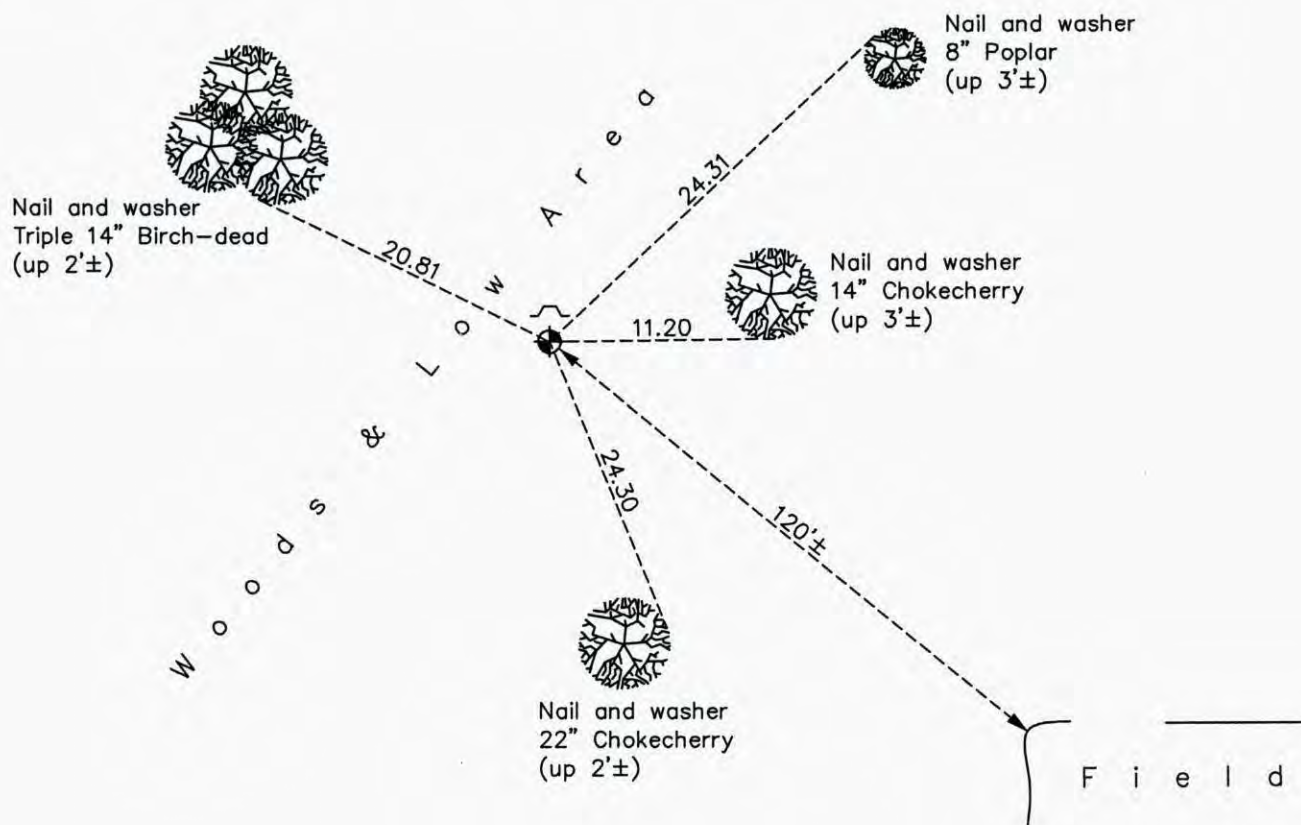

Revision Date  
5/07/15

N.A.D. 1983 Coordinates  
(1996 Adjustment)

County Project Coordinates	
Northing	<u>190383.3310</u>
Easting	<u>561008.8283</u>
Date	<u>4/20/05</u>

I hereby certify that this United States public land survey monument record is correct and complete to the best of my knowledge and belief.

*Larry D. Hoium* Date 5/07/15

Larry D. Hoium, Anoka County Surveyor

Minnesota License Number 18165