

CERTIFICATE OF LOCATION OF GOVERNMENT CORNER

County of Anoka

State of Minnesota

West 1/4 Corner of Sec. 9 Township 32 Range 22

On the 24th day of November, 1976, the described corner was evidenced by a concrete monument

and to perpetuate the location of said corner, at the exact location thereof, a permanent marker was placed consisting of the same concrete monument

AND on the 3rd day of December, 2014, said permanent marker was found up 0.5'± with a sign and post on the north side and the ties were updated

Updated reference ties are as shown below.

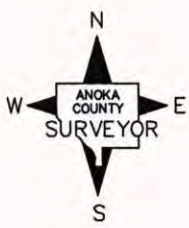
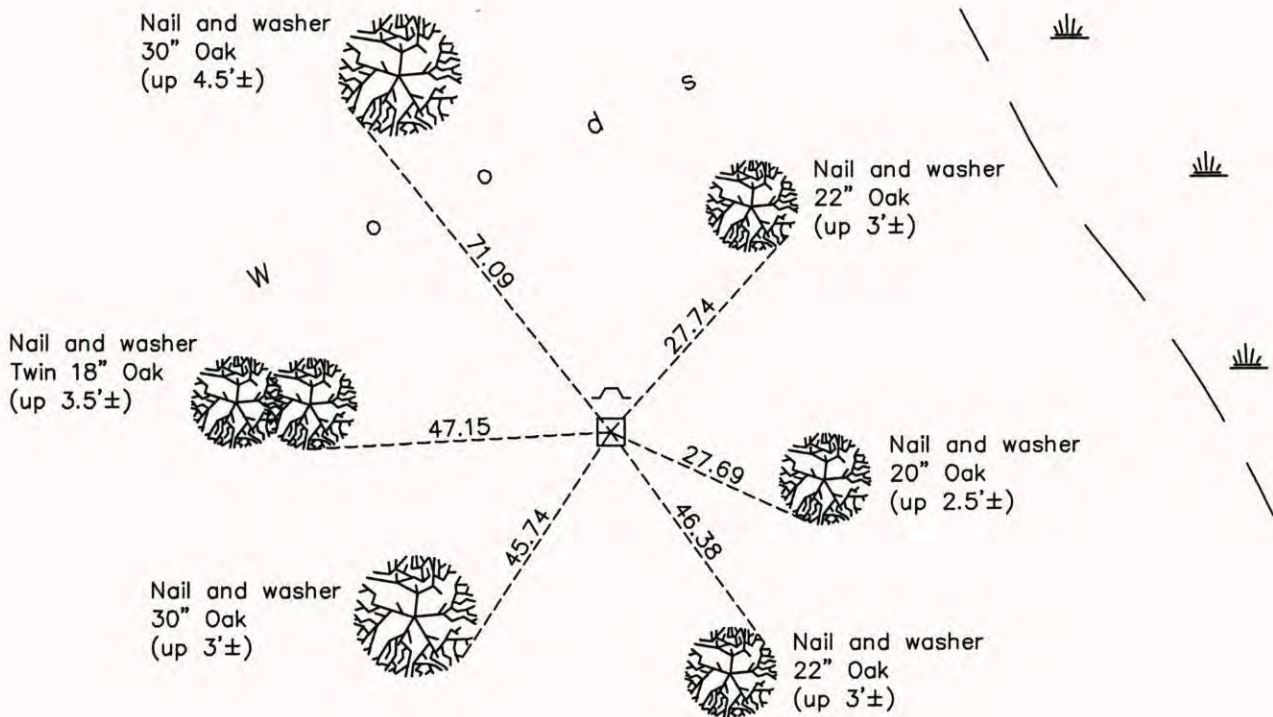

Revision Date
5/12/15

N.A.D. 1983 Coordinates
(1996 Adjustment)

County Project Coordinates	
Northing	187836.3103
Easting	542700.7214
Date	2/21/06

I hereby certify that this United States public land survey monument record is correct and complete to the best of my knowledge and belief.

Larry D. Hoium Date 5/12/15

Larry D. Hoium, Anoka County Surveyor

Minnesota License Number 18165