

CERTIFICATE OF LOCATION OF GOVERNMENT CORNER

County of Anoka

State of Minnesota

Northeast Corner of Sec. 23 Township 32 Range 22

On the 20th day of June, 1963, the described corner was evidenced by area property surveys

and to perpetuate the location of said corner, at the exact location thereof, a permanent marker was placed consisting of a cast iron monument with a sign and post on the north side

AND on the 14th day of October, 2014, said permanent marker was found down 0.4'± and the ties were updated

Updated reference ties are as shown below.

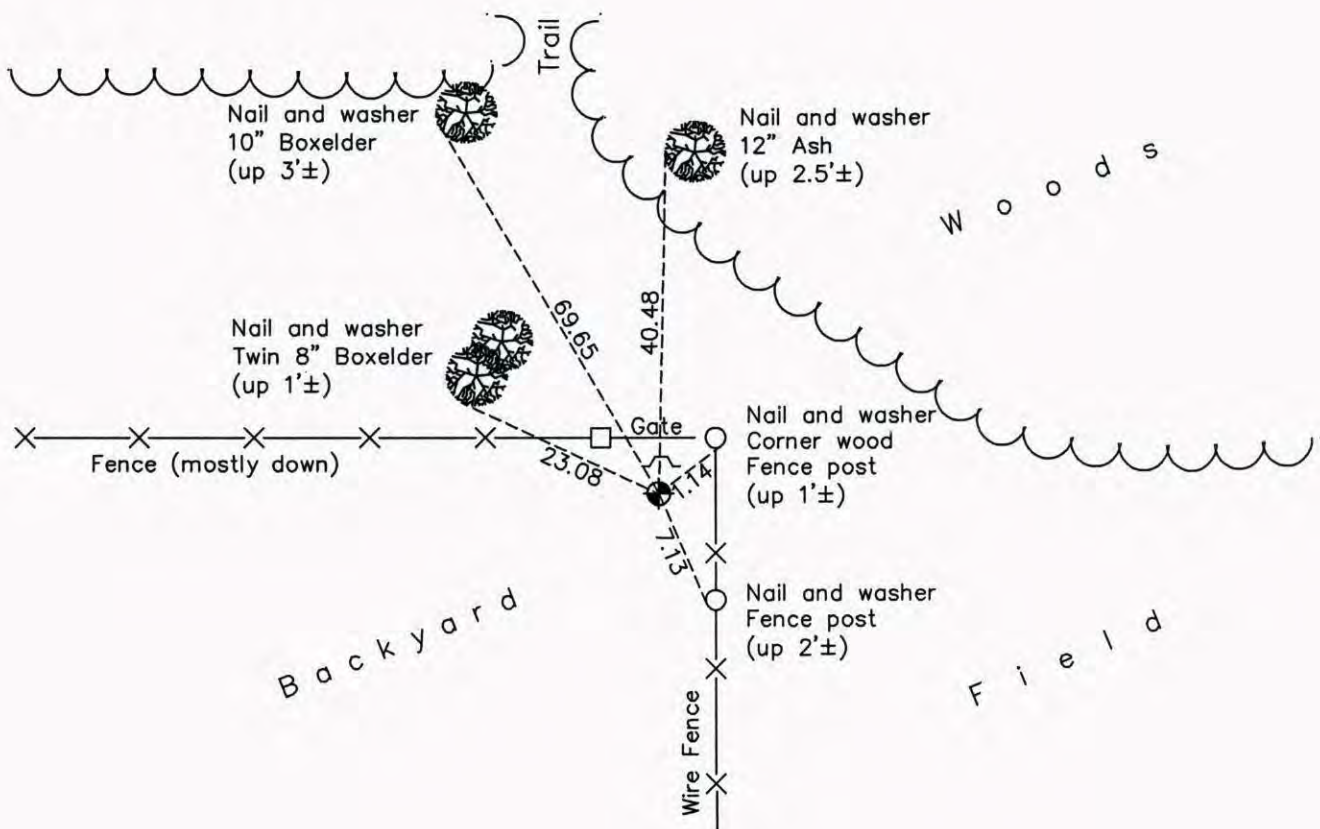

Revision Date

6/16/15

N.A.D. 1983 Coordinates
(1996 Adjustment)

County Project Coordinates	
Northing	179865.7704
Easting	558482.7084
Date	5/18/04

I hereby certify that this United States public land survey monument record is correct and complete to the best of my knowledge and belief.

Larry D. Hoium Date 6/16/15

Larry D. Hoium, Anoka County Surveyor

Minnesota License Number 18165