

CERTIFICATE OF LOCATION OF GOVERNMENT CORNER

County of Anoka

State of Minnesota

Witness Corner of Sec. 14 Township 32 Range 22

(on east line of SE 1/4)

On the 20th day of February, 1979, the described corner was evidenced by area resurvey

and to perpetuate the location of said corner, at the exact location thereof, a permanent marker was placed consisting of a red and white 2" square steel Telespar monument

AND on the 14th day of October, 2014, said permanent marker was found up 5'± with a sign attached facing south and the ties were updated

Updated reference ties are as shown below.

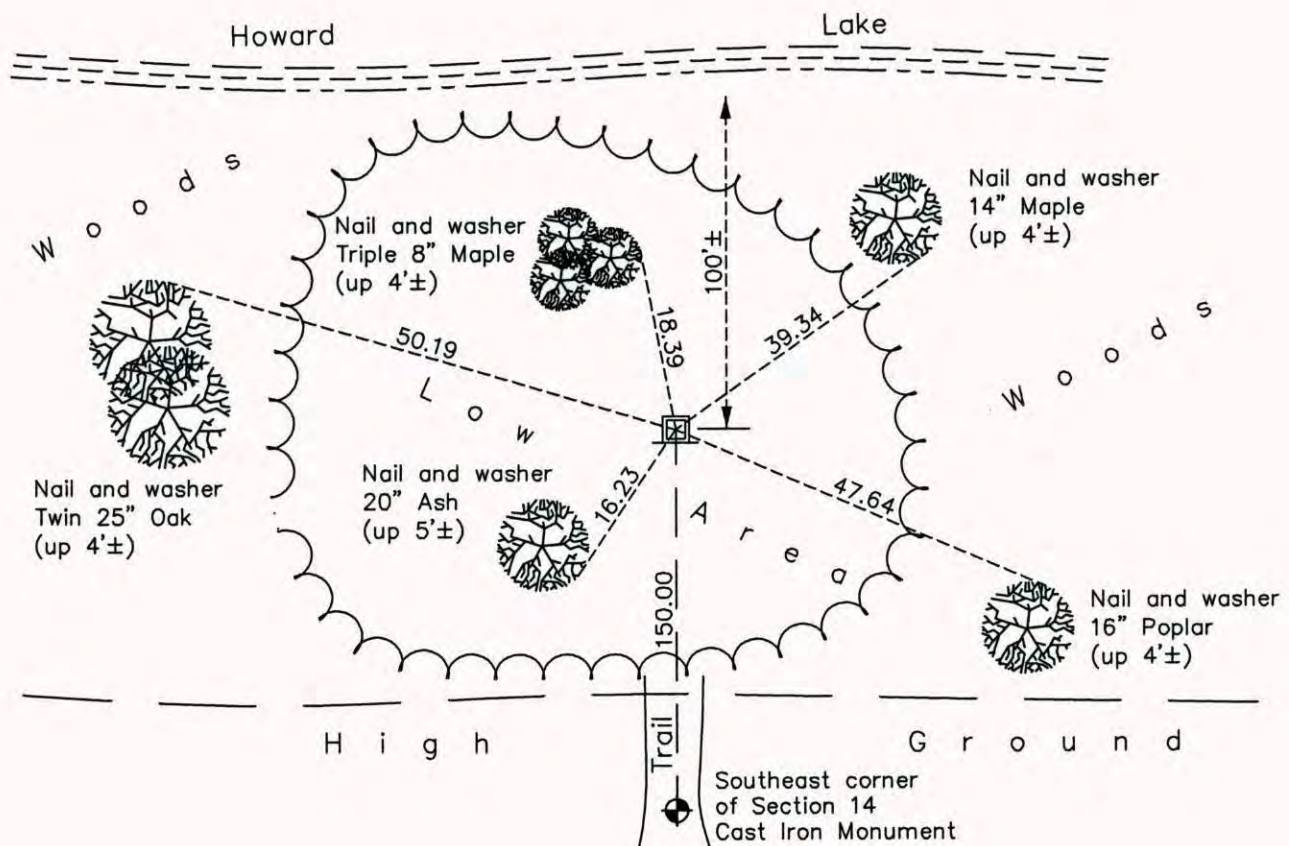

N
W ANOKA COUNTY SURVEYOR E
S

Revision Date
6/22/15

N.A.D. 1983 Coordinates
(1996 Adjustment)

County Project Coordinates	
Northing	180015.5497
Easting	558480.3422
Date	1/18/06

I hereby certify that this United States public land survey monument record is correct and complete to the best of my knowledge and belief.

Larry D. Hoium Date 6/22/15

Larry D. Hoium, Anoka County Surveyor
Minnesota License Number 18165