

CERTIFICATE OF LOCATION OF GOVERNMENT CORNER

County of Anoka

State of Minnesota

North 1/4 Corner of Sec. 36 Township 32 Range 22

On the 2nd day of July, 1974, the described corner was evidenced by area resurvey

and to perpetuate the location of said corner, at the exact location thereof, a permanent marker was placed consisting of a cast iron monument

AND on the 24th day of September, 2014, said permanent marker was found. Was unable to update ties or verify coordinates with GPS due to RV's around monument.

Updated reference ties are as shown below.

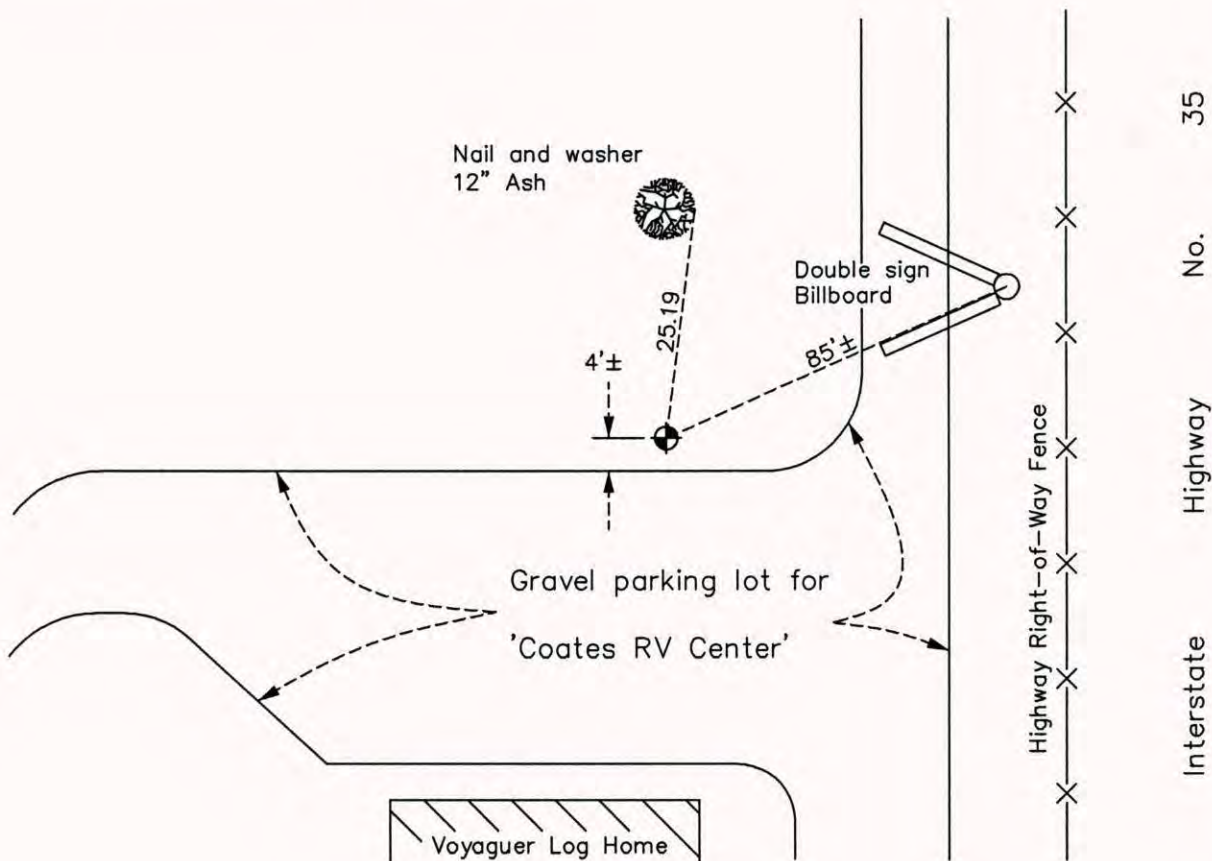

Revision Date

7/17/15

N.A.D. 1983 Coordinates
(1996 Adjustment)

County Project Coordinates

Northing 169372.3434

Easting 561046.7650

Date 5/25/04

I hereby certify that this United States public land survey monument record is correct and complete to the best of my knowledge and belief.

Larry D. Hoium Date 7/17/15

Larry D. Hoium, Anoka County Surveyor

Minnesota License Number 18165