

CERTIFICATE OF LOCATION OF GOVERNMENT CORNER

County of Anoka

State of Minnesota

Northwest Corner of Sec. 33 Township 32 Range 22

On the 21st day of April, 1966, the described corner was evidenced by area resurvey

and to perpetuate the location of said corner, at the exact location thereof, a permanent marker was placed consisting of a cast iron monument down 1'±

AND on the 11th day of September, 2014, said permanent marker was found down 1.5'± and the ties were updated

Updated reference ties are as shown below.

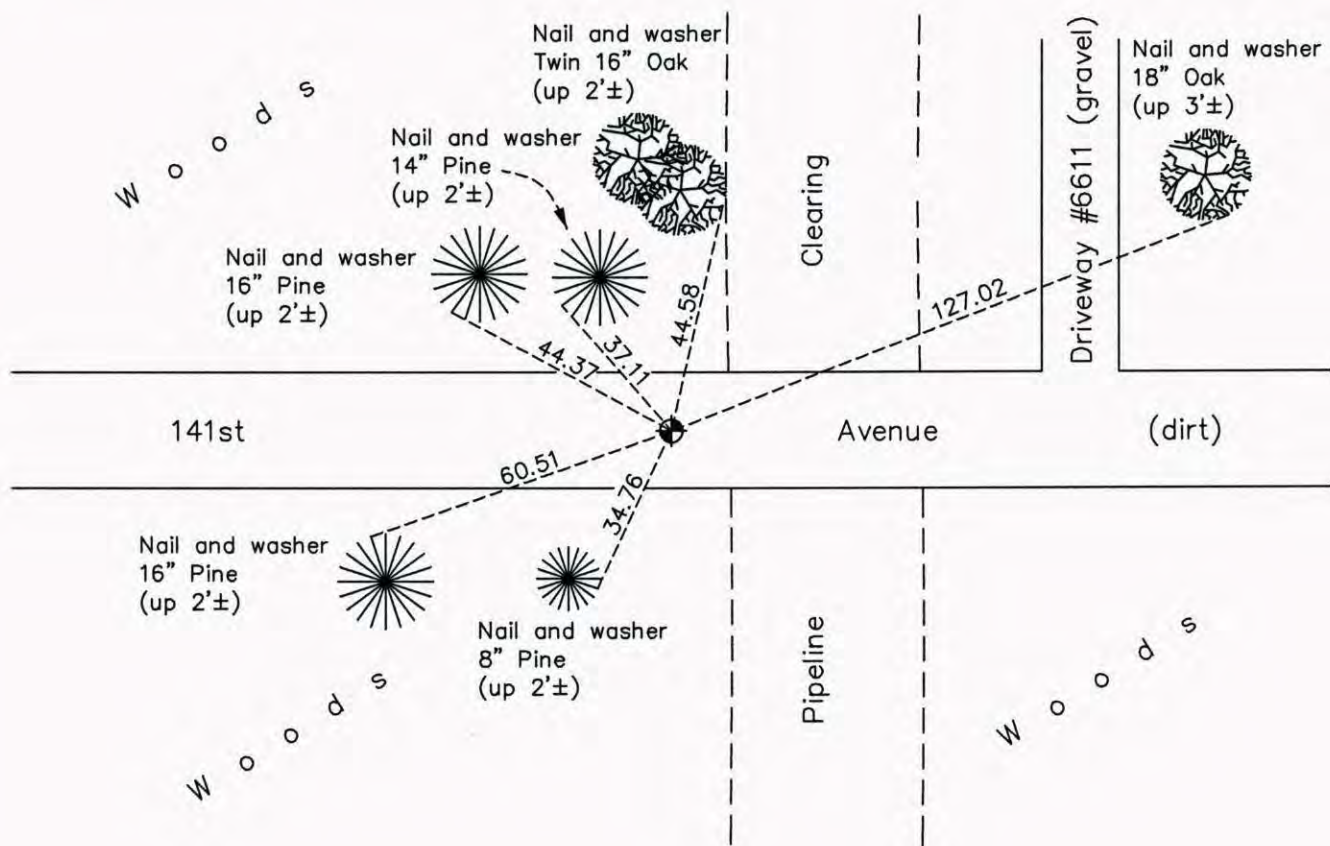

ANOKA COUNTY SURVEYOR

Revision Date

7/22/15

N.A.D. 1983 Coordinates
(1996 Adjustment)

County Project Coordinates	
Northing	169384.8522
Easting	542675.4098
Date	6/24/03

I hereby certify that this United States public land survey monument record is correct and complete to the best of my knowledge and belief.

Larry D. Hoium Date 7/22/15

Larry D. Hoium, Anoka County Surveyor

Minnesota License Number 18165