

CERTIFICATE OF LOCATION OF GOVERNMENT CORNER

County of Anoka

State of Minnesota

North $\frac{1}{4}$ Corner of Sec. 31 Township 32 Range 22

On the 7th day of February, 1961, the described corner was evidenced by a concrete monument

and to perpetuate the location of said corner, at the exact location thereof, a permanent marker was placed consisting of a red and white 2" iron pipe

AND on the 9th day of March, 2015, said permanent marker was found up 3'± and leaning westerly 0.5'±. The ties were updated.

Updated reference ties are as shown below.

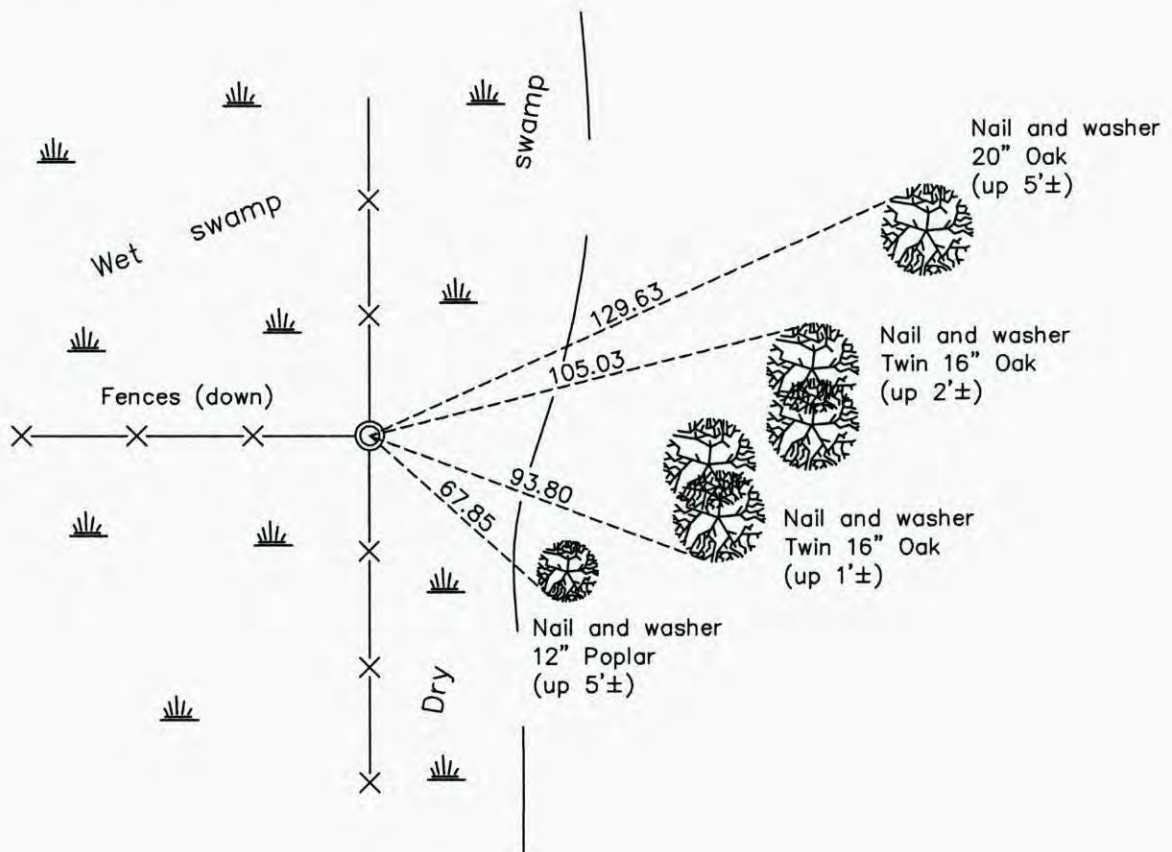

Revision Date

7/22/15

N.A.D. 1983 Coordinates
(1996 Adjustment)

County Project Coordinates	
Northing	<u>169377.3096</u>
Easting	<u>534784.2193</u>
Date	<u>2/22/06</u>

I hereby certify that this United States public land survey monument record is correct and complete to the best of my knowledge and belief.

Larry D. Hoium Date 7/22/15

Larry D. Hoium, Anoka County Surveyor

Minnesota License Number 18165