

# CERTIFICATE OF LOCATION OF GOVERNMENT CORNER

County of Anoka

State of Minnesota

## Northeast Corner of Sec. 1 Township 33 Range 22

On the 12th day of April, 1962, the described corner was evidenced by a 8" square granite monument

and to perpetuate the location of said corner, at the exact location thereof, a permanent marker was placed consisting of the same granite monument ('33-22-S1' is etched on top)

AND on the 18th day of February, 2014, said permanent marker was found up 0.6'± and leaning northeasterly. The ties were updated.

Updated reference ties are as shown below.

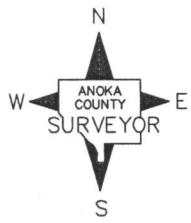
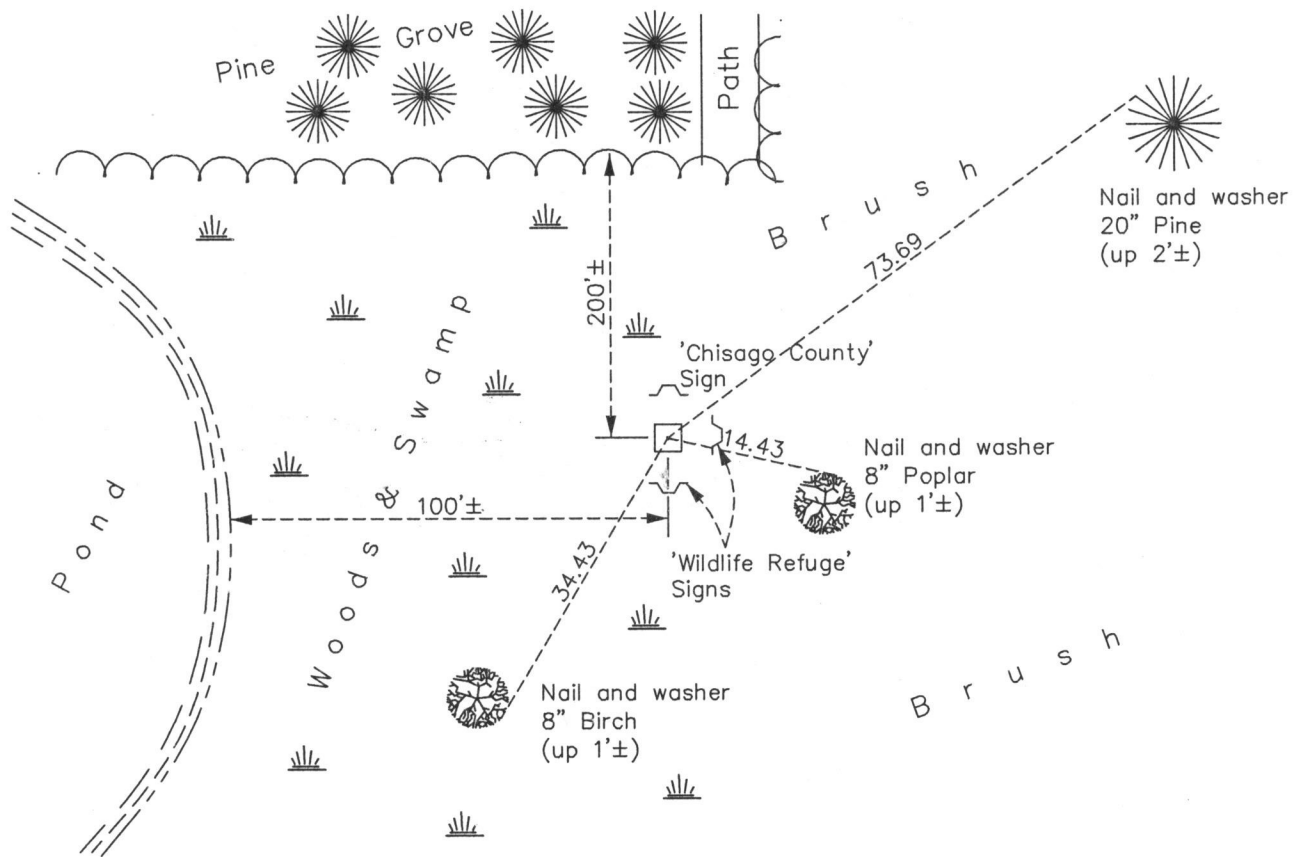

Revision Date

8/06/15

N.A.D. 1983 Coordinates  
(1996 Adjustment)

County Project Coordinates	
Northing	<u>226769.6950</u>
Easting	<u>563765.7250</u>
Date	<u>4/08/04</u>

I hereby certify that this United States public land survey monument record is correct and complete to the best of my knowledge and belief.

*Larry D. Hoium* Date 8/06/15

Larry D. Hoium, Anoka County Surveyor

Minnesota License Number 18165