

# CERTIFICATE OF LOCATION OF GOVERNMENT CORNER

County of Anoka

State of Minnesota

## North 1/4 Corner of Sec. 5 Township 33 Range 22

On the 4th day of March, 1973, the described corner was evidenced by area resurvey

and to perpetuate the location of said corner, at the exact location thereof, a permanent marker was placed consisting of a red and white iron pipe

AND on the 31st day of December, 2013, said permanent marker was found up 3'± and leaning NW'ly. All ties were gone with no features to tie to. Position was verified using VRS GPS methods.

Updated reference ties are as shown below.

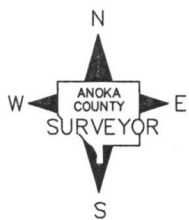
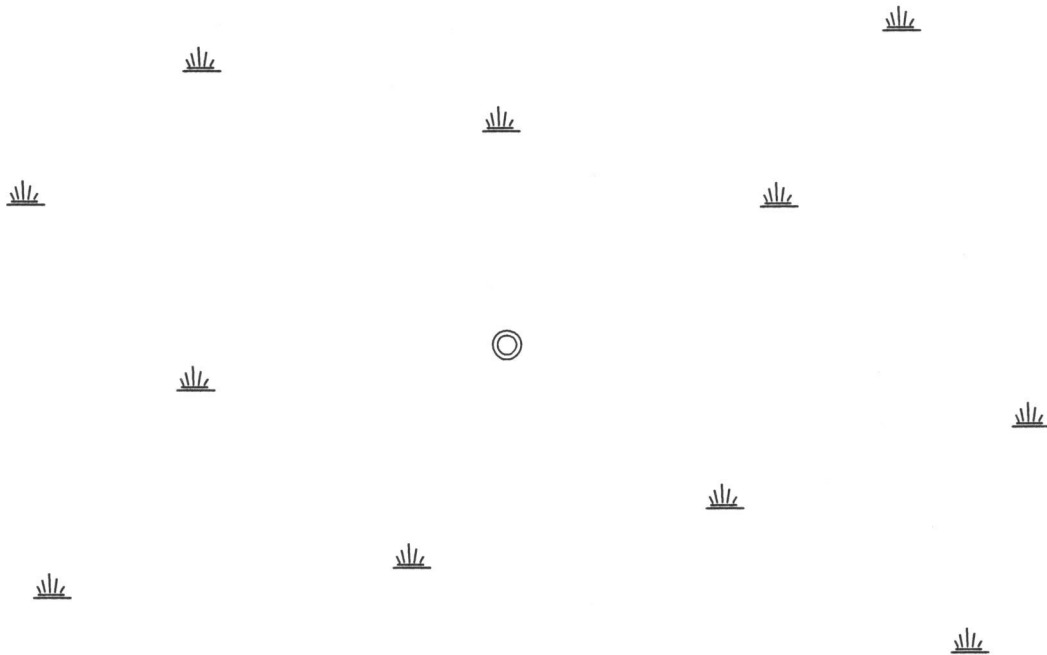

Revision Date

8/13/15

N.A.D. 1983 Coordinates  
(1996 Adjustment)

County Project Coordinates	
Northing	<u>227467.1323</u>
Easting	<u>540104.1508</u>
Date	<u>4/19/04</u>

I hereby certify that this United States public land survey monument record is correct and complete to the best of my knowledge and belief.

*Larry D. Hoium* Date 8/13/15

Larry D. Hoium, Anoka County Surveyor

Minnesota License Number 18165