

CERTIFICATE OF LOCATION OF GOVERNMENT CORNER

County of Anoka

State of Minnesota

South 1/4 Corner of Sec. 6 Township 33 Range 22

On the 27th day of March, 1974, the described corner was evidenced by area resurvey

and to perpetuate the location of said corner, at the exact location thereof, a permanent marker was placed consisting of a red and white iron pipe

AND on the 17th day of December, 2013, said permanent marker was found up 3'± with a sign attached facing east and the ties were updated

Updated reference ties are as shown below.

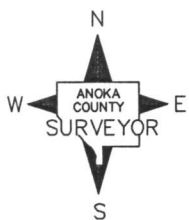
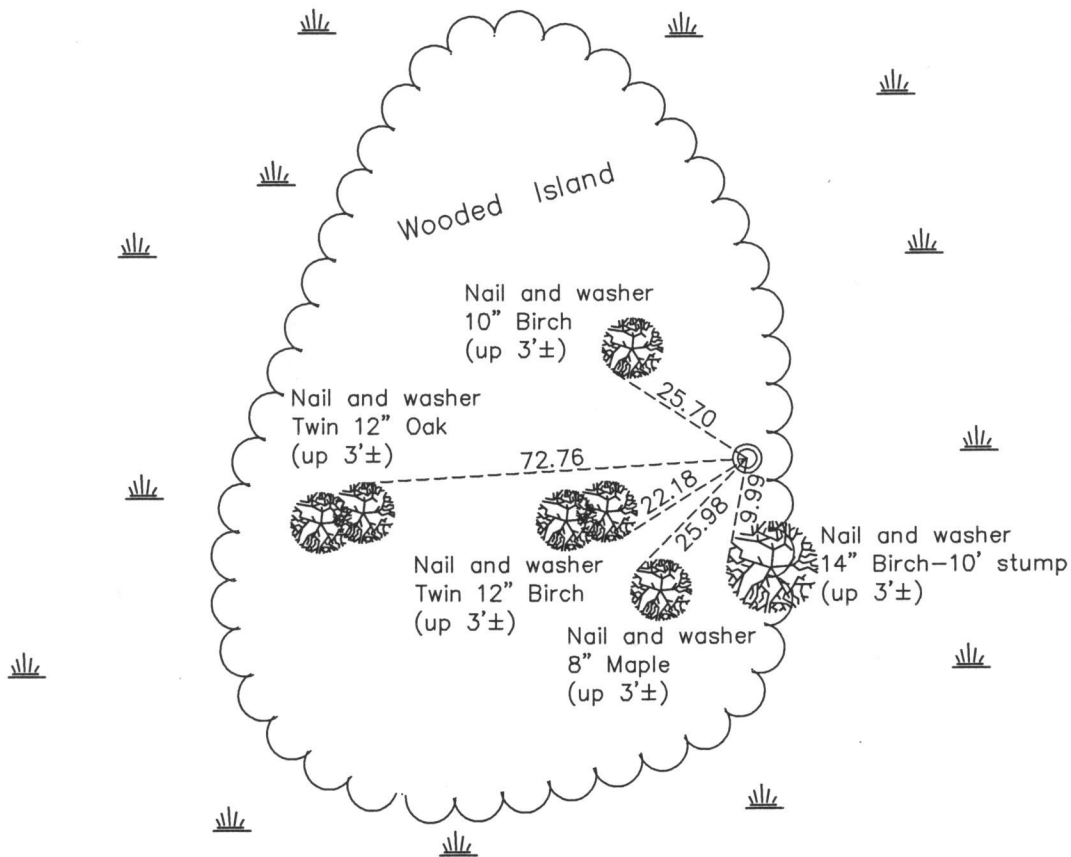

Revision Date

8/24/15

N.A.D. 1983 Coordinates
(1996 Adjustment)

County Project Coordinates	
Northing	222024.2044
Easting	534247.4451
Date	3/03/05

I hereby certify that this United States public land survey monument record is correct and complete to the best of my knowledge and belief.

Larry D. Hoium Date 8/24/15

Larry D. Hoium, Anoka County Surveyor

Minnesota License Number 18165