

# CERTIFICATE OF LOCATION OF GOVERNMENT CORNER

County of Anoka

State of Minnesota

## Southeast Corner of Sec. 10 Township 33 Range 22

On the 11th day of March, 1966, the described corner was evidenced by a 4" square concrete monument

and to perpetuate the location of said corner, at the exact location thereof, a permanent marker was placed consisting of a cast iron monument

AND on the 20th day of November, 2013, said permanent marker was found up 0.2'± and the ties were updated

Updated reference ties are as shown below.

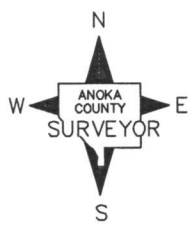
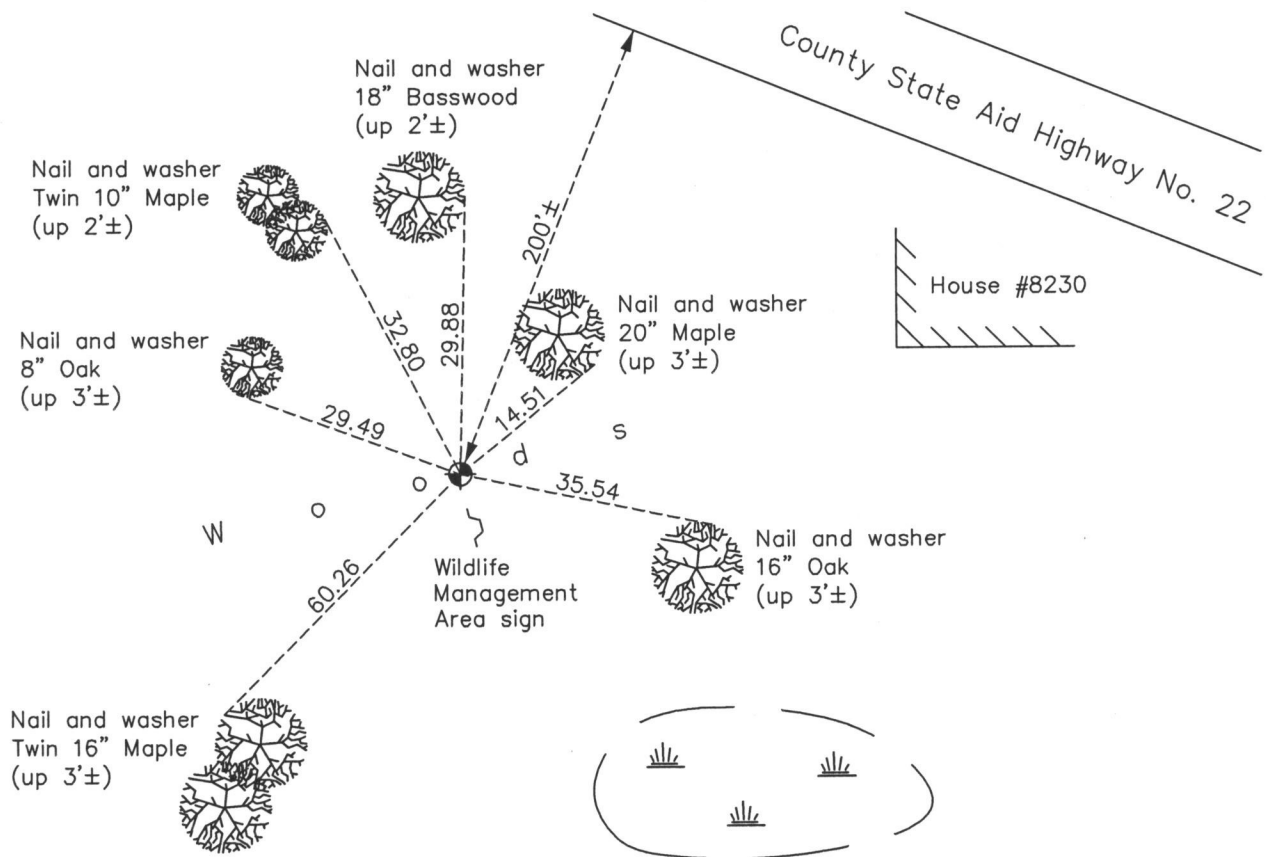

Revision Date  
8/27/15

N.A.D. 1983 Coordinates  
(1996 Adjustment)

County Project Coordinates	
Northing	<u>216780.1403</u>
Easting	<u>552898.0564</u>
Date	<u>4/07/04</u>

I hereby certify that this United States public land survey monument record is correct and complete to the best of my knowledge and belief.

*Larry D. Hoium*      Date 8/27/15

Larry D. Hoium, Anoka County Surveyor

Minnesota License Number 18165