

CERTIFICATE OF LOCATION OF GOVERNMENT CORNER

County of Anoka

State of Minnesota

East 1/4 Corner of Sec. 16 Township 33 Range 22

On the 19th day of March, 1981, the described corner was evidenced by area resurvey

and to perpetuate the location of said corner, at the exact location thereof, a permanent marker was placed consisting of a red and white iron pipe

AND on the 13th day of March, 2015, said permanent marker was found up 4'± with a sign attached to the north side of monument and slightly leaning easterly. No ties were available.

Updated reference ties are as shown below.

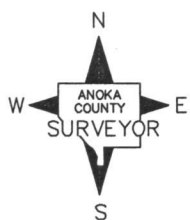
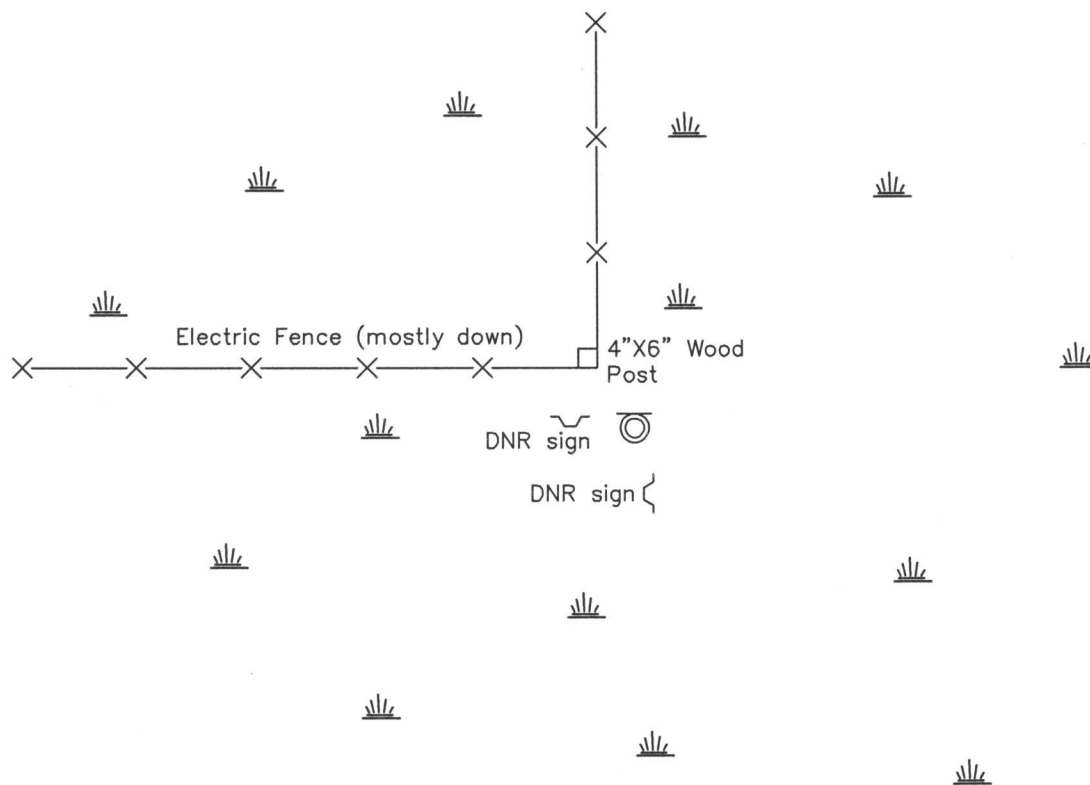

Revision Date

8/31/15

N.A.D. 1983 Coordinates
(1996 Adjustment)

County Project Coordinates

Northing 214056.2665

Easting 547480.3928

Date 3/23/05

I hereby certify that this United States public land survey monument record is correct and complete to the best of my knowledge and belief.

Larry D. Hoium Date 8/31/15

Larry D. Hoium, Anoka County Surveyor

Minnesota License Number 18165