

# CERTIFICATE OF LOCATION OF GOVERNMENT CORNER

County of Anoka

State of Minnesota

## East 1/4 Corner of Sec. 15 Township 33 Range 22

On the 25th day of February, 1972, the described corner was evidenced by a concrete monument

and to perpetuate the location of said corner, at the exact location thereof, a permanent marker was placed consisting of the same concrete monument

AND on the 12th day of March, 2015, said permanent marker was found with top 0.5'± broken off and down 0.4'± and with a sign and post on the north side. The ties were updated.

Updated reference ties are as shown below.

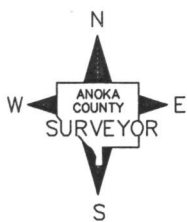
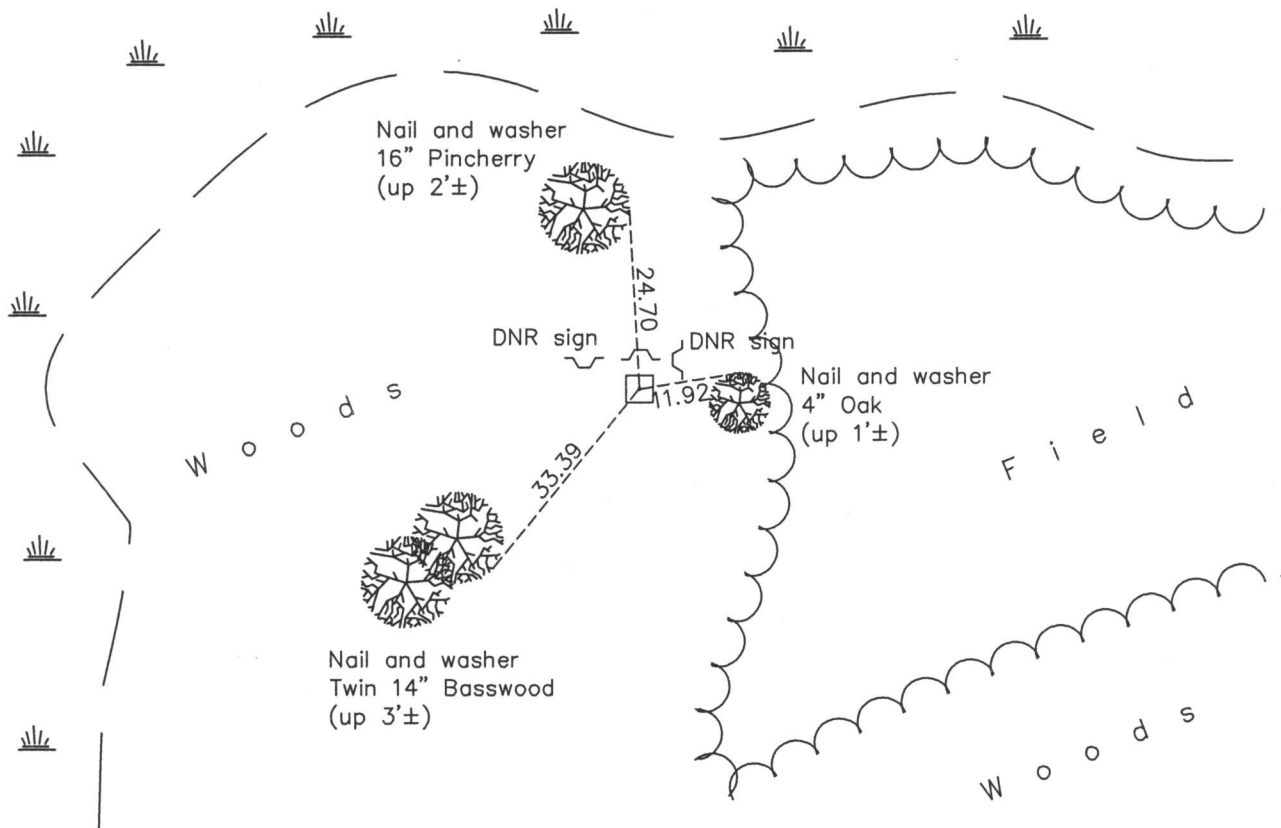

Revision Date

8/31/15

N.A.D. 1983 Coordinates  
(1996 Adjustment)

County Project Coordinates	
Northing	<u>214161.0919</u>
Easting	<u>552857.7779</u>
Date	<u>4/28/04</u>

I hereby certify that this United States public land survey monument record is correct and complete to the best of my knowledge and belief.

Date 8/31/15  
 Larry D. Hoium, Anoka County Surveyor  
 Minnesota License Number 18165