

# CERTIFICATE OF LOCATION OF GOVERNMENT CORNER

County of Anoka

State of Minnesota

## East 1/4 Corner of Sec. 13 Township 33 Range 22

On the 29th day of January, 1970, the described corner was evidenced by a granite monument

and to perpetuate the location of said corner, at the exact location thereof, a permanent marker was placed consisting of the same granite monument

AND on the 13th day of March, 2015, said permanent marker was found up 0.5'± and the ties were updated

Updated reference ties are as shown below.

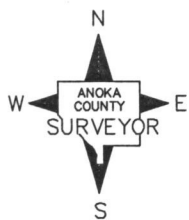
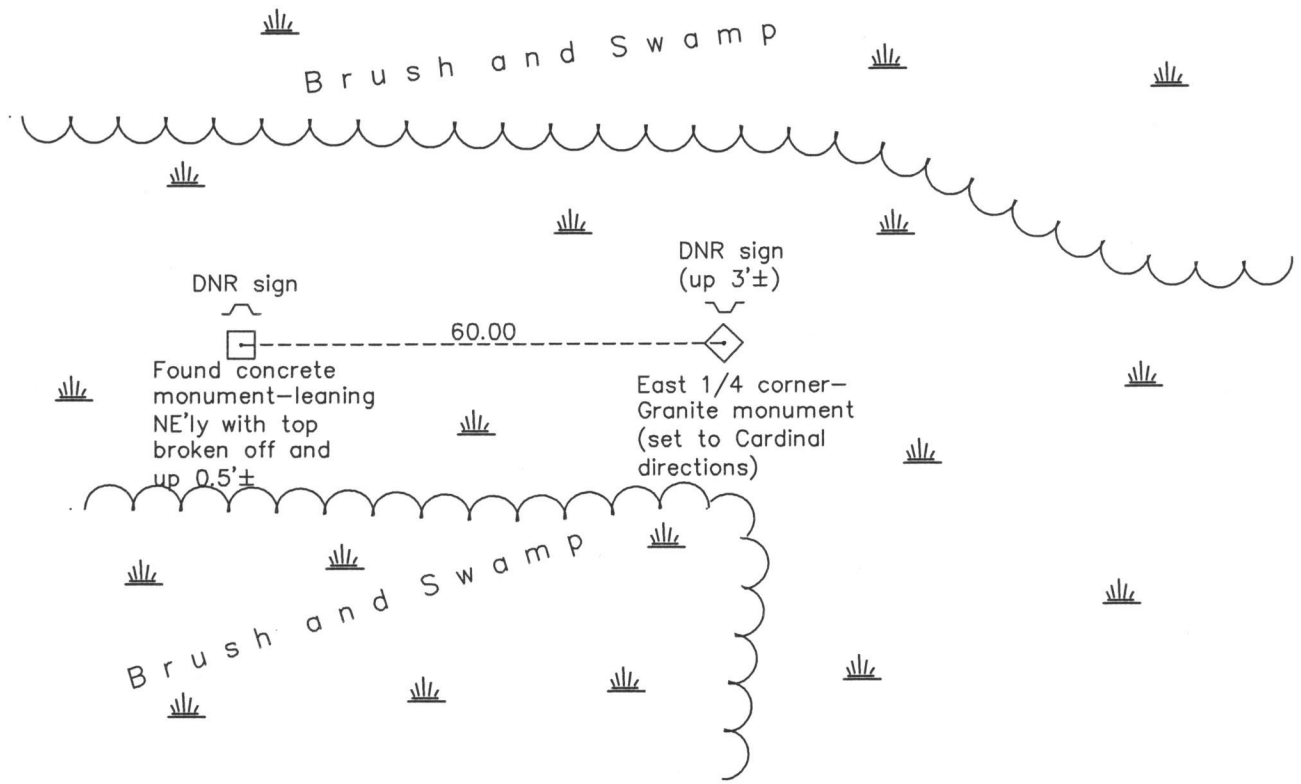

N.A.D. 1983 Coordinates  
(1996 Adjustment)

County Project Coordinates	
Northing	<u>213839.1873</u>
Easting	<u>563655.6367</u>
Date	<u>1/25/05</u>

Revision Date  
8/31/15

I hereby certify that this United States public land survey monument record is correct and complete to the best of my knowledge and belief.  
*Larry D. Hoium* Date 8/31/15  
 Larry D. Hoium, Anoka County Surveyor  
 Minnesota License Number 18165