

# CERTIFICATE OF LOCATION OF GOVERNMENT CORNER

County of Anoka

State of Minnesota

## South 1/4 Corner of Sec. 14 Township 33 Range 22

On the 31st day of March, 1980, the described corner was evidenced by area resurvey

and to perpetuate the location of said corner, at the exact location thereof, a permanent marker was placed consisting of a 1/2" iron pipe and replaced with a cast iron monument on 5/20/2004

AND on the 10th day of December, 2013, said permanent marker was found down 0.8'± and the ties were updated

Updated reference ties are as shown below.

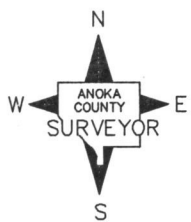
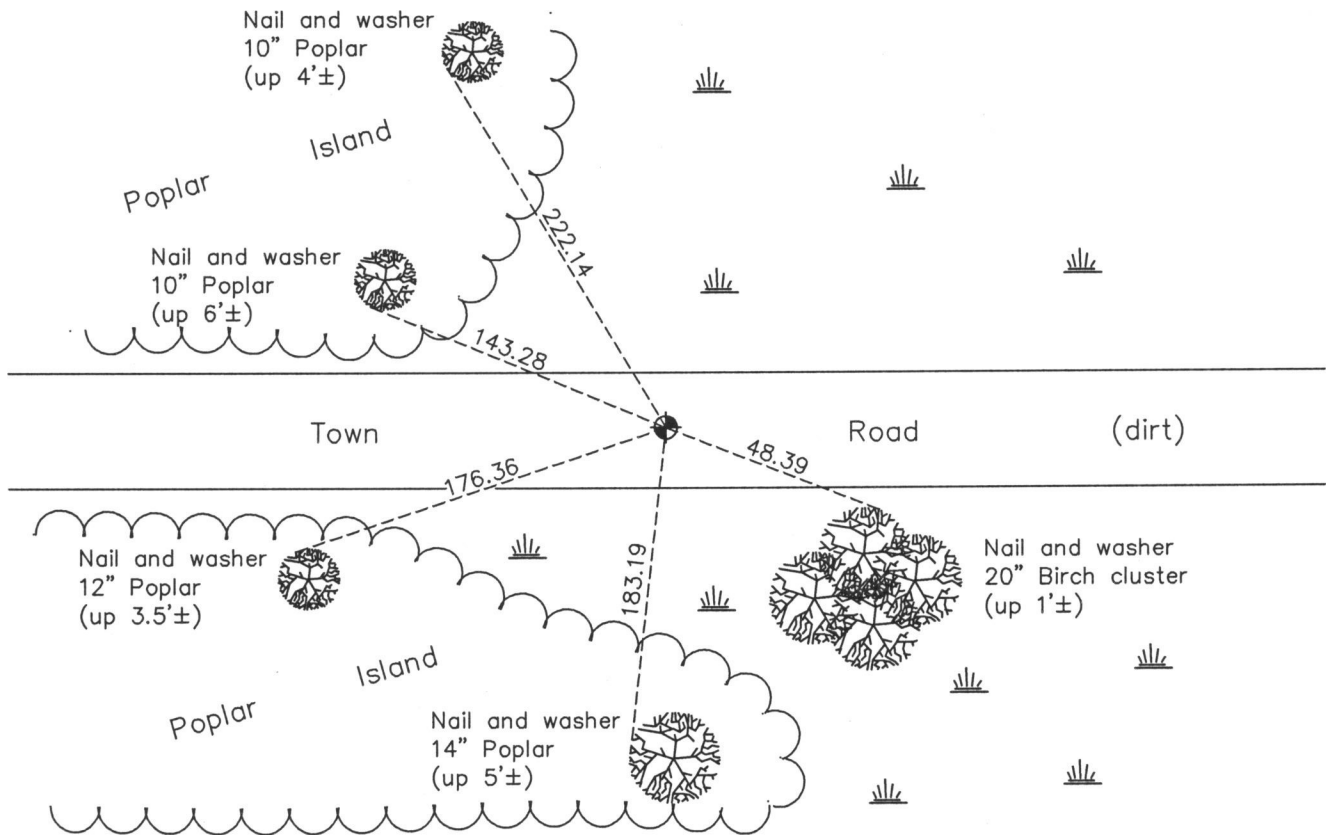

Revision Date

9/01/15

N.A.D. 1983 Coordinates  
(1996 Adjustment)

County Project Coordinates	
Northing	211457.3521
Easting	555506.1658
Date	5/20/04

I hereby certify that this United States public land survey monument record is correct and complete to the best of my knowledge and belief.

*Larry D. Hoium* Date 9/01/15

Larry D. Hoium, Anoka County Surveyor  
Minnesota License Number 18165