

CERTIFICATE OF LOCATION OF GOVERNMENT CORNER

County of Anoka

State of Minnesota

East 1/4 Corner of Sec. 24 Township 33 Range 22

On the 18th day of February, 1977, the described corner was evidenced by a granite monument

and to perpetuate the location of said corner, at the exact location thereof, a permanent marker was placed consisting of the same granite monument with a steel fence post on the north side

AND on the ___ day of April, 2014, said permanent marker was found down 0.5'± below water level with a Chisago County sign and post NW'ly of mont. and the ties were updated

Updated reference ties are as shown below.

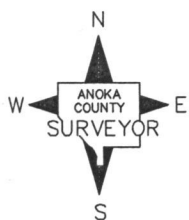
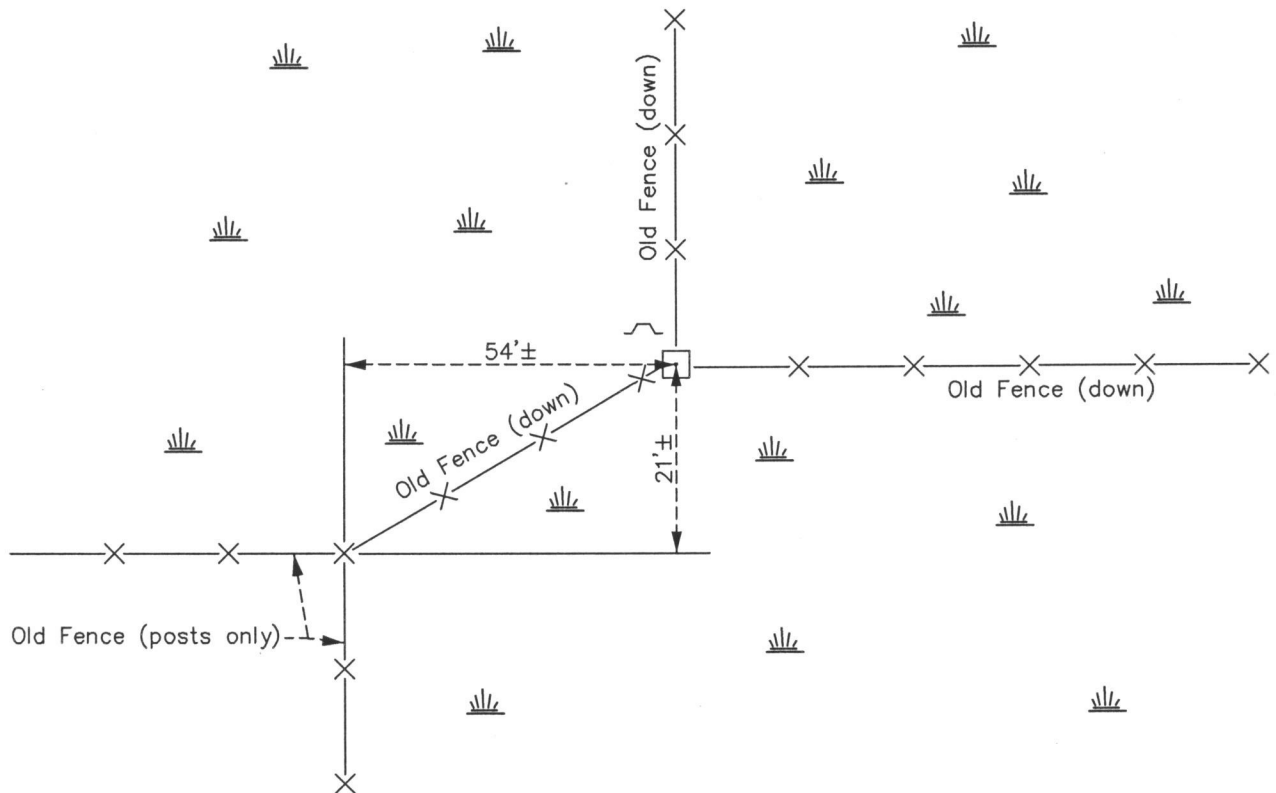

Revision Date

9/08/15

N.A.D. 1983 Coordinates
(1996 Adjustment)

County Project Coordinates	
Northing	<u>208576.0121</u>
Easting	<u>563488.2447</u>
Date	<u>1/18/05</u>

I hereby certify that this United States public land survey monument record is correct and complete to the best of my knowledge and belief.

Larry D. Hoium Date 9/08/15

Larry D. Hoium, Anoka County Surveyor

Minnesota License Number 18165