

CERTIFICATE OF LOCATION OF GOVERNMENT CORNER

County of Anoka

State of Minnesota

North 1/4 Corner of Sec. 29 Township 33 Range 22

On the 28th day of August, 1963, the described corner was evidenced by a concrete monument

and to perpetuate the location of said corner, at the exact location thereof, a permanent marker was placed consisting of the same concrete monument with a sign and post on the north side

AND on the 20th day of December, 2013, said permanent marker was found and the ties were updated

Updated reference ties are as shown below.

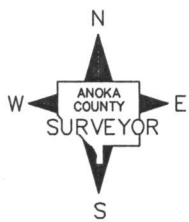
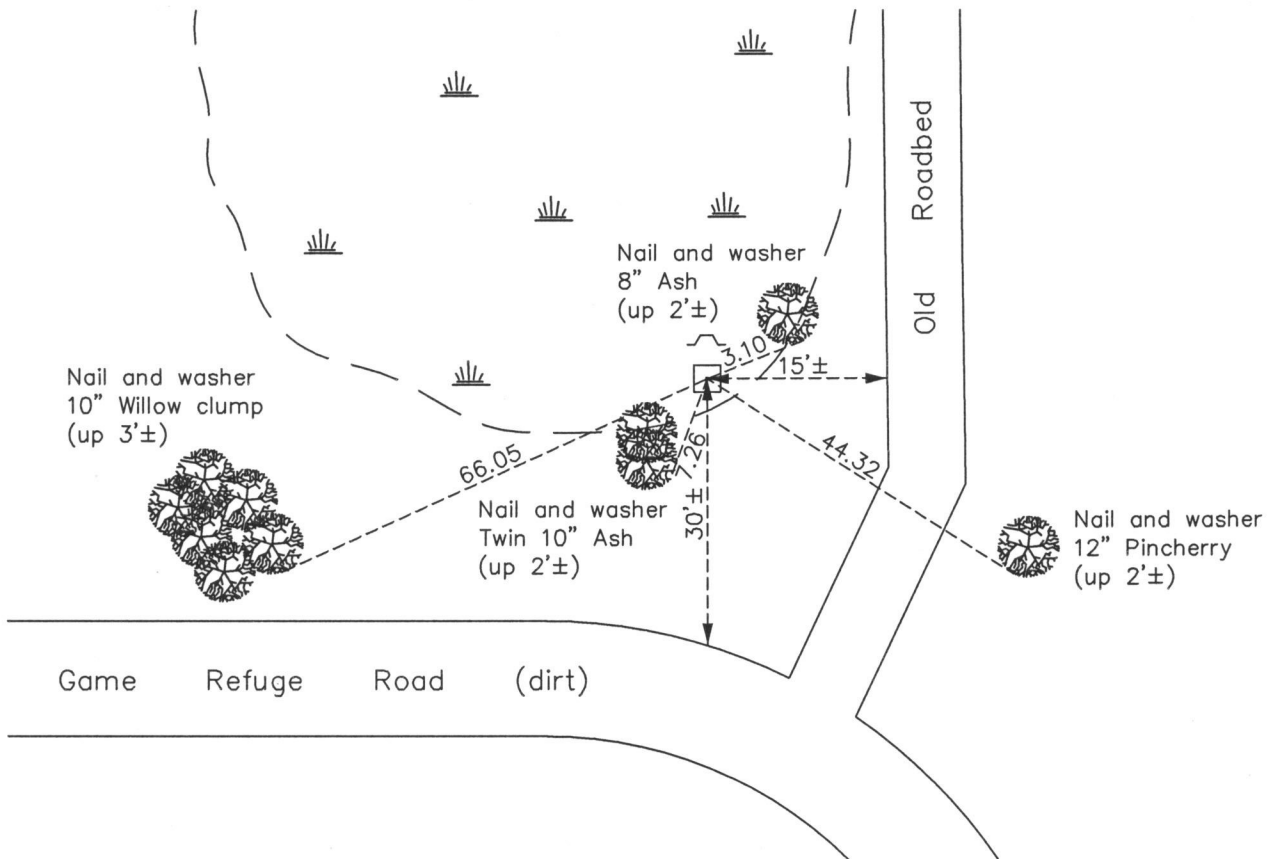

Revision Date

9/09/15

N.A.D. 1983 Coordinates
(1996 Adjustment)

| County Project Coordinates | |
|----------------------------|--------------------|
| Northing | <u>206131.4676</u> |
| Easting | <u>539570.8771</u> |
| Date | <u>5/13/04</u> |

I hereby certify that this United States public land survey monument record is correct and complete to the best of my knowledge and belief.

Date 9/09/15
 _____, Anoka County Surveyor
 Minnesota License Number 18165