

CERTIFICATE OF LOCATION OF GOVERNMENT CORNER

County of Anoka

State of Minnesota

Witness Corner of Sec. 30 Township 33 Range 22
 (on East-West 1/4 line west of E1/4 corner)

On the 16th day of April, 1973, the described corner was evidenced by area resurvey

and to perpetuate the location of said corner, at the exact location thereof, a permanent marker was placed consisting of a cast iron monument with a sign and post on the north side

AND on the 12th day of February, 2014, said permanent marker was found and the ties were updated

Updated reference ties are as shown below.

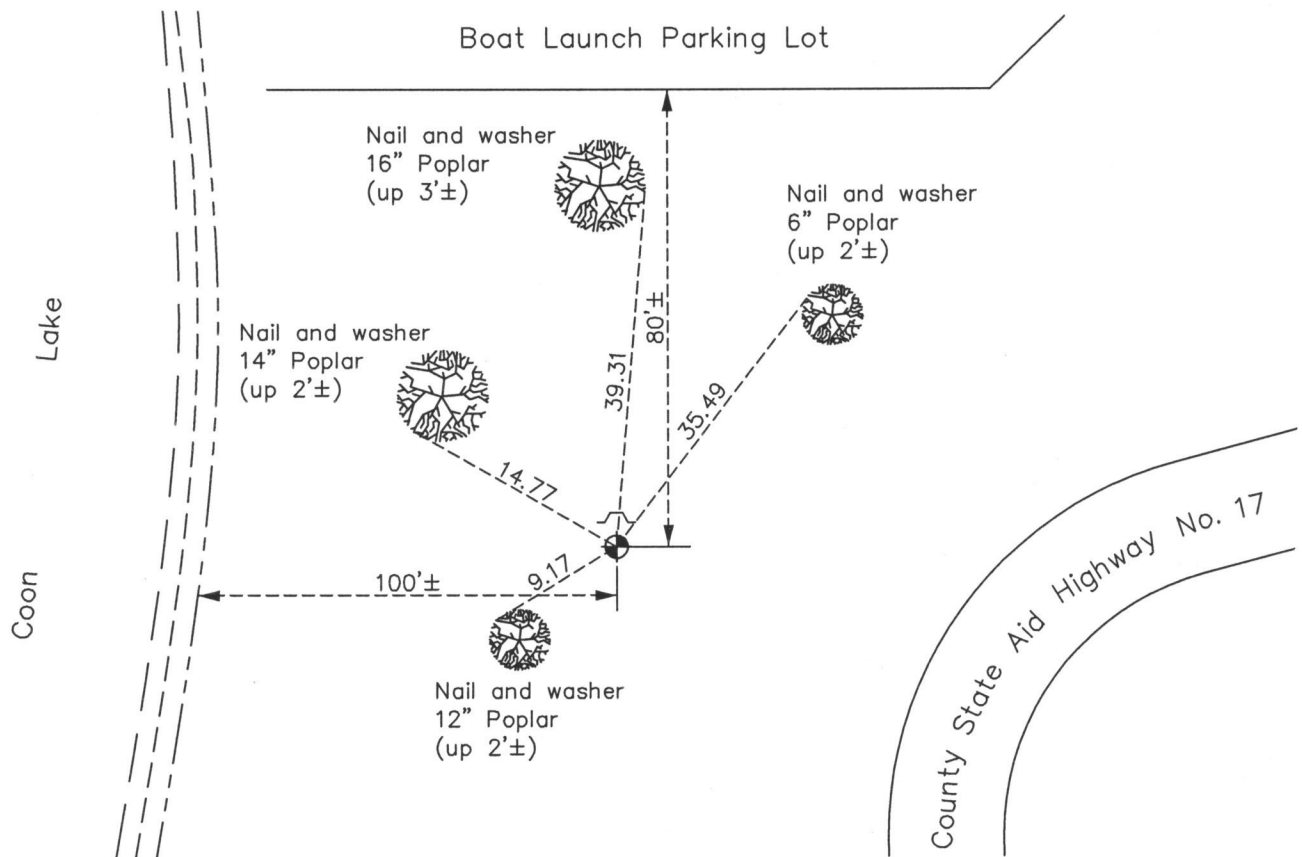

N

W ANOKA COUNTY SURVEYOR E

S

Revision Date

9/15/15

N.A.D. 1983 Coordinates
(1996 Adjustment)

| County Project Coordinates | |
|----------------------------|--------------------|
| Northing | <u>203505.4638</u> |
| Easting | <u>534726.6755</u> |
| Date | <u>5/17/04</u> |

I hereby certify that this United States public land survey monument record is correct and complete to the best of my knowledge and belief.

Larry D. Hoium Date 9/15/15

Larry D. Hoium, Anoka County Surveyor
Minnesota License Number 18165