

# CERTIFICATE OF LOCATION OF GOVERNMENT CORNER

County of Anoka

State of Minnesota

## East 1/4 Corner of Sec. 25 Township 33 Range 22

On the 22nd day of February, 1977, the described corner was evidenced by a cast iron monument

and to perpetuate the location of said corner, at the exact location thereof, a permanent marker was placed consisting of a "Chisago County" cast iron monument with a sign and post on the east side facing east

AND on the 8th day of September, 2014, said permanent marker was found Up 0.5'± and leaning slightly southwesterly. The ties were updated.

Updated reference ties are as shown below.

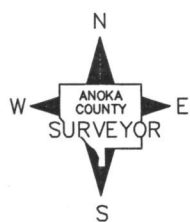
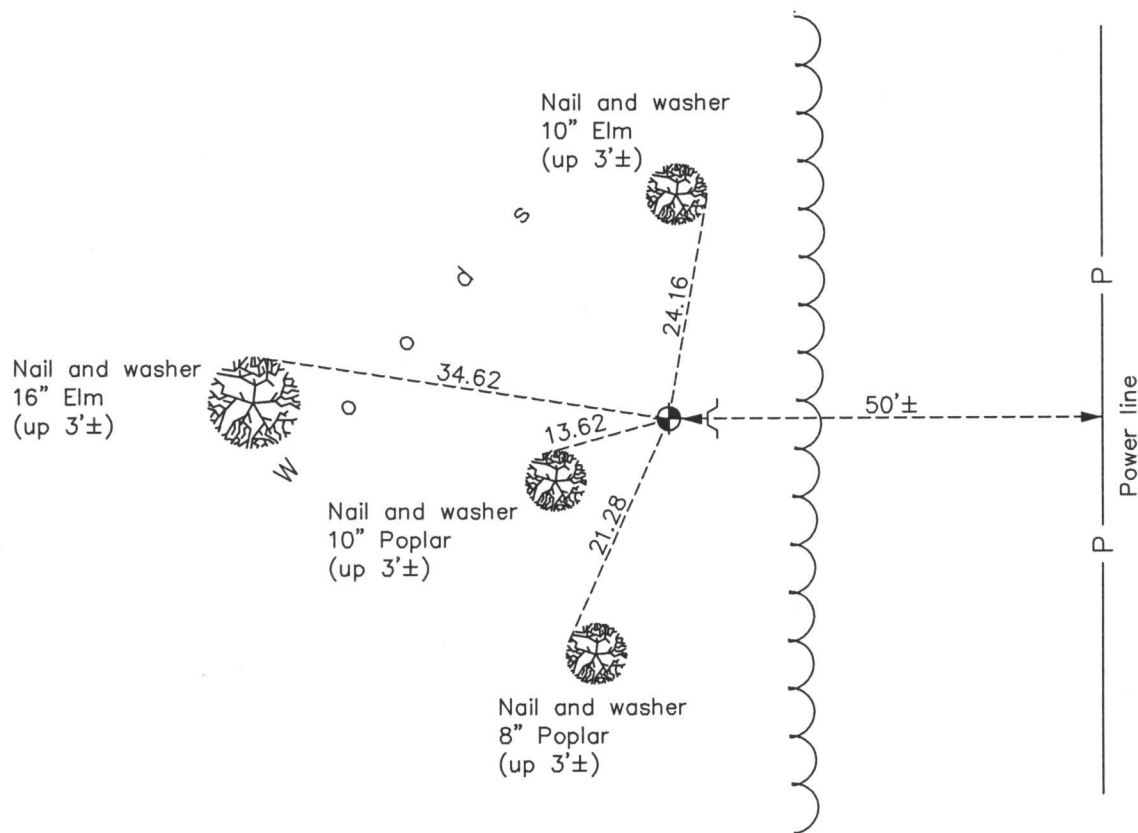

Revision Date

9/17/15

N.A.D. 1983 Coordinates  
(1996 Adjustment)

County Project Coordinates	
Northing	<u>203342.2972</u>
Easting	<u>563508.2744</u>
Date	<u>5/25/04</u>

I hereby certify that this United States public land survey monument record is correct and complete to the best of my knowledge and belief.

*Larry D. Hoium* Date 9/17/15

Larry D. Hoium, Anoka County Surveyor

Minnesota License Number 18165