

CERTIFICATE OF LOCATION OF GOVERNMENT CORNER

County of Anoka

State of Minnesota

Northwest Corner of Sec. 35 Township 33 Range 22

On the 8th day of January, 1985, the described corner was evidenced by a concrete monument with a steel post on the east side

and to perpetuate the location of said corner, at the exact location thereof, a permanent marker was placed consisting of the same concrete monument and steel post

AND on the ___ day of _____, _____, said permanent marker was _____

Updated reference ties are as shown below.

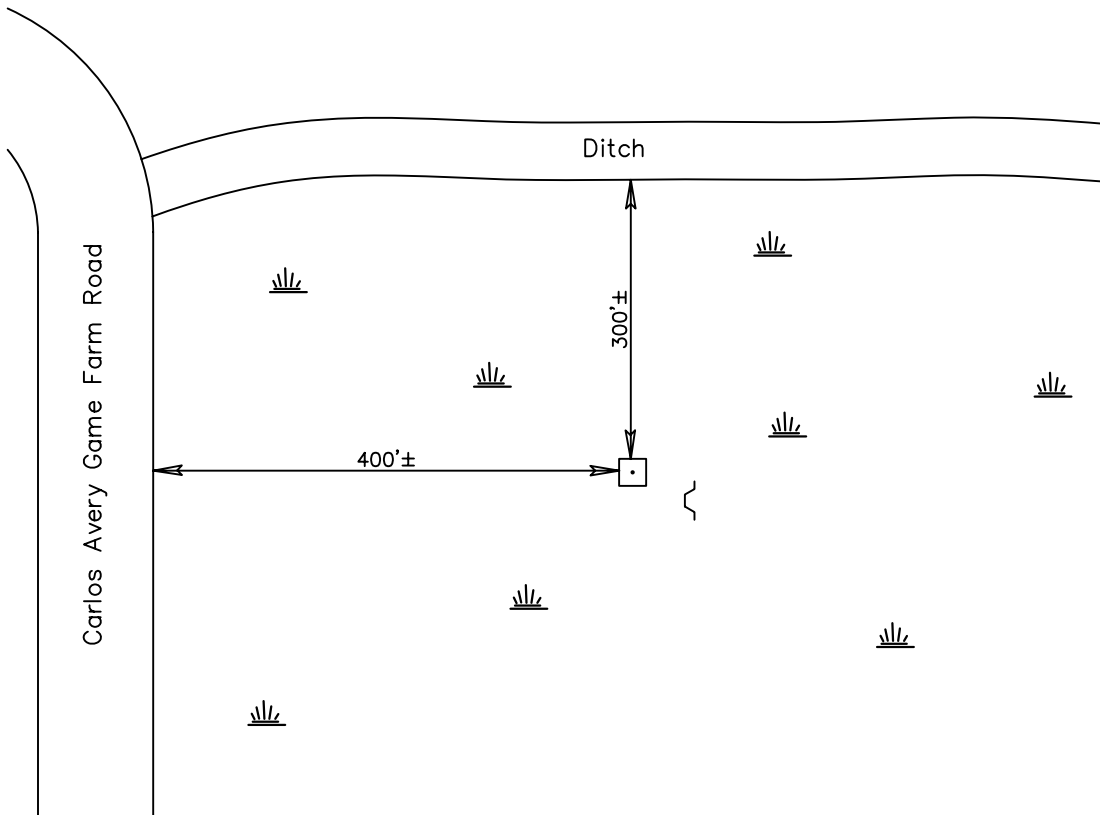
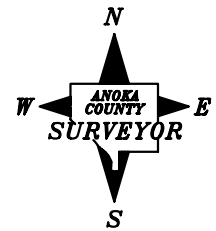

Revised date

8/05/87

N.A.D. 1983 Coordinates
(1996 Adjustment)

County Project Coordinates	
Northing	200770.5564
Easting	552941.9698
Date	3/20/06

I hereby certify that this United States public land survey monument record is correct and complete to the best of my knowledge and belief.

Date _____
_____, Anoka County Surveyor
Minnesota License Number _____