

# CERTIFICATE OF LOCATION OF GOVERNMENT CORNER

County of Anoka

State of Minnesota

## East 1/4 Corner of Sec. 31 Township 33 Range 22

On the 3rd day of May, 1965, the described corner was evidenced by a concrete monument

and to perpetuate the location of said corner, at the exact location thereof, a permanent marker was placed consisting of a red and white iron pipe

AND on the 30th day of September, 2014, said permanent marker was found to be a red and white 2" square steel Telespar monument, up 3'±, with a sign attached facing south

Updated reference ties are as shown below.

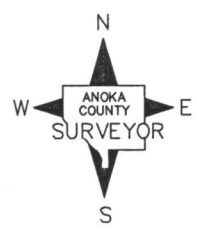
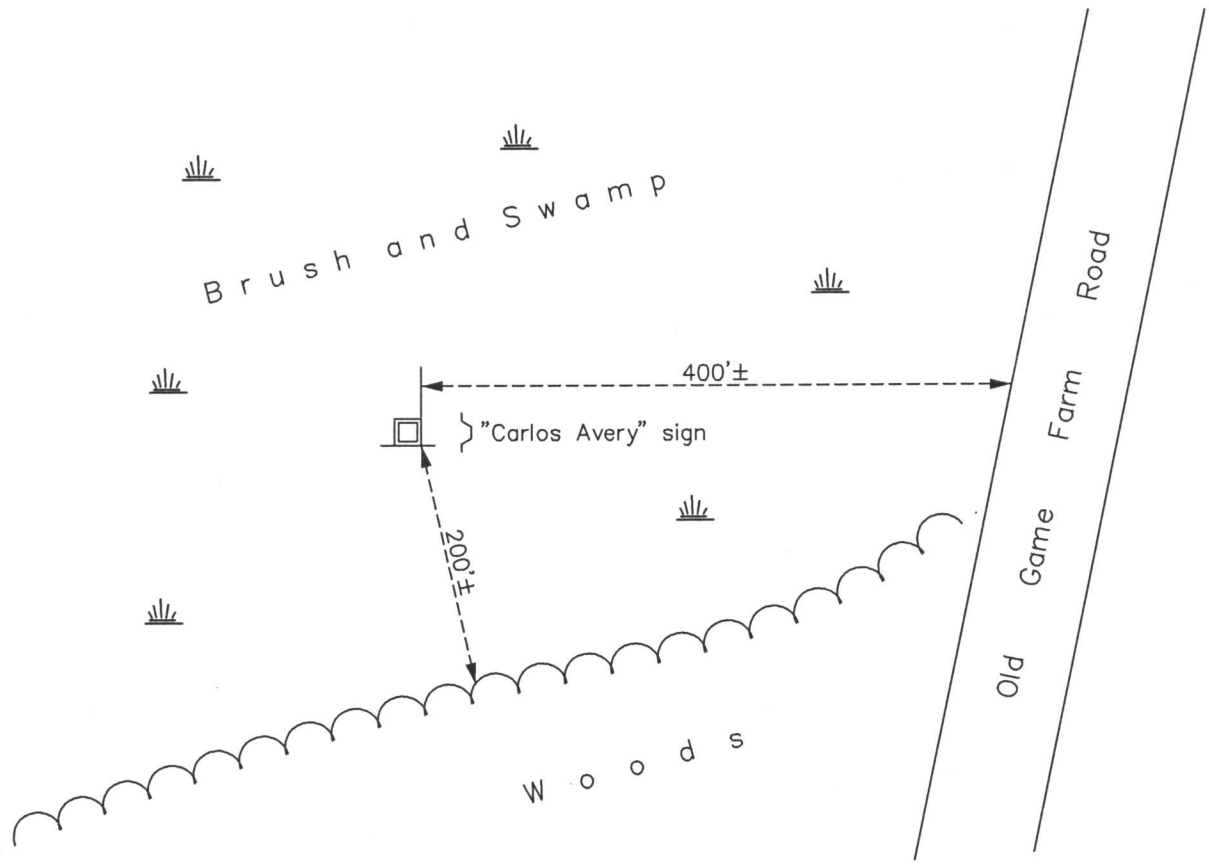

Revision Date  
9/25/15

N.A.D. 1983 Coordinates  
 (1996 Adjustment)

County Project Coordinates	
Northing	<u>198195.5714</u>
Easting	<u>537308.5041</u>
Date	<u>5/10/05</u>

I hereby certify that this United States public land survey monument record is correct and complete to the best of my knowledge and belief.

*Larry D. Hoium* Date 9/25/15  
 Larry D. Hoium, Anoka County Surveyor  
 Minnesota License Number 18165